



The Timken Company

4500 Mt Pleasant St. NW

N. Canton, OH 44720

Phone: (234) 262-3000

E-Mail: CustomerCAD@timken.com • **Web site:** www.timken.com

Bearing Unit - Adapter Sleeve UKF210 - H2310, UKF 200 Four-Bolt Flanged Mounted Bearings - Adapter Sleeve Locking

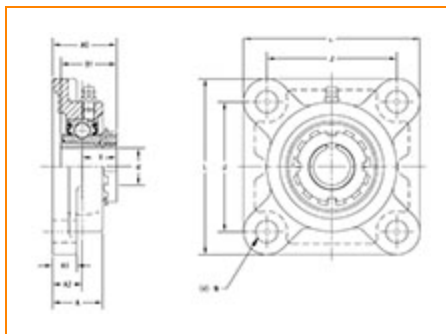

[Specifications](#) | [Dimensions](#) | [Basic Load Ratings](#)

Specifications

Bearing Unit - Adapter Sleeve	UK210 - H2310
Shaft Size d	45 mm
Adapter Sleeve Number¹	H2310
Locking Style	Adapter Sleeve Locking
Housing Construction	Four-Bolt Square Flange

Dimensions

Total Length L	143 mm 5.63 in
 Housing Width A	40 mm 1.575 in

Bolt Hole Spacing J	111 mm 4.37 in
Bolt Hole Size N	16 mm 0.63 in
Flange Thickness A1	16 mm 0.63 in
Center of Bearing from Housing End A2	22 mm 0.866 in
Center of Bearing from Bearing End Y	30 mm 1.181 in
Dimension B1	55 mm 2.165 in
Dimension A0	52 mm 2.063 in
Grease Nipple Size	A-1/4-2B UNF

Basic Load Ratings

Static Load Rating	23300 N 5238 lbf
Dynamic Load Rating	35100 N 7891 lbf

¹ Purchase the Adapter Sleeve separately

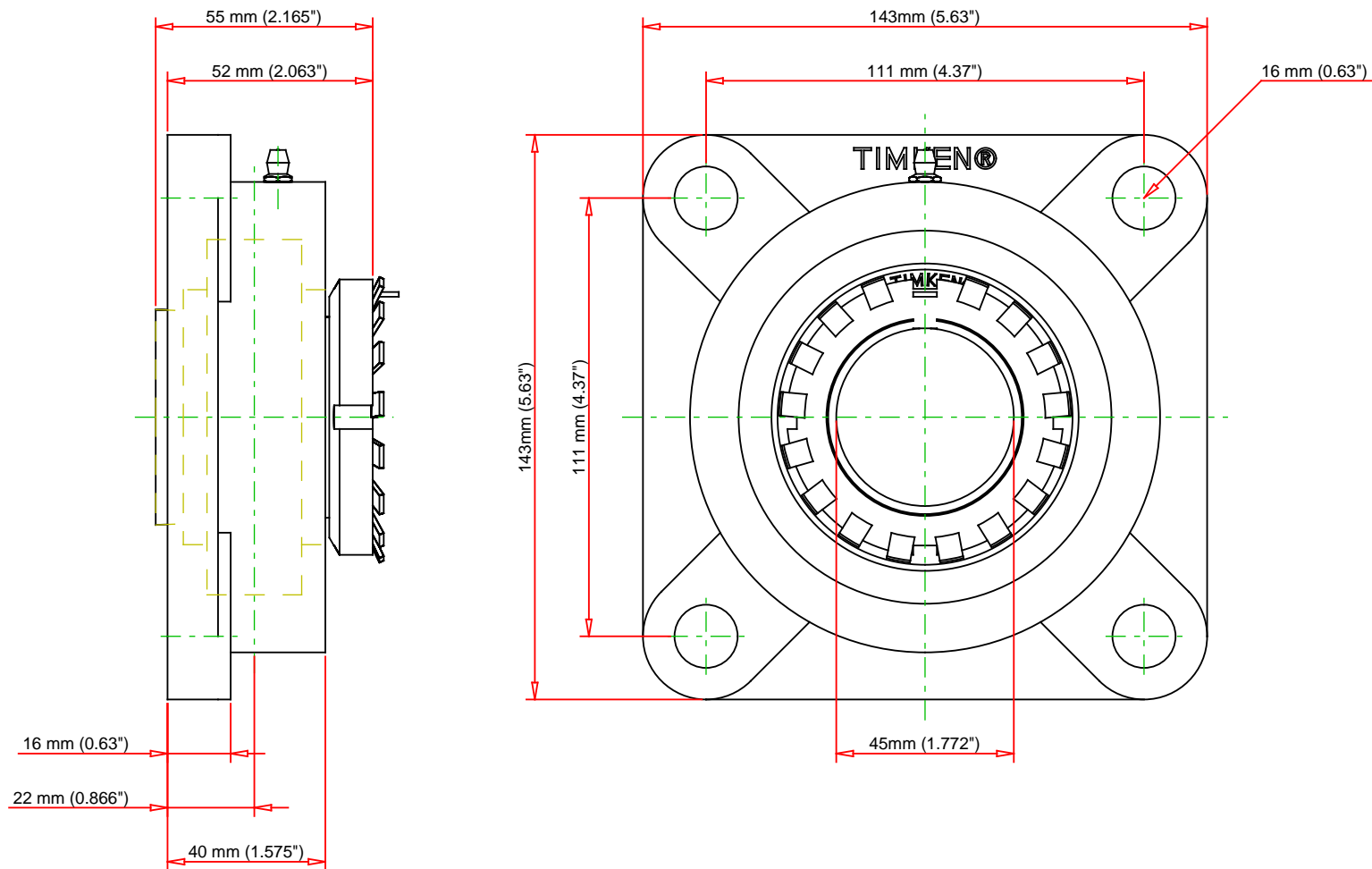

Note: Adapter sold separately

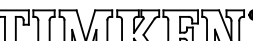
	Bearing Number		UK210 - H2310			<div>UKF210 - H2310</div> <div>UKF 200 Four-Bolt Flanged Mounted Bearings - Adapter Sleeve Locking</div>	
	Load Ratings - C _r		7891	lbf 35100			N
	Load Ratings - C _{0r}		5238	lbf 23300			N
	Weight		5.7	lb 2.6	kg		
Every reasonable effort has been made to ensure the accuracy of the information contained in this writing, but no liability is accepted for errors, omissions or for any other reason.						FOR DISCUSSION ONLY	