



**The Timken Company**

4500 Mt Pleasant St. NW

N. Canton, OH 44720

**Phone:** (234) 262-3000

**E-Mail:** [CustomerCAD@timken.com](mailto:CustomerCAD@timken.com) • **Web site:** [www.timken.com](http://www.timken.com)

## Part Number UC316, UC 300 Wide Inner Ring Ball Bearings - Set Screw Locking

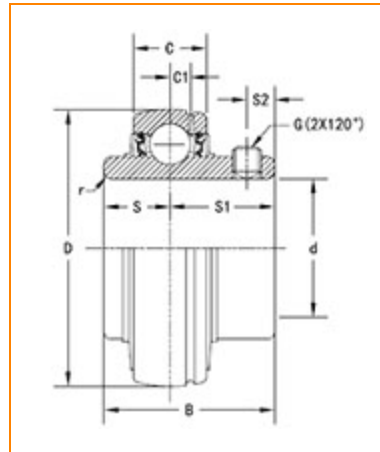

[Specifications](#) | [Dimensions](#) | [Basic Load Ratings](#)

### Specifications

|                       |                   |
|-----------------------|-------------------|
| <b>Bore Type</b>      | Cylindrical bore  |
| <b>Bearing Type</b>   | Ball Bearing      |
| <b>Shaft Size d</b>   | 80 mm             |
| <b>Material</b>       | Bearing Steel     |
| <b>Locking Device</b> | Set Screw Locking |

### Dimensions

|                             |        |
|-----------------------------|--------|
| <b>Outside Diameter D</b>   | 170 mm |
| <b>Outside Ring Width C</b> | 44 mm  |
| <b>Radius r</b>             | 2.1 mm |
| <b>Groove Position C1</b>   | 15 mm  |



|                              |         |
|------------------------------|---------|
| Center of Bearing from End S | 34 mm   |
| Dimension S1                 | 52 mm   |
| Set Screw Distance S2        | 14 mm   |
| Set Screw Size               | M14×1.5 |
| Number of Set Screws         | 2       |
| Angle between Set Screws     | 120 °   |

## Basic Load Ratings

|                     |          |
|---------------------|----------|
| Static Load Rating  | 86700 N  |
| Dynamic Load Rating | 123000 N |

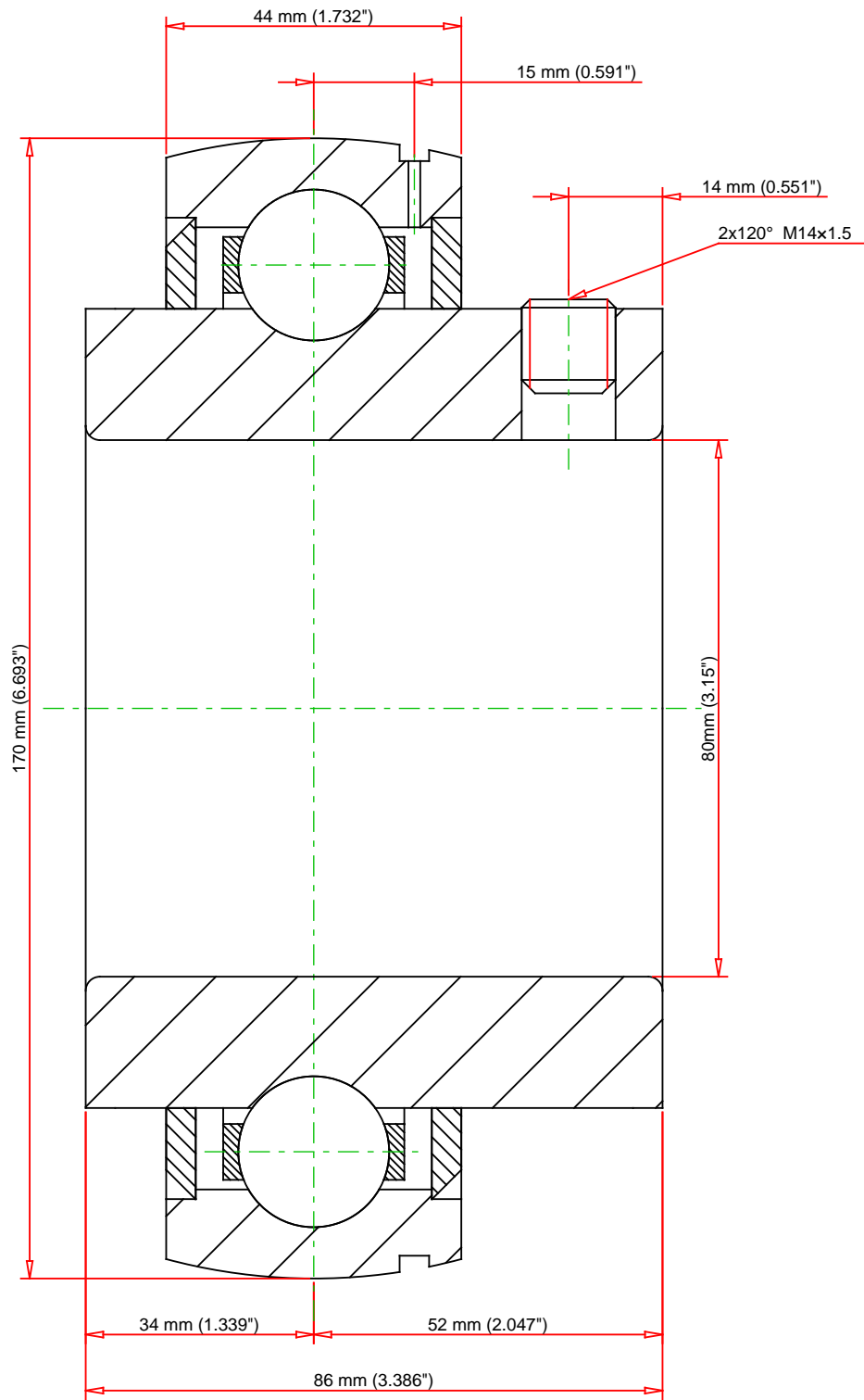

|  |        |        |  |  |  |  |
|--|--------|--------|--|--|--|--|
| Weight   | 5.6 lb | 2.5 kg |  | <div>UC316</div> <div>UC 300 Wide Inner Ring Ball Bearings - Set Screw Locking</div> |  |  |
|  |        |        |  |  |  |  |
|  |        |        | <div>THE TIMKEN COMPANY</div> <div>NORTH CANTON, OHIO USA</div>                      |  |  | <div>Basic Load Ratings - C<sub>r</sub></div> <div>27652 lbf</div> <div>123000 N</div> |
|  |        |        | <div>Load Ratings - C<sub>0r</sub></div> <div>19491 lbf</div> <div>86700 N</div>     |  |  |  |
| Every reasonable effort has been made to ensure the accuracy of the information contained in this writing, but no liability is accepted for errors, omissions or for any other reason. |        |        |  | FOR DISCUSSION ONLY  |  |  |