

FAG

29420-E1-XL

Axial spherical roller bearing

Schaeffler ID:
0390003700000

Axial spherical roller bearing 294..-E1-XL,
no flanging ring

X-life

Technical information

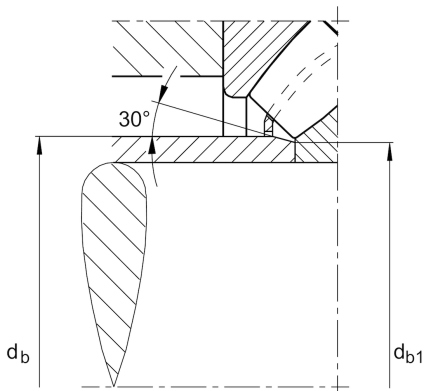
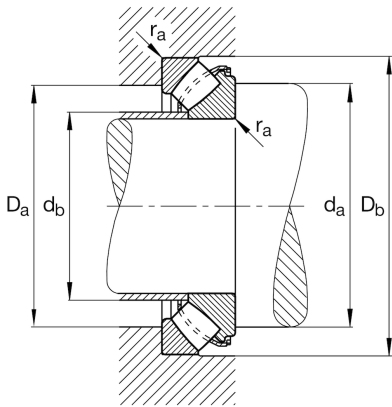
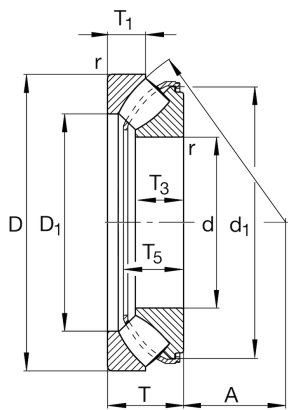

Main Dimensions & Performance Data

d	[100] mm	Bore diameter
D	[210] mm	Outside diameter
T	[67] mm	Height
C _a	[1,060,000] N	Basic dynamic load rating, axial
C _{0a}	[2,600,000] N	Basic static load rating, axial
C _{ua}	[290,000] N	Fatigue load limit, axial
n _G	[3,400] 1/min	Limiting speed
n _{gr}	[1,740] 1/min	Reference speed
	[9.87] kg	Weight

Mounting dimensions

d _{a min}	[150] mm	Minimum diameter shaft shoulder
D _{a max}	[175] mm	Maximum diameter of housing shoulder
D _{b min}	[214] mm	Minimum bore diameter housing
d _{b max}	[110.5] mm	Maximum distance sleeve
r _{a max}	[2.5] mm	Maximum recess radius

Dimensions

D ₁	[141.5] mm	Bore diameter housing washer
d ₁	[184.5] mm	Rip diameter shaft washer
r _{min}	[3] mm	Minimum chamfer dimension
T ₁	[32] mm	Height of the housing washer
T ₃	[43] mm	Height of the shaft washer
T ₅	[59.5] mm	Distance shaft washer - cage
A	[62] mm	Distance of the center point

Temperature range

T _{min}	[-30] °C	Operating temperature min.
T _{max}	[200] °C	Operating temperature max.