



The Timken Company

4500 Mt Pleasant St. NW

N. Canton, OH 44720

Phone: (234) 262-3000

E-Mail: CustomerCAD@timken.com • **Web site:** www.timken.com

Bearing Unit - Adapter Sleeve UKF209 - H2309, UKF 200 Four-Bolt Flanged Mounted Bearings - Adapter Sleeve Locking

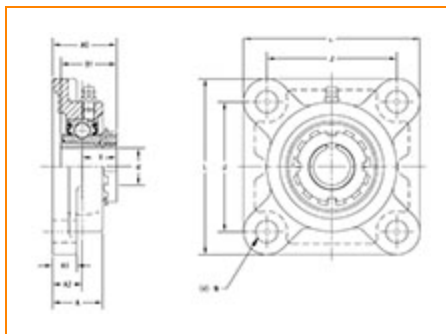

[Specifications](#) | [Dimensions](#) | [Basic Load Ratings](#)

Specifications

Bearing Unit - Adapter Sleeve	UK209 - H2309
Shaft Size d	40 mm
Adapter Sleeve Number¹	H2309
Locking Style	Adapter Sleeve Locking
Housing Construction	Four-Bolt Square Flange

Dimensions

Total Length L	137 mm 5.394 in
 Housing Width A	38 mm 1.496 in

Bolt Hole Spacing J	105 mm 4.134 in
Bolt Hole Size N	16 mm 0.63 in
Flange Thickness A1	16 mm 0.63 in
Center of Bearing from Housing End A2	22 mm 0.866 in
Center of Bearing from Bearing End Y	29 mm 1.142 in
Dimension B1	50 mm 1.969 in
Dimension A0	51 mm 2 in
Grease Nipple Size	A-1/4-2B UNF

Basic Load Ratings

Static Load Rating	21300 N 4788 lbf
Dynamic Load Rating	34100 N 7666 lbf

¹ Purchase the Adapter Sleeve separately

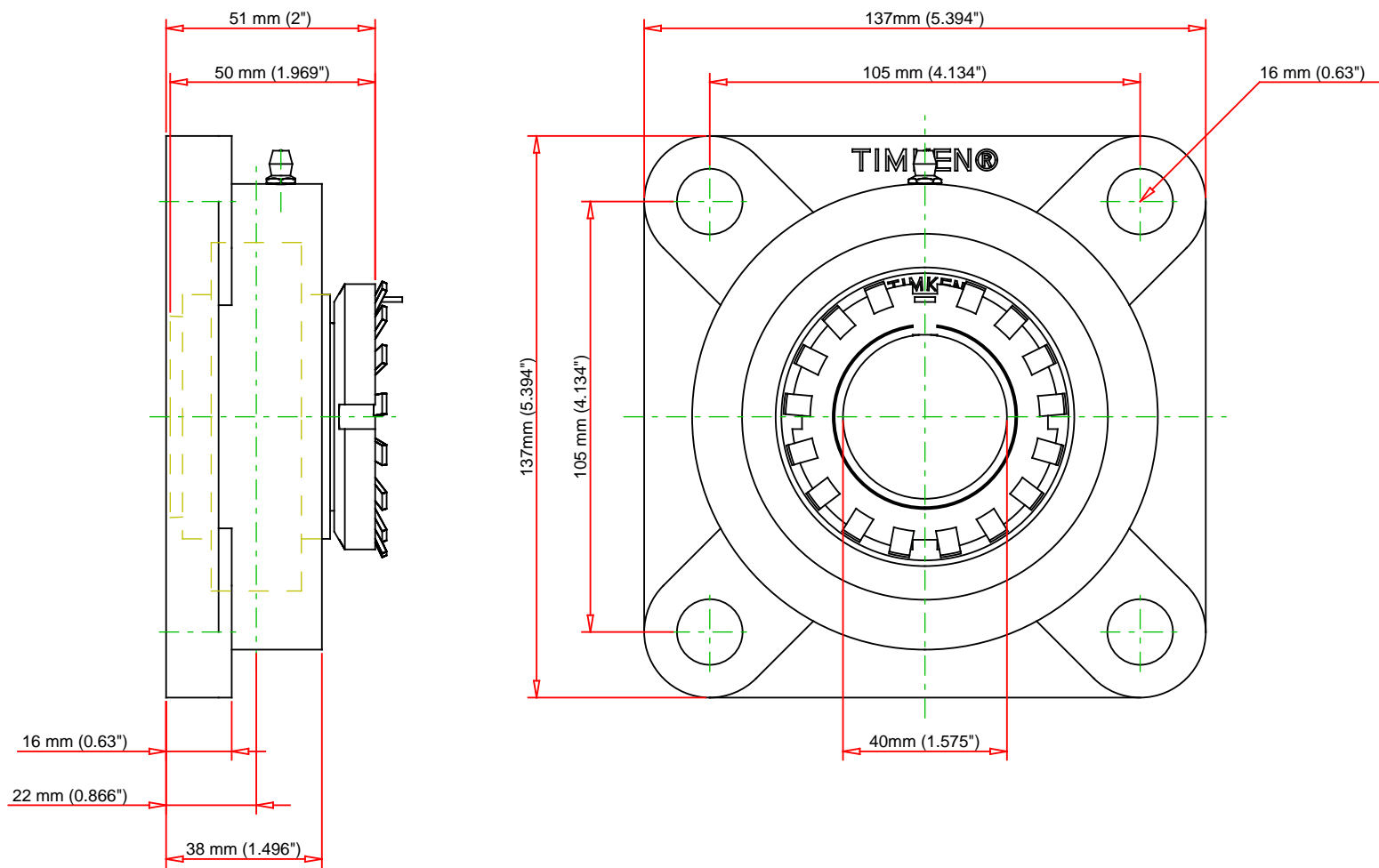

Note: Adapter sold separately

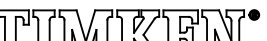
	Bearing Number	UK209 - H2309					<div>UKF209 - H2309</div> <div>UKF 200 Four-Bolt Flanged Mounted Bearings - Adapter Sleeve Locking</div>
	Load Ratings - C _r	7666	lbf	34100	N		
	Load Ratings - C _{0r}	4788	lbf	21300	N		
	Weight	5.1	lb	2.3	kg		
						THE TIMKEN COMPANY NORTH CANTON, OHIO USA	
Every reasonable effort has been made to ensure the accuracy of the information contained in this writing, but no liability is accepted for errors, omissions or for any other reason.							FOR DISCUSSION ONLY