



The Timken Company

4500 Mt Pleasant St. NW

N. Canton, OH 44720

Phone: (234) 262-3000

E-Mail: CustomerCAD@timken.com • **Web site:** www.timken.com

Part Number UC315, UC 300 Wide Inner Ring Ball Bearings - Set Screw Locking

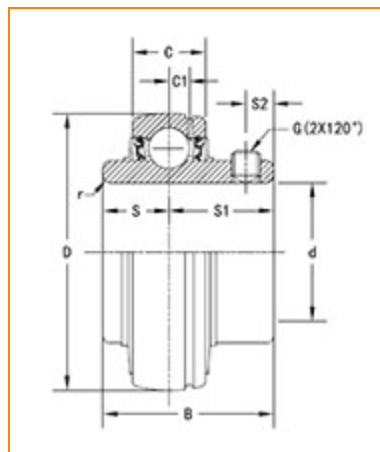

[Specifications](#) | [Dimensions](#) | [Basic Load Ratings](#)

Specifications

Bore Type	Cylindrical bore
Bearing Type	Ball Bearing
Shaft Size d	75 mm
Material	Bearing Steel
Locking Device	Set Screw Locking

Dimensions

Outside Diameter D	160.000 mm
Outside Ring Width C	42 mm
Radius r	2.1 mm
Groove Position C1	14.5 mm



Center of Bearing from End S	32 mm
Dimension S1	50 mm
Set Screw Distance S2	14 mm
Set Screw Size	M14×1.5
Number of Set Screws	2
Angle between Set Screws	120 °

Basic Load Ratings

Static Load Rating	77200 N
Dynamic Load Rating	113000 N

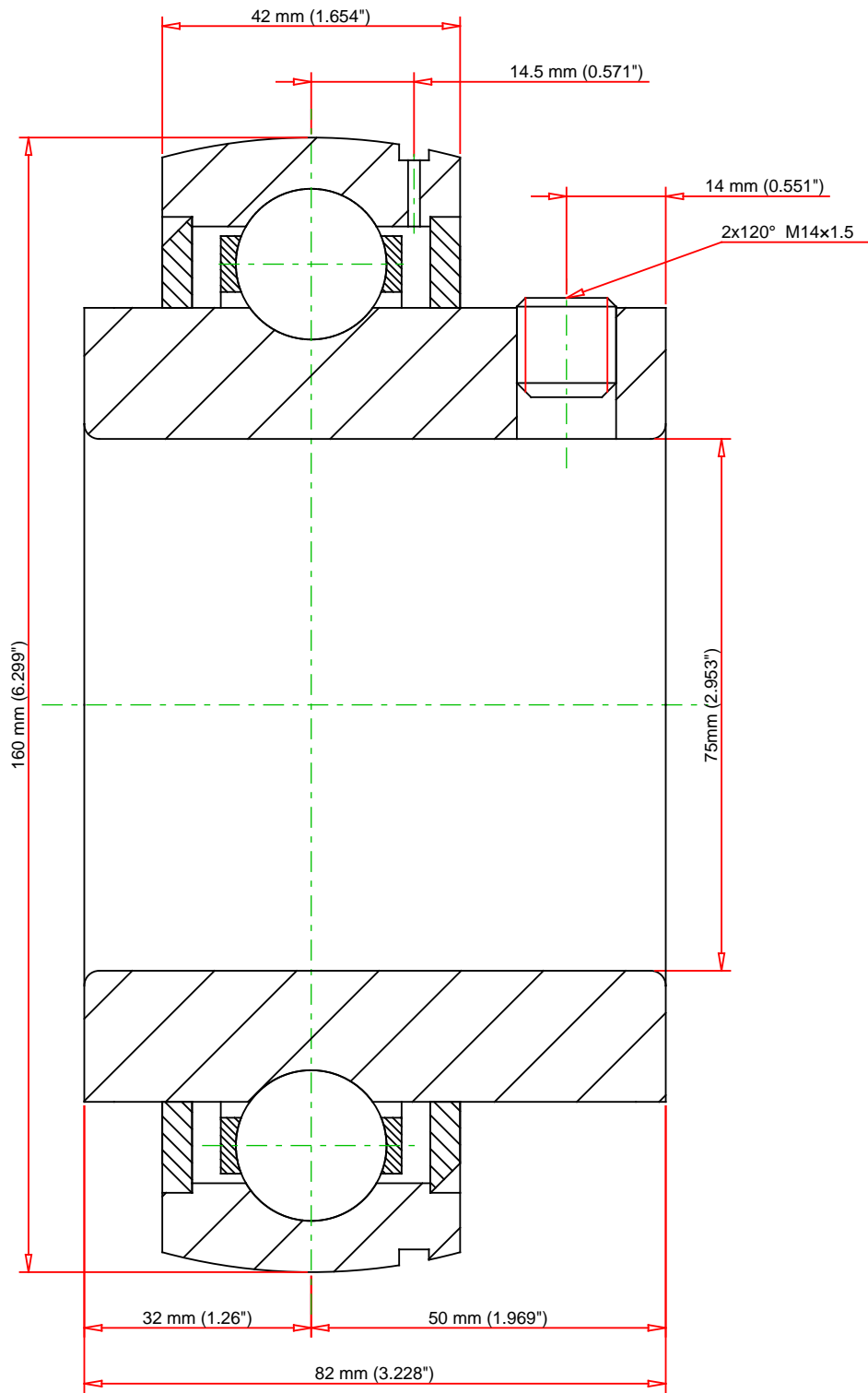

Weight	4.7 lb	2.1 kg	<div>TIMKEN®</div> <div>THE TIMKEN COMPANY</div> <div>NORTH CANTON, OHIO USA</div>			<div>UC315</div> <div>UC 300 Wide Inner Ring Ball Bearings - Set Screw Locking</div>		
						Basic Load Ratings - C _r		
			Load Ratings - C _{0r}			17355 lbf	77200 N	
Every reasonable effort has been made to ensure the accuracy of the information contained in this writing, but no liability is accepted for errors, omissions or for any other reason.						FOR DISCUSSION ONLY		