



The Timken Company

4500 Mt Pleasant St. NW

N. Canton, OH 44720

Phone: (234) 262-3000

E-Mail: CustomerCAD@timken.com • **Web site:** www.timken.com

Bearing Unit - Adapter Sleeve UKF208 - H2308, UKF 200 Four-Bolt Flanged Mounted

Bearings - Adapter Sleeve Locking

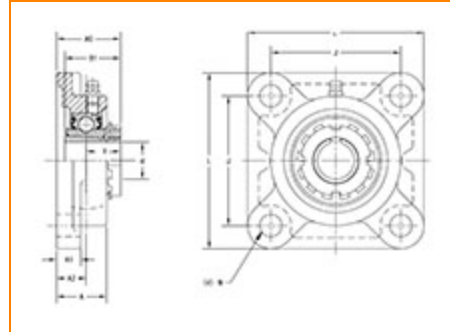

[Specifications](#) | [Dimensions](#) | [Basic Load Ratings](#)

Specifications

Bearing Unit - Adapter Sleeve	UK208 - H2308
Shaft Size d	35 mm
Adapter Sleeve Number¹	H2308
Locking Style	Adapter Sleeve Locking
Housing Construction	Four-Bolt Square Flange

Dimensions

Total Length L	130 mm 5.118 in
 Housing Width A	36 mm 1.417 in

Bolt Hole Spacing J	102 mm 4.016 in
Bolt Hole Size N	16 mm 0.63 in
Flange Thickness A1	15 mm 0.591 in
Center of Bearing from Housing End A2	21 mm 0.827 in
Center of Bearing from Bearing End Y	27 mm 1.063 in
Dimension B1	46 mm 1.8110 in
Dimension A0	48 mm 1.875 in
Grease Nipple Size	A-1/4-2B UNF

Basic Load Ratings

Static Load Rating	17800 N 4002 lbf
Dynamic Load Rating	29100 N 6542 lbf

¹ Purchase the Adapter Sleeve separately

