



The Timken Company

4500 Mt Pleasant St. NW

N. Canton, OH 44720

Phone: (234) 262-3000

E-Mail: CustomerCAD@timken.com • **Web site:** www.timken.com

Part Number AH24176, Metric AH Withdrawal Sleeve

- Sleeves used in the dismounting of tapered bore bearing from shaft.
- Safe and effective dismounting.
- Other dimensions may be available, consult your Timken sales representative.

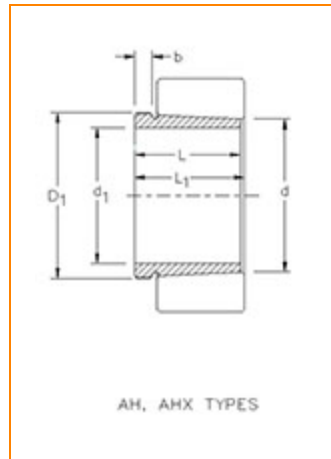

Specifications

d1	360.00 mm
L	271.00 mm
L ₁ ¹	291.00 mm
b	28 mm
Thread D ₁ ²	Tr400x5
Weight	31.3 Kg
Appropriate Withdrawal Nut No.	HM80
Appropriate Hydraulic Nut	HMV80
Taper	1:30

¹ Dimension L1 decreases as the withdrawal sleeve is driven in during mounting.

² Means metric thread and the digits are major diameter of thread and pitch.

Tr means 30°; trapezoid thread and the digits are major diameter of thread and pitch.

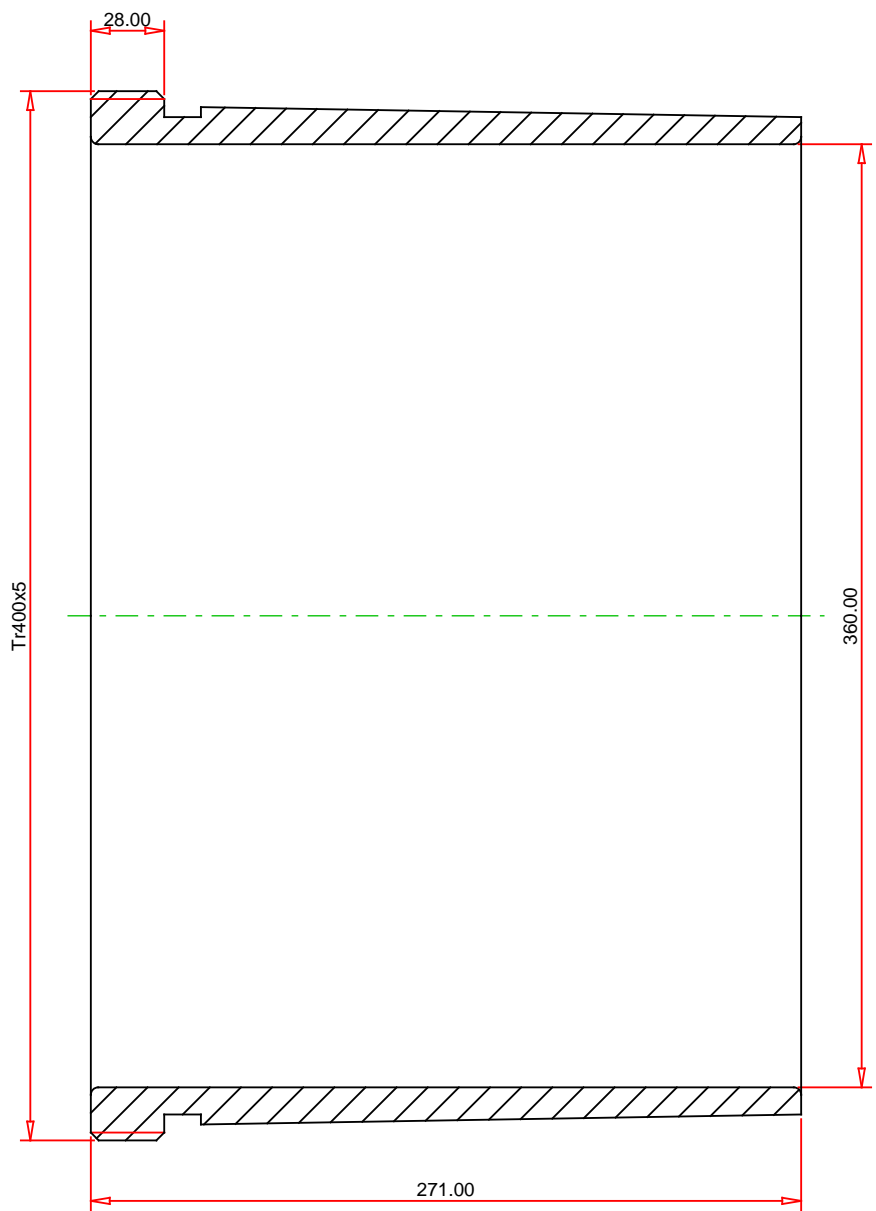

METRIC UNITS

TIMKEN®

THE TIMKEN COMPANY
NORTH CANTON, OHIO USA

AH24176
Metric AH Withdrawal Sleeve

Every reasonable effort has been made to ensure the accuracy of the information contained in this writing, but no liability is accepted for errors, omissions or for any other reason.

FOR DISCUSSION ONLY