



The Timken Company

4500 Mt Pleasant St. NW

N. Canton, OH 44720

Phone: (234) 262-3000

E-Mail: CustomerCAD@timken.com • **Web site:** www.timken.com

Bearing Unit - Adapter Sleeve UKF207 - H2307, UKF 200 Four-Bolt Flanged Mounted Bearings - Adapter Sleeve Locking

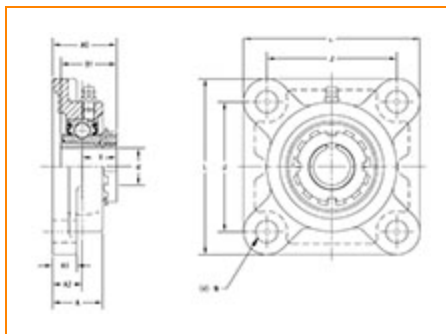

[Specifications](#) | [Dimensions](#) | [Basic Load Ratings](#)

Specifications

Bearing Unit - Adapter Sleeve	UK207 - H2307
Shaft Size d	30 mm
Adapter Sleeve Number¹	H2307
Locking Style	Adapter Sleeve Locking
Housing Construction	Four-Bolt Square Flange

Dimensions

Total Length L	117 mm 4.606 in
 Housing Width A	34 mm 1.339 in

Bolt Hole Spacing J	92 mm 3.622 in
Bolt Hole Size N	14 mm 0.551 in
Flange Thickness A1	15 mm 0.591 in
Center of Bearing from Housing End A2	19 mm 0.748 in
Center of Bearing from Bearing End Y	24 mm 0.945 in
Dimension B1	43 mm 1.693 in
Dimension A0	43 mm 1.688 in
Grease Nipple Size	A-1/4-2B UNF

Basic Load Ratings

Static Load Rating	15400 N 3462 lbf
Dynamic Load Rating	25700 N 5778 lbf

¹ Purchase the Adapter Sleeve separately

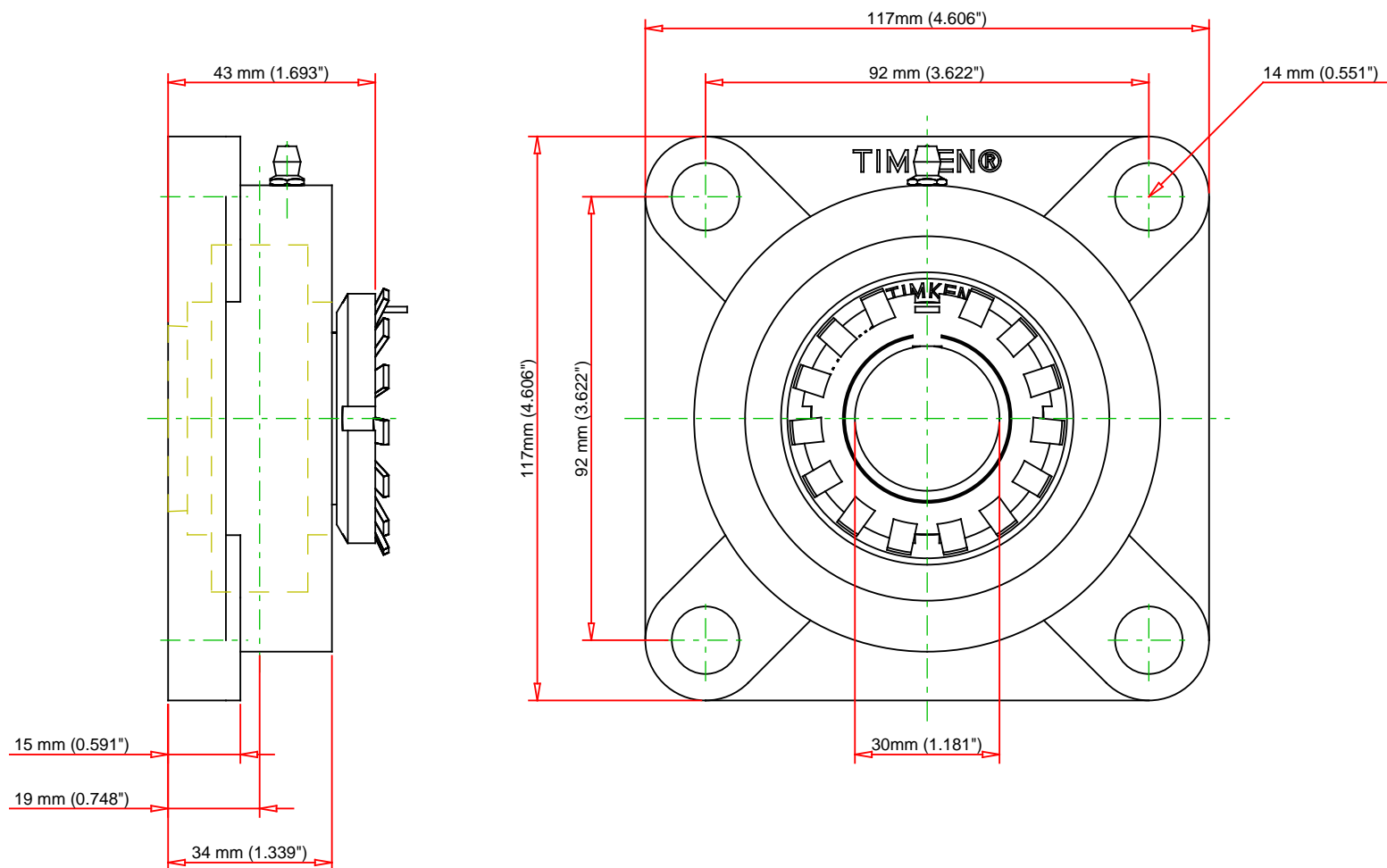

Note: Adapter sold separately

	Bearing Number	UK207 - H2307				UKF207 - H2307 UKF 200 Four-Bolt Flanged Mounted Bearings - Adapter Sleeve Locking	
	Load Ratings - C _r	5778	lbf	25700			N
	Load Ratings - C _{0r}	3462	lbf	15400			N
	Weight	3.5	lb	1.6	kg		
THE TIMKEN COMPANY NORTH CANTON, OHIO USA							
Every reasonable effort has been made to ensure the accuracy of the information contained in this writing, but no liability is accepted for errors, omissions or for any other reason.						FOR DISCUSSION ONLY	