



**The Timken Company**

4500 Mt Pleasant St. NW

N. Canton, OH 44720

**Phone:** (234) 262-3000

**E-Mail:** [CustomerCAD@timken.com](mailto:CustomerCAD@timken.com) • **Web site:** [www.timken.com](http://www.timken.com)

## Part Number UC313, UC 300 Wide Inner Ring Ball Bearings - Set Screw Locking

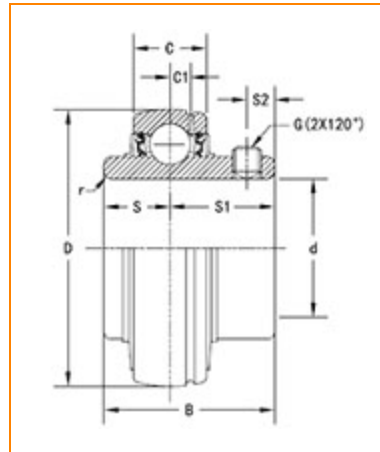

[Specifications](#) | [Dimensions](#) | [Basic Load Ratings](#)

### Specifications

<b>Bore Type</b>	Cylindrical bore
<b>Bearing Type</b>	Ball Bearing
<b>Shaft Size d</b>	65 mm
<b>Material</b>	Bearing Steel
<b>Locking Device</b>	Set Screw Locking

### Dimensions

<b>Outside Diameter D</b>	140.000 mm 5.512 in
---------------------------	------------------------



**Outside Ring Width C** 38 mm  
1.496 in

**Radius r** 2.1 mm  
0.083 in

**Groove Position C1** 12 mm  
0.472 in

**Center of Bearing from End S** 30 mm  
1.181 in

**Dimension S1** 45 mm  
1.772 in

**Set Screw Distance S2** 12 mm  
0.472 in

**Set Screw Size** M12×1.5

**Number of Set Screws** 2

**Angle between Set Screws** 120 °

## Basic Load Ratings

**Static Load Rating** 59900 N  
13466 lbf

**Dynamic Load Rating** 92700 N  
20840 lbf

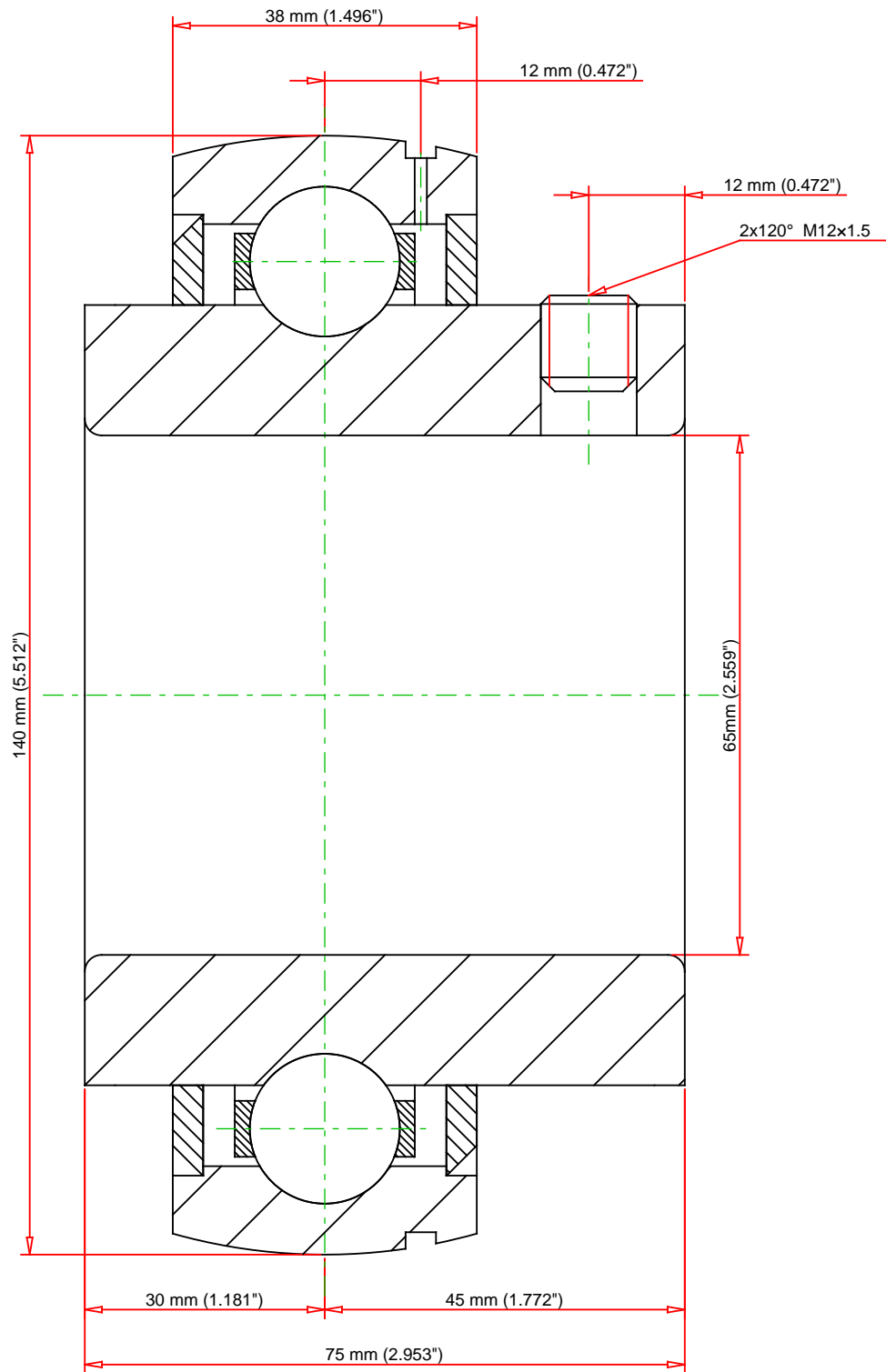

Weight	3.2 lb	1.4 kg		<b>UC313</b> UC 300 Wide Inner Ring Ball Bearings - Set Screw Locking	
					<b>THE TIMKEN COMPANY</b> NORTH CANTON, OHIO USA
			Basic Load Ratings - C <sub>r</sub>	20840 lbf	
			Load Ratings - C <sub>0r</sub>	13466 lbf	59900 N
Every reasonable effort has been made to ensure the accuracy of the information contained in this writing, but no liability is accepted for errors, omissions or for any other reason.				<b>FOR DISCUSSION ONLY</b>	