



**The Timken Company**

4500 Mt Pleasant St. NW

N. Canton, OH 44720

**Phone:** (234) 262-3000

**E-Mail:** [CustomerCAD@timken.com](mailto:CustomerCAD@timken.com) • **Web site:** [www.timken.com](http://www.timken.com)

## Bearing Unit - Adapter Sleeve UKF206 - H2306, UKF 200 Four-Bolt Flanged Mounted Bearings - Adapter Sleeve Locking

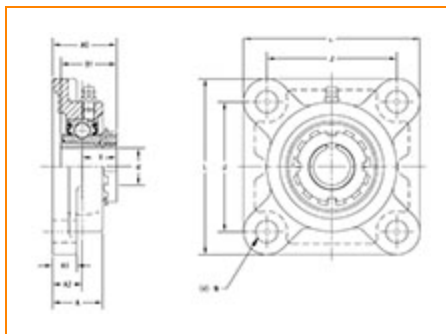

[Specifications](#) | [Dimensions](#) | [Basic Load Ratings](#)

### Specifications

<b>Bearing Unit - Adapter Sleeve</b>	UK206 - H2306
<b>Shaft Size d</b>	25 mm
<b>Adapter Sleeve Number<sup>1</sup></b>	H2306
<b>Locking Style</b>	Adapter Sleeve Locking
<b>Housing Construction</b>	Four-Bolt Square Flange

### Dimensions

<b>Total Length L</b>	108 mm 4.252 in
 <b>Housing Width A</b>	31 mm 1.22 in

<b>Bolt Hole Spacing J</b>	83 mm 3.268 in
<b>Bolt Hole Size N</b>	12 mm 0.472 in
<b>Flange Thickness A1</b>	13 mm 0.512 in
<b>Center of Bearing from Housing End A2</b>	18 mm 0.709 in
<b>Center of Bearing from Bearing End Y</b>	21.5 mm 0.846 in
<b>Dimension B1</b>	38 mm 1.496 in
<b>Dimension A0</b>	39.5 mm 1.563 in
<b>Grease Nipple Size</b>	A-1/4-2B UNF

## Basic Load Ratings

<b>Static Load Rating</b>	11300 N 2540 lbf
<b>Dynamic Load Rating</b>	19500 N 4384 lbf

<sup>1</sup> Purchase the Adapter Sleeve separately

