

# Twin Socket Convertor

Easily converts a single socket into a double switched socket. c/w 2 x M3.5 screws to fit existing wall box, conforms to BS 1363.

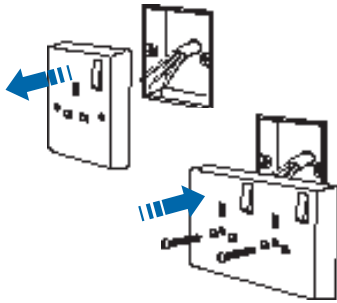

ref: **TSSC**



# Energy Saving PL Pendant

Direct retro-fit for existing ceiling rose. Meets current Part L building regulations.



ref: **ESP**

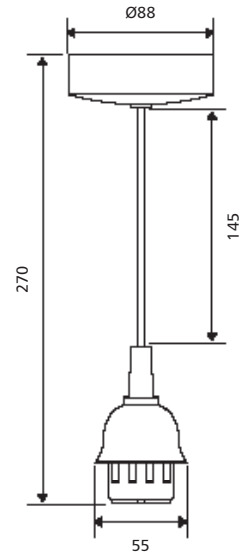

- Energy Saving PLC pendant set to meet the latest building regulations
- Intelligent built-in electronic control gear
- Accepts compact fluorescent lamps from 10W - 18W
- 4 Pin - Cap G24-q1 and q2
- Max 18 Watts
- 240 Volt
- Complete with standard 3-plate loop-in ceiling rose and flex
- Complies with latest British & European standards