



The Timken Company

4500 Mt Pleasant St. NW

N. Canton, OH 44720

Phone: (234) 262-3000

E-Mail: CustomerCAD@timken.com • **Web site:** www.timken.com

Part Number UCP306, UCP 300 Pillow Block Mounted Bearings - Set Screw Locking

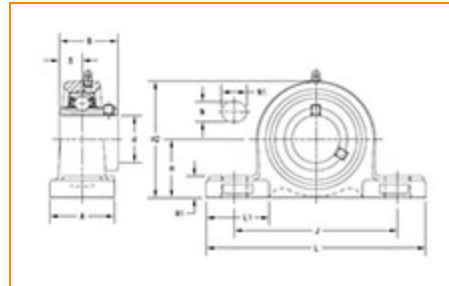

[Specifications](#) | [Dimensions](#) | [Basic Load Ratings](#)

Specifications

Bearing Number	UC306
Shaft Size d	30 mm
Locking Style	Set Screw Locking
Housing Construction	Two-Bolt Pillow Block

Dimensions

Base to Center Height H	50 mm 1.969 in
Total Length L	180 mm 7.087 in
Housing Width A	50.000 mm 1.969 in
Bolt Hole Spacing J	140 mm 5.512 in



Bolt Hole Size N	17 mm 0.669 in
Bolt Hole Length N1	20 mm 0.787 in
Foot Height H1	17 mm
Total Height H2	95 mm 3.74 in
Dimension L1	52.5 mm 2.0625 in
Inner Ring Width B	43 mm 1.693 in
Center of Bearing from End S	17 mm 0.669 in

Basic Load Ratings

Static Load Rating	15000 N 3372 lbf
Dynamic Load Rating	26700 N 6002 lbf

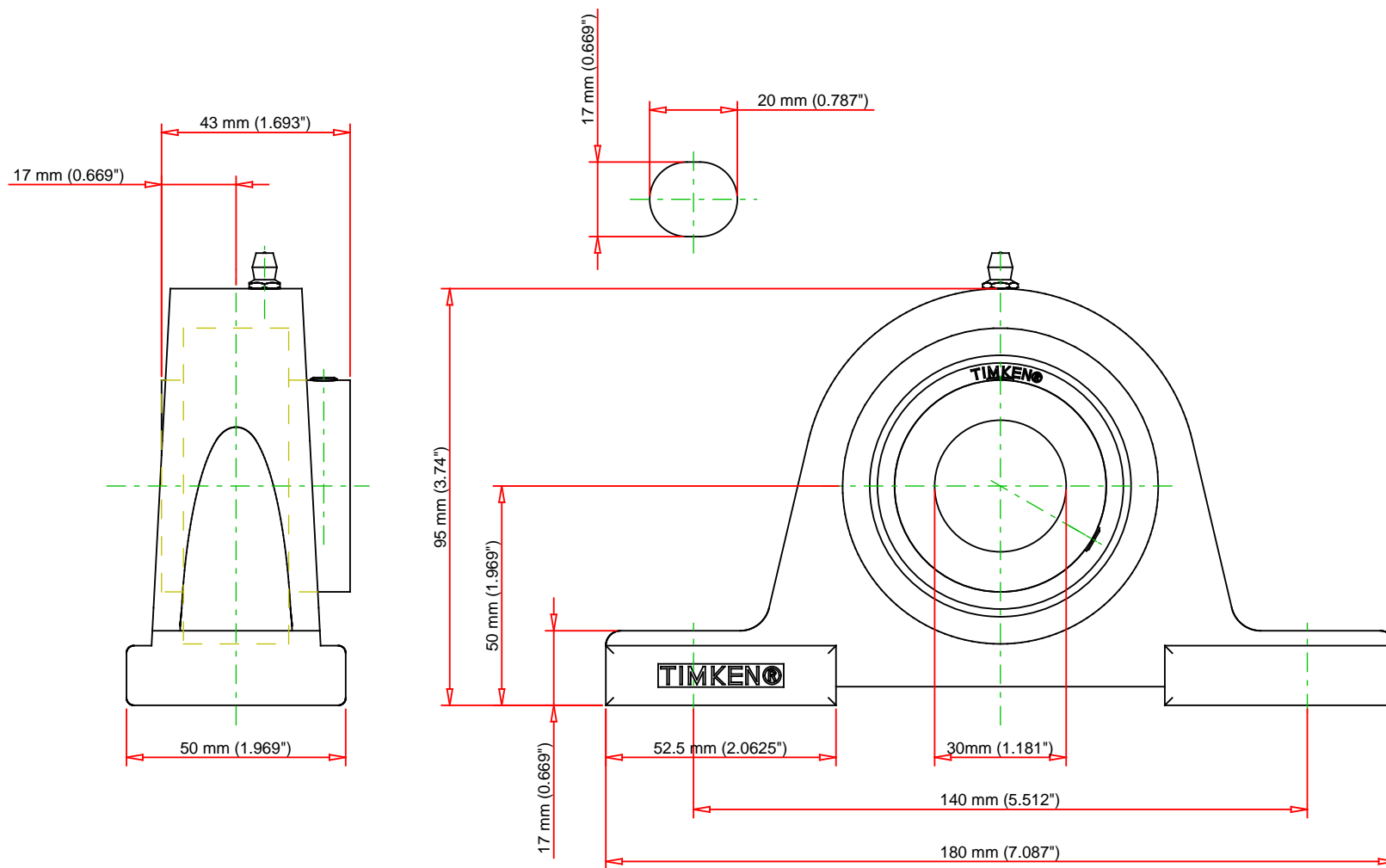

Bearing Number	UC306			
Load Ratings - C _r	6002	lbf	26700	N
Load Ratings - C _{0r}	3372	lbf	15000	N
Weight	4.9	lb	2.2	kg
Bolt Size	M14			

TIMKEN

THE TIMKEN COMPANY
NORTH CANTON, OHIO USA

UCP306

UCP 300 Pillow Block Mounted Bearings -
Set Screw Locking

Every reasonable effort has been made to ensure the accuracy of the information contained in this writing, but no liability is accepted for errors, omissions or for any other reason.

FOR DISCUSSION ONLY