



The Timken Company

4500 Mt Pleasant St. NW

N. Canton, OH 44720

Phone: (234) 262-3000

E-Mail: CustomerCAD@timken.com • **Web site:** www.timken.com

Bearing Unit - Adapter Sleeve UKF205 - H2305, UKF 200 Four-Bolt Flanged Mounted

Bearings - Adapter Sleeve Locking

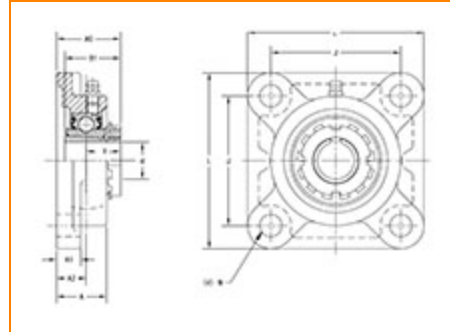

[Specifications](#) | [Dimensions](#) | [Basic Load Ratings](#)

Specifications

| | |
|--|-------------------------|
| Bearing Unit - Adapter Sleeve | UK205 - H2305 |
| Shaft Size d | 20 mm |
| Adapter Sleeve Number¹ | H2305 |
| Locking Style | Adapter Sleeve Locking |
| Housing Construction | Four-Bolt Square Flange |

Dimensions

| | |
|---|-------------------|
| Total Length L | 95 mm 3.74 in |
|  Housing Width A | 27 mm 1.063 in |

| | |
|--|--------------------|
| Bolt Hole Spacing J | 70 mm 2.756 in |
| Bolt Hole Size N | 12 mm 0.472 in |
| Flange Thickness A1 | 13 mm 0.512 in |
| Center of Bearing from Housing End A2 | 16 mm 0.63 in |
| Center of Bearing from Bearing End Y | 20 mm 0.787 in |
| Dimension B1 | 35 mm 1.3780 in |
| Dimension A0 | 36 mm 1.406 in |
| Grease Nipple Size | A-1/4-2B UNF |

Basic Load Ratings

| | |
|----------------------------|---------------------|
| Static Load Rating | 7900 N 1765 lbf |
| Dynamic Load Rating | 14000 N 3147 lbf |

¹ Purchase the Adapter Sleeve separately

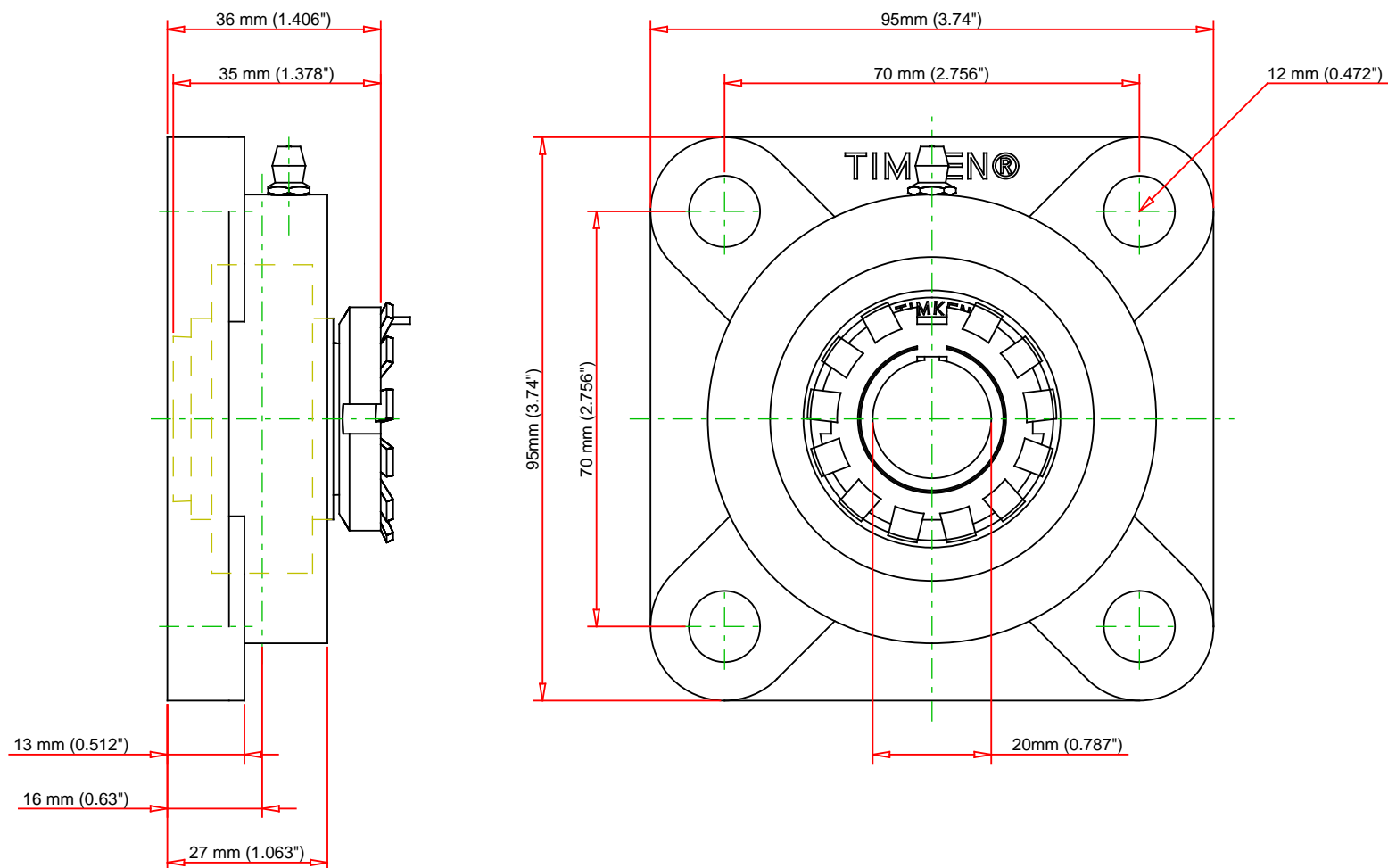

Note: Adapter sold separately

| | | | | |
|--------------------------------|---------------|-----|-------|----|
| Bearing Number | UK205 - H2305 | | | |
| Load Ratings - C _r | 3147 | lbf | 14000 | N |
| Load Ratings - C _{0r} | 1765 | lbf | 7900 | N |
| Weight | 1.9 | lb | 0.9 | kg |
| | | | | |

TIMKEN®

THE TIMKEN COMPANY
NORTH CANTON, OHIO USA

UKF205 - H2305
UKF 200 Four-Bolt Flanged Mounted
Bearings - Adapter Sleeve Locking

Every reasonable effort has been made to ensure the accuracy of the information contained in this writing, but no liability is accepted for errors, omissions or for any other reason.

FOR DISCUSSION ONLY