

FAG

29330-E1-XL

Axial spherical roller bearing

Schaeffler ID:
0389998380000

Axial spherical roller bearing 293..-E1-XL,
no flanging ring

X-life

Technical information

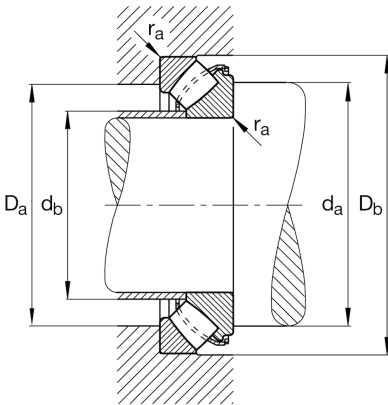
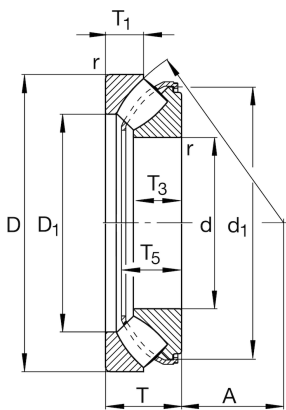

Main Dimensions & Performance Data

d	[150] mm	Bore diameter
D	[250] mm	Outside diameter
T	[60] mm	Height
C _a	[1,020,000] N	Basic dynamic load rating, axial
C _{0a}	[2,900,000] N	Basic static load rating, axial
C _{ua}	[385,000] N	Fatigue load limit, axial
n _G	[2,750] 1/min	Limiting speed
n _{gr}	[1,400] 1/min	Reference speed
	[10.22] kg	Weight

Mounting dimensions

d _{a min}	[195] mm	Minimum diameter shaft shoulder
D _{a max}	[220] mm	Maximum diameter of housing shoulder
D _{b min}	[254] mm	Minimum bore diameter housing
d _{b max}	[163] mm	Maximum distance sleeve
d _{b1 max}	[159] mm	Maximum chamfer diameter of distance sleeve
r _{a max}	[2.1] mm	Maximum recess radius
	[30] °	Angle of chamfer of the distance sleeve

Dimensions

D ₁	[190] mm	Bore diameter housing washer
d ₁	[228.4] mm	Rip diameter shaft washer
r _{min}	[2.1] mm	Minimum chamfer dimension
T ₁	[28] mm	Height of the housing washer
T ₃	[38] mm	Height of the shaft washer
T ₅	[54.5] mm	Distance shaft washer - cage
A	[87] mm	Distance of the center point

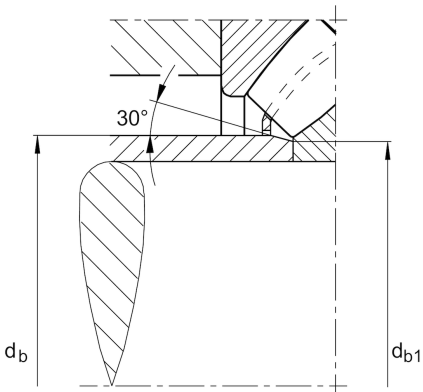

Temperature range

T _{min}	[-30] °C	Operating temperature min.
T _{max}	[200] °C	Operating temperature max.