

The Timken Company

4500 Mt Pleasant St. NW

N. Canton, OH 44720

Phone: (234) 262-3000

E-Mail: CustomerCAD@timken.com • **Web site:** www.timken.com

Part Number 3576, Tapered Roller Bearings - Single Cones - Imperial

This is the most basic and most widely used type of tapered roller bearing. It consists of two main separable parts: the cone (inner ring) assembly and the cup (outer ring). It is typically mounted in opposing pairs on a shaft.

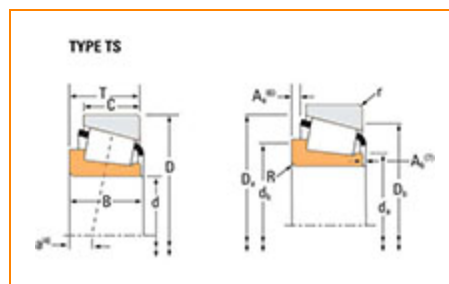

[Specifications](#) | [Dimensions](#) | [Abutment and Fillet Dimensions](#) | [Basic Load Ratings](#) | [Factors](#)

Specifications

Series	3500
Cone Part Number	3576
Design Units	Imperial
Cage Type	Stamped Steel
C1 - Dynamic Radial Rating (Two-Row, 1 million revolutions)¹	44400 lbf 197000 N
C90(2) - Dynamic Radial Rating (Two-Row, 90 million revolutions)²	11500 lbf 51200 N



Dimensions

d - Cone Bore	1 5/8 in 41.275 mm
----------------------	-----------------------

B - Cone Width	1.2160 in 30.886 mm
-----------------------	------------------------

Abutment and Fillet Dimensions

R - Cone Backface "To Clear" Radius³	0.03 in 0.8 mm
--	-------------------

da - Cone Frontface Backing Diameter	1.89 in 48 mm
---	------------------

db - Cone Backface Backing Diameter	1.93 in 49 mm
--	------------------

Ab - Cage-Cone Frontface Clearance	0.05 in 1.3 mm
---	-------------------

Aa - Cage-Cone Backface Clearance	0.07 in 1.8 mm
--	-------------------

a - Effective Center Location⁴	-0.4 in -10.2 mm
--	---------------------

Basic Load Ratings

C90 - Dynamic Radial Rating (90 million revolutions)⁵	6610 lbf 29400 N
---	---------------------

C1 - Dynamic Radial Rating (1 million revolutions)⁶	25500 lbf 113000 N
---	-----------------------

C0 - Static Radial Rating	30100 lbf 134000 N
----------------------------------	-----------------------

C_{a90} - Dynamic Thrust Rating (90 million revolutions)⁷	3460 lbf 15400 N
---	---------------------

Factors

K - Factor⁸	1.91
G1 - Heat Generation Factor (Roller-Raceway)	39.5
G2 - Heat Generation Factor (Rib-Roller End)	10.5
Cg - Geometry Factor⁹	0.0808

¹ Based on 1×10^6 revolutions L_{10} life, for the ISO life calculation method.

² Based on 90×10^6 revolutions L_{10} life, for The Timken Company life calculation method. C_{90} and C_{a90} are radial and thrust values for a single-row, $C_{90(2)}$ is the two-row radial value.

³ These maximum fillet radii will be cleared by the bearing corners.

⁴ Negative value indicates effective center inside cone backface.

⁵ Based on 90×10^6 revolutions L_{10} life, for The Timken Company life calculation method. C_{90} and C_{a90} are radial and thrust values.

⁶ Based on 1×10^6 revolutions L_{10} life, for the ISO life calculation method.

⁷ Based on 90×10^6 revolutions L_{10} life, for The Timken Company life calculation method. C_{90} and C_{a90} are radial and thrust values for a single-row, $C_{90(2)}$ is the two-row radial value.

⁸ These factors apply for both inch and metric calculations. Consult your Timken representative for instruction on use.

⁹ Geometry constant for Lubrication Life Adjustment Factor a_3 .

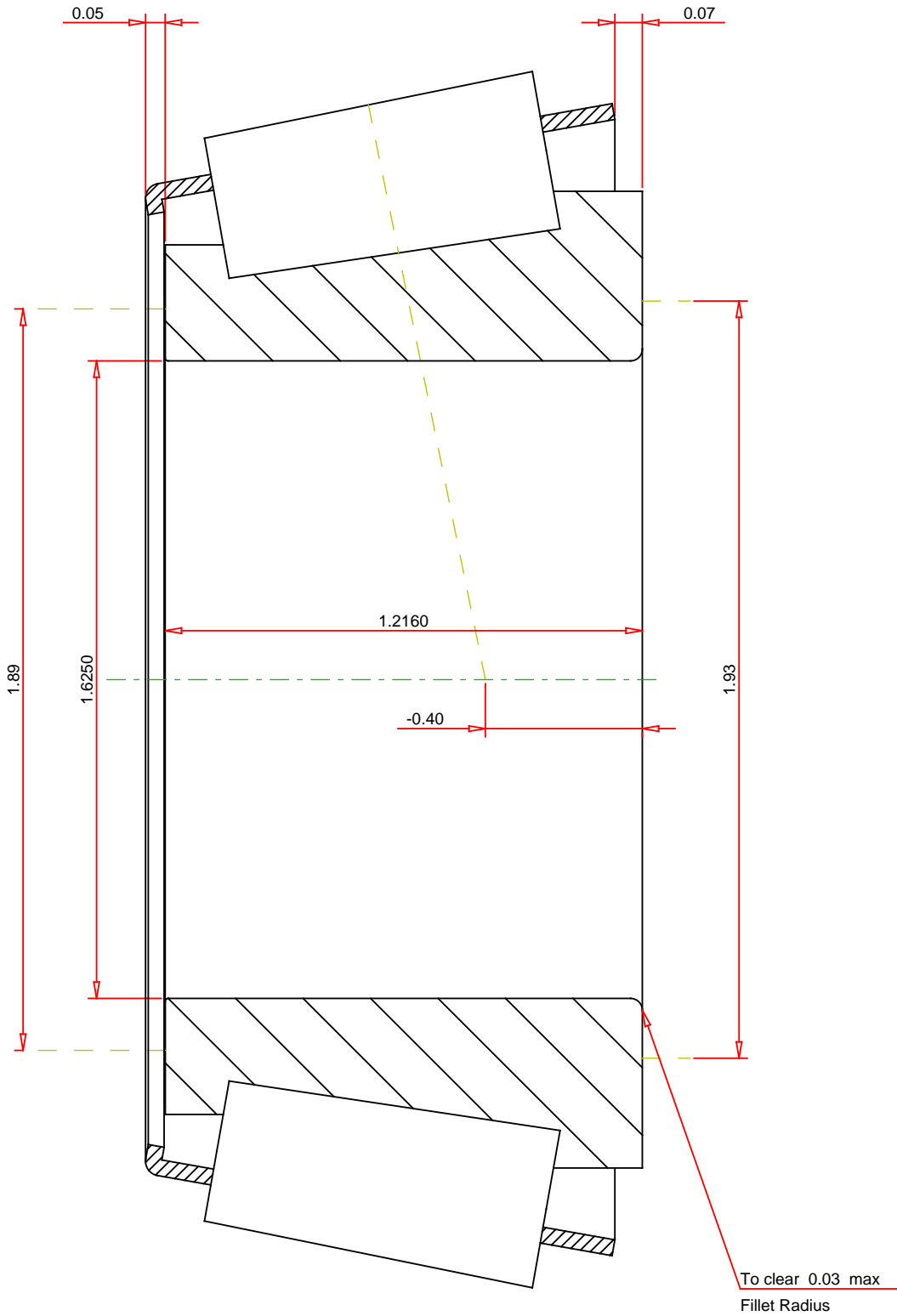

IMPERIAL UNITS

<div>Number of Rollers Per Row16</div>	<div>TIMKEN®</div> <div>THE TIMKEN COMPANY</div> <div>NORTH CANTON, OHIO USA</div>	<div>3576</div> <div>Tapered Roller Bearings - Single Cones - Imperial</div> <div><div>K Factor1.91</div><div>Dynamic Radial Rating - C906610 lbf</div><div>Dynamic Thrust Rating - Ca903460 lbf</div><div>Dynamic Radial Rating - C125500 lbf</div></div>
--	--	--