

The Timken Company

4500 Mt Pleasant St. NW

N. Canton, OH 44720

Phone: (234) 262-3000

E-Mail: CustomerCAD@timken.com • **Web site:** www.timken.com

Bearing Unit - Adapter Sleeve UK218 - H2318, UK 200 Wide Inner Ring Ball Bearings - Adapter Sleeve Locking

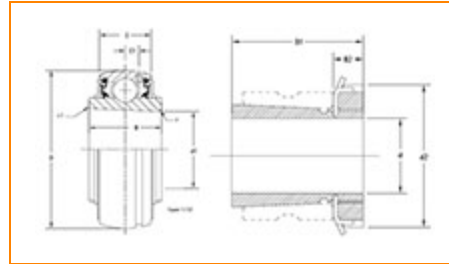
[Specifications](#) | [Dimensions](#) | [Basic Load Ratings](#)

Specifications

| | |
|--|------------------------|
| Bore Type | Tapered bore |
| Shaft Size d | 80 mm |
| Adapter Sleeve Number¹ | H2318 |
| Material | Bearing Steel |
| Locking Style | Adapter Sleeve Locking |

Dimensions

| | |
|----------------------------|-------------------------|
| Outside Diameter D | 160.000 mm 6.2990 in |
| Inside Ring Width B | 63 mm 2.480 in |



| | |
|-----------------------------|--------------------|
| Outside Ring Width C | 38 mm 1.496 in |
| Radius r | 2.2 mm 0.087 in |
| Groove Position C1 | 11 mm 0.433 in |
| Dimension B1 | 86 mm 3.386 in |

Basic Load Ratings

| | |
|----------------------------|----------------------|
| Static Load Rating | 71500 N 16074 lbf |
| Dynamic Load Rating | 96100 N 21604 lbf |

¹ Purchase the Adapter Sleeve separately

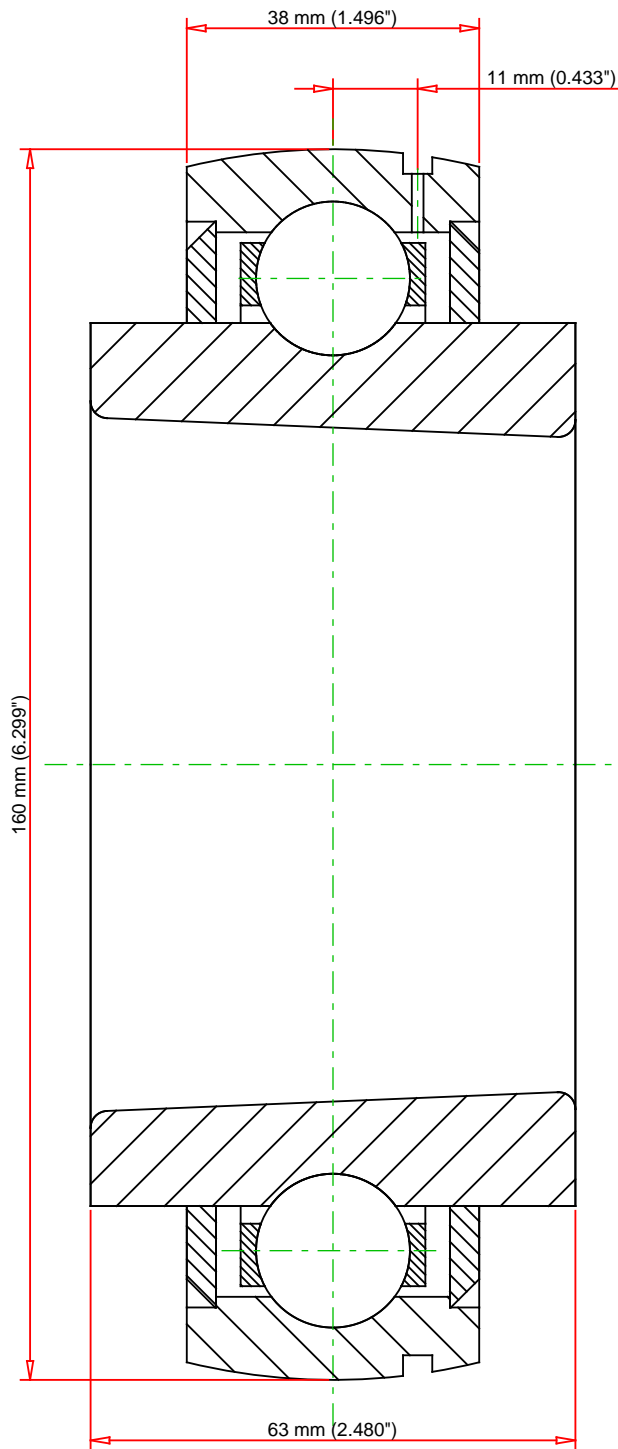

| | | | | | |
|--|--------|--------|---|-----------|---------|
| Weight | | | | | |
| | 8.3 lb | 3.8 kg | | | |
| | | | TIMKEN® | | |
| | | | THE TIMKEN COMPANY | | |
| | | | NORTH CANTON, OHIO USA | | |
| | | | UK218 - H2318 | | |
| | | | UK 200 Wide Inner Ring Ball Bearings - Adapter Sleeve Locking | | |
| | | | Basic Load Ratings - C _r | 21604 lbf | 96100 N |
| | | | Load Ratings - C _{0r} | 16074 lbf | 71500 N |
| Every reasonable effort has been made to ensure the accuracy of the information contained in this writing, but no liability is accepted for errors, omissions or for any other reason. | | | FOR DISCUSSION ONLY | | |