



**The Timken Company**

4500 Mt Pleasant St. NW

N. Canton, OH 44720

**Phone:** (234) 262-3000

**E-Mail:** [CustomerCAD@timken.com](mailto:CustomerCAD@timken.com) • **Web site:** [www.timken.com](http://www.timken.com)

## Part Number UC310, UC 300 Wide Inner Ring Ball Bearings - Set Screw Locking

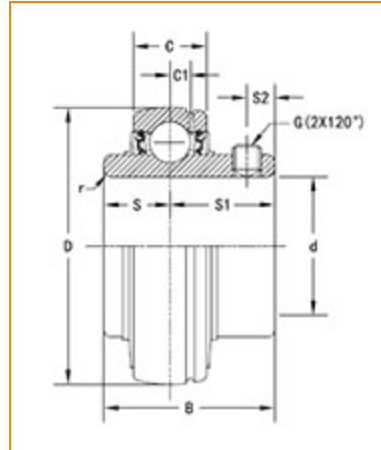

[Specifications](#) | [Dimensions](#) | [Basic Load Ratings](#)

### Specifications

<b>Bore Type</b>	Cylindrical bore
<b>Bearing Type</b>	Ball Bearing
<b>Shaft Size d</b>	50 mm
<b>Material</b>	Bearing Steel
<b>Locking Device</b>	Set Screw Locking

### Dimensions

<b>Outside Diameter D</b>	110.000 mm
<b>Outside Ring Width C</b>	32 mm
<b>Radius r</b>	2.0 mm
<b>Groove Position C1</b>	9 mm



Center of Bearing from End S	22 mm
Dimension S1	39 mm
Set Screw Distance S2	12 mm
Set Screw Size	M12×1.5
Number of Set Screws	2
Angle between Set Screws	120 °

## Basic Load Ratings

Static Load Rating	38300 N
Dynamic Load Rating	62000 N

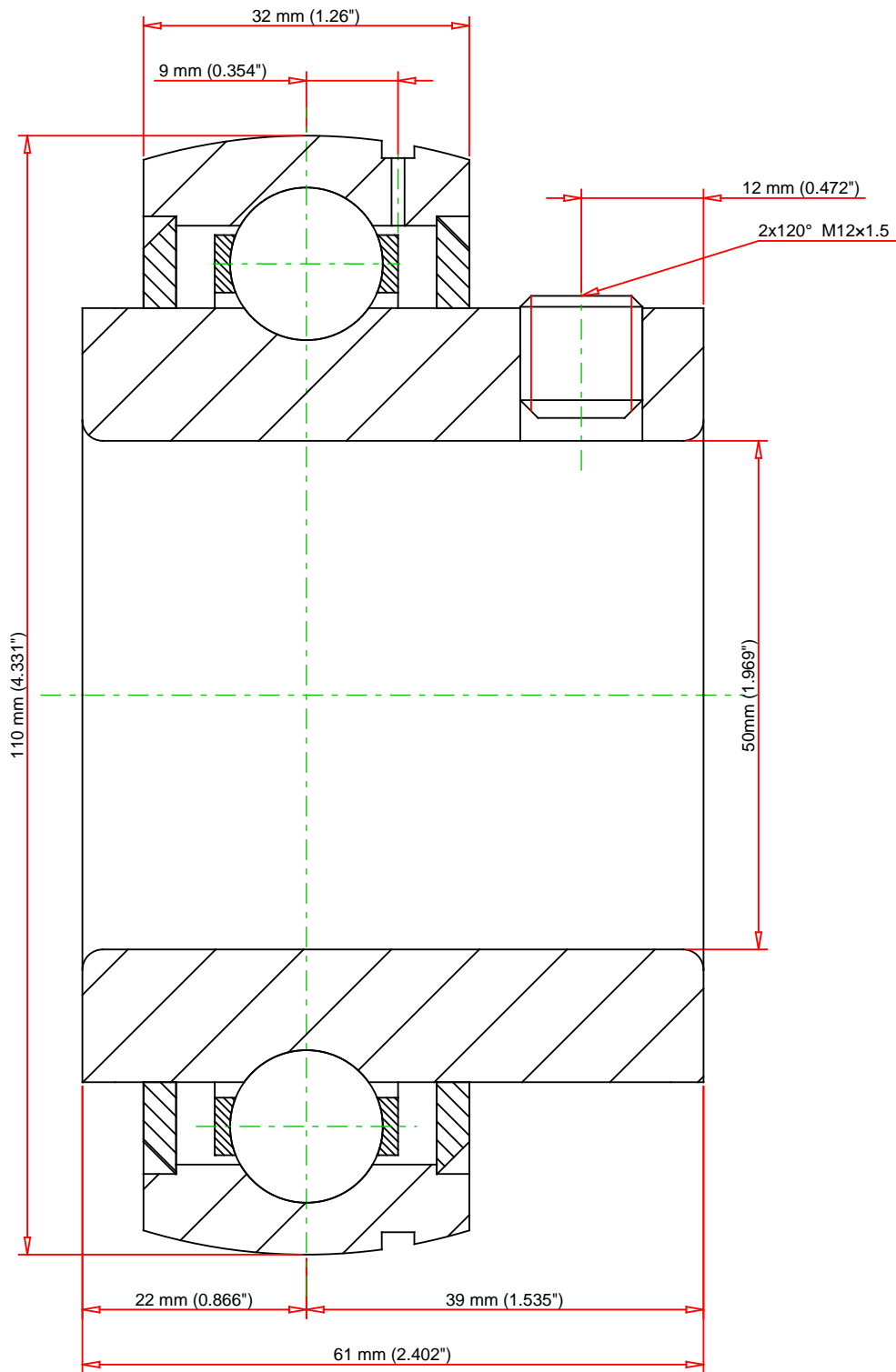

Weight	1.7 lb	0.8 kg
--------	--------	--------

**TIMKEN®**

**THE TIMKEN COMPANY**  
NORTH CANTON, OHIO USA

**UC310**

UC 300 Wide Inner Ring Ball Bearings - Set Screw Locking

Basic Load Ratings - C <sub>r</sub>	13938 lbf	62000 N
Load Ratings - C <sub>0r</sub>	8610 lbf	38300 N

Every reasonable effort has been made to ensure the accuracy of the information contained in this writing, but no liability is accepted for errors, omissions or for any other reason.

**FOR DISCUSSION ONLY**