



**The Timken Company**

4500 Mt Pleasant St. NW

N. Canton, OH 44720

**Phone:** (234) 262-3000

**E-Mail:** [CustomerCAD@timken.com](mailto:CustomerCAD@timken.com) • **Web site:** [www.timken.com](http://www.timken.com)

## Part Number LSM90BRHS, Split Cylindrical Roller Bearing Light Series Standard Plummer Block

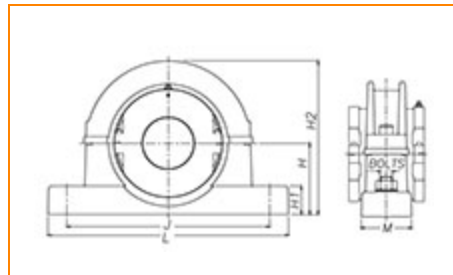

[Specifications](#) | [Dimensions](#) | [Bearings Ratings](#) | [Note](#)

### Specifications

Shaft Size	90 mm
Seal Type	Felt Type
Bearing Type	Split Cylindrical Retained Type
Support Type	Two-Bolt Plummer Block
Series Type	Light Series
Pillow/Plummer Block Style	Split Cylindrical Housed Unit - Standard
Bolt Size	2 x M24
Bearing Number	LSM90BR
Housing	LSM90HR
Bearing - Housing - Seal	LSM90BRH
Bearing UPC	013992030948



## Dimensions

**Dimension H** 4.409 in  
112 mm

**Dimension H1** 1.7 in  
44 mm

**Dimension H2** 9.9 in  
252 mm

**Dimension J** 12.6 in  
320 mm

**Dimension L** 15 in  
380 mm

**Dimension M** 3-1/2 in  
90 mm

**Housing Width** 5.3 in  
134 mm

## Bearings Ratings

**Cr - Dynamic Load Rating** 42039 lbf  
187000 N

**Cor - Static Load Rating** 51931 lbf  
231000 N

**Ca - Axial Load Rating** 2787.59 lbf  
12400 N

**Maximum Speed** 2790 rpm

## Note

Timken offers a wide range of sealing options including: KPS, RSS,

**Note**

ATL and HTTPS seals.

[Please review for more options.](#)

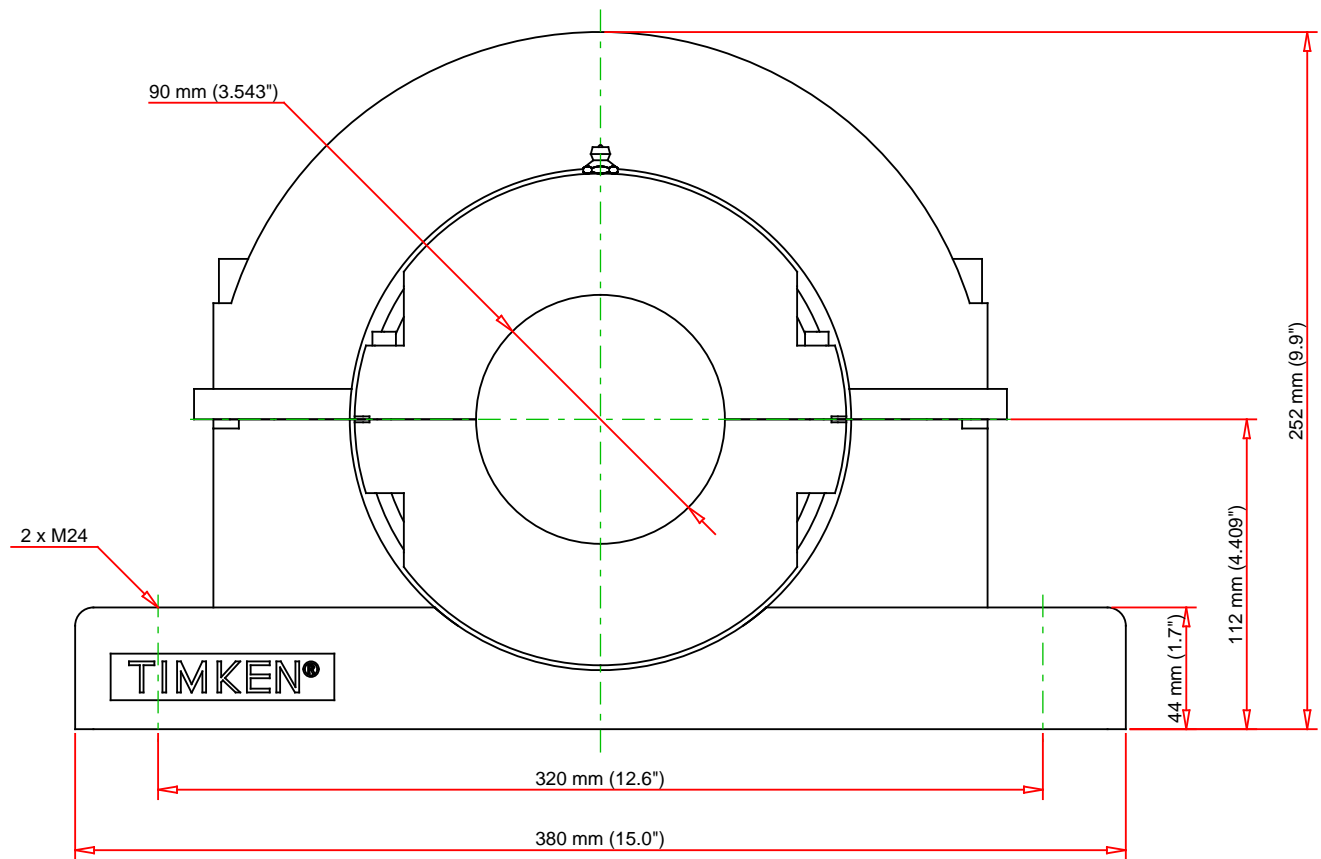

Bearing: LSM90BR	Cr - Dynamic Load Rating	42039	lbf	187000	N		<b>LSM90BRHS</b> Split Cylindrical Roller Bearing Light Series Standard Plummer Block
Housing: LSM90HR	Cor - Static Load Rating	51931	lbf	231000	N		
Support: S05	Ca - Axial Load Rating	2787.59	lbf	12400	N		
Seal: Felt Type	Shipping Weights	64	lb	29	Kg		
	Maximum Speed	2790	rpm			THE TIMKEN COMPANY NORTH CANTON, OHIO USA	
Every reasonable effort has been made to ensure the accuracy of the information contained in this writing, but no liability is accepted for errors, omissions or for any other reason.							<b>FOR DISCUSSION ONLY</b>