



# Vacuum Pad

## 2.5-Stage Bellows Type

# ZP3P-JT Series

### How to Order

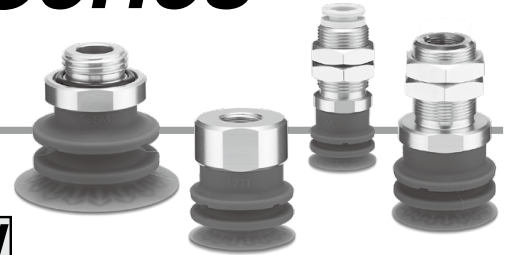

#### Pad unit

**ZP3P** – **20** **JT** **2** **SF** – **W**

#### With adapter

**ZP3P** **1** – **T** **20** **JT** **2** **SF** – **W** – **AG01** – **5**

● Bellows type  
● 2.5-stage  
● Silicone rubber

#### 1 Adapter material

<b>Nil</b>	Aluminum
<b>S</b>	Stainless steel (Stainless steel 304)

#### 2 Pad diameter

<b>20</b>	ø20
<b>25</b>	ø25
<b>32</b>	ø32
<b>40</b>	ø40
<b>50</b>	ø50

#### 3 Attachment

<b>W</b>	With attachment
<b>WM</b>	With mesh attachment
<b>WF</b>	With flat attachment

### With adapter

#### 4 Connection thread/5 Vacuum inlet

4 Connection thread				5 Vacuum inlet			Pad diameter [mm]	
Type	Thread	Symbol	Size	Thread	Symbol	Size	ø20, ø25	ø32, ø40, ø50
Direct mounting	Male thread	<b>AG01</b>	G1/8	—	<b>Nil</b>	—*1	●	●
		<b>AG02</b>	G1/4				●	●
		<b>AG03</b>	G3/8				●	●
		<b>AG04</b>	G1/2				—	●
	Female thread	<b>BG01</b>	G1/8	—	<b>Nil</b>	—*1	●	—
		<b>BG02</b>	G1/4				—	●
Plate mounting	Male thread	<b>A16</b>	M16 x 1	Female thread	<b>B01</b>	Rc1/8	●	—
				One-touch fitting*2	<b>08</b>	ø8		
				Female thread	<b>BN01</b>	NPT1/8		
		<b>A20</b>	M20 x 1	Female thread	<b>B02</b>	Rc1/4	—	●
				One-touch fitting*2	<b>10</b>	ø10		
				Female thread	<b>BN02</b>	NPT1/4		

\*1 Use the connection thread.

\*2 Built-in One-touch fitting type

Pad, adapter assembly, and mounting nuts are included but do not come assembled.

## Specifications

Operating temperature range		–30 to 90°C*1
<b>Pad</b>	<b>Material</b>	Silicone rubber*2, *3
	<b>Color</b>	Blue
	<b>Hardness (Shore A: ±5°)</b>	40
<b>Attachment</b>	<b>Material</b>	Synthetic resin*2, *4/Stainless steel*5
	<b>Color</b>	White
	<b>Mesh</b>	Mesh: 60/Opening: 280 μm

\*1 –5 to 60 [°C] for the vacuum inlet with One-touch fitting

\*2 Compliant with FDA (U.S. Food and Drug Administration) regulation 21CFR§177

\*3 Compliant with the standards for “Rubber apparatus (excluding baby drinking apparatus) and containers/packaging” (D3) (Partial revision: Japanese Ministry of Health, Labour, and Welfare Notification No. 595, 2012) in Section 3 “Apparatus and Containers/Packaging” of the Japan Food Sanitation Act, Article 18 “Specifications and Standards for Food and Food Additives, etc.” (Japanese Ministry of Health and Welfare Notification No. 370, 1959)

\*4 Compliant with the standards for “Synthetic resin apparatus and containers/packaging” (D2) in Section 3 “Apparatus and Containers/Packaging” of the Japan Food Sanitation Act, Article 18 “Specifications and Standards for Food and Food Additives, etc.” (Japanese Ministry of Health and Welfare Notification No. 370, 1959)

\*5 Stainless steel included only for mesh attachment

## Dimensions/Models

### With adapter Direct mounting type (Female thread)

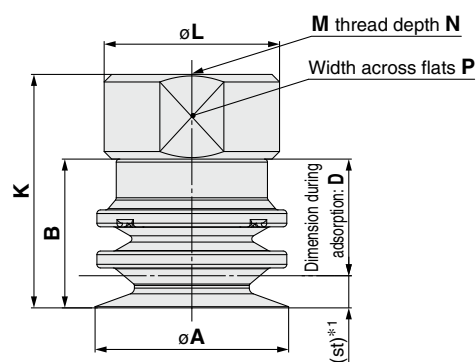

\*1 Same dimension as the pad unit

**ZP3P**   - T 20 JT2SF - W - BG01

#### 1 Adapter material

Nil	Aluminum
S	Stainless steel (Stainless steel 304)

#### 4 Connection thread (Female thread)

BG01	G1/8
BG02	G1/4

Model								K	L	M	N	P	Weight [g]		Min. opening hole size of the adapter					
① Adapter material	Vacuum inlet direction	② Pad dia.	Form	Number of bellows stages	Material	③ Attachment	④ Conenction thread						Aluminum	Stainless steel						
ZP3P	Nil S	T	20	JT	2	SF	W WM WF	BG01	28.7	18	G1/8	7.4	17	9.2	22.1	ø5				
			25					29.8	10					22.9						
			32					38.6	BG02					29	G1/4	11	27	31.1	77	ø8
			40					40.9										33.7	79.7	
			50					42.7										36.7	82.6	

### With adapter Plate mounting type (Male/Female thread)

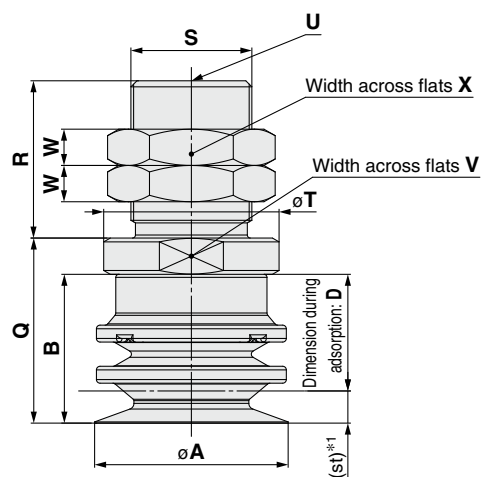

\*1 Same dimension as the pad unit

**ZP3P**   - T 20 JT2SF - W - A16 - B01

#### 1 Adapter material

Nil	Aluminum
S	Stainless steel (Stainless steel 304)

#### Connection thread (Male thread)

A16	M16 x 1
A20	M20 x 1

#### 5 Vacuum inlet (Female thread)

B01	Rc1/8
BN01	NPT1/8
B02	Rc1/4
BN02	NPT1/4

Model										Q	R	S	T	U	V	W	X	Weight [g]		Min. opening hole size of the adapter
① Adapter material	Vacuum inlet direction	② Pad dia.	Form	Number of bellows stages	Material	③ Attachment	④ Connection thread	⑤ Vacuum inlet	Aluminum									Stainless steel		
ZP3P	Nil S	T	20	JT	2	SF	W WM WF	A16	B01	21.7	22	M16 x 1	18	Rc1/8	17	5	19	24	49.7	ø5
			BN01							23.8				46						
			B01						22.8	24.7				50.5						
			BN01							24.6				46.8						
			32					A20	B02	30.6	26	M20 x 1	29	Rc1/4	27	6	24	54.3	108	ø8
			BN02							54.1				107						
			B02						32.9	56.7				110.7						
			BN02							56.5				109.7						
			B02						34.7	59.8				113						
			BN02							59.7				113						
40																				
50																				