



The Timken Company

4500 Mt Pleasant St. NW

N. Canton, OH 44720

Phone: (234) 262-3000

E-Mail: CustomerCAD@timken.com • **Web site:** www.timken.com

Part Number 93127CD, Tapered Roller Bearings - Double Tapered Cup - Imperial

The configuration of the TDO provides a wide effective bearing spread, making it ideal for applications in which overturning moments are a significant load component. TDO bearings can be used in fixed positions or allowed to float in the housing bore.



[Specifications](#) | [Dimensions](#) | [Abutment and Fillet Dimensions](#) | [Factors](#)

Specifications

Series	93000
Design Units	Imperial
Y - ISO Factor¹	1.15

Dimensions

D - Cup Outer Diameter	12.5000 in 317.500 mm
C - Double Cup Width	4.375 in 111.125 mm

Abutment and Fillet Dimensions

r - Cup Frontface "To Clear" Radius²	0.06 in 1.5 mm
Da - Cup Frontface Backing Diameter	11.81 in 299.97 mm

Factors

K - Factor³	1.12
e - ISO Factor⁴	0.52
Y1 - ISO Factor⁵	1.29
Y2 - ISO Factor⁶	1.92
Cg - Geometry Factor⁷	0.146

¹ These factors apply for both inch and metric calculations. Consult your Timken representative for instruction on use.

² These maximum fillet radii will be cleared by the bearing corners.

³ These factors apply for both inch and metric calculations. Consult your Timken representative for instruction on use.

⁴ These factors apply for both inch and metric calculations. Consult your Timken representative for instruction on use.

⁵ These factors apply for both inch and metric calculations. Consult your Timken representative for instruction on use.

⁶ These factors apply for both inch and metric calculations. Consult your Timken representative for instruction on use.

⁷ Geometry constant for Lubrication Life Adjustment Factor a3l.

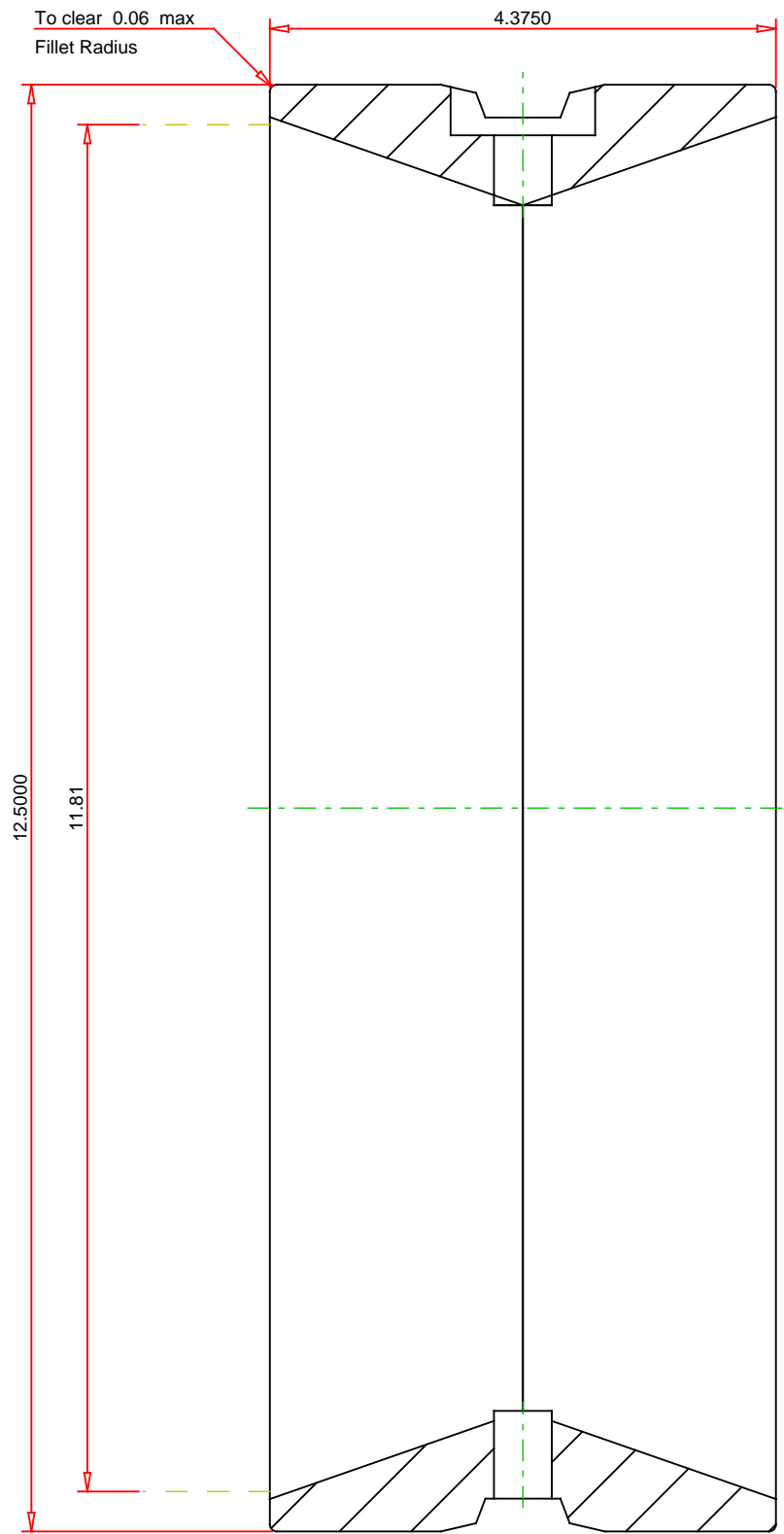

IMPERIAL UNITS

TIMKEN®

THE TIMKEN COMPANY
NORTH CANTON, OHIO USA

93127CD
DOUBLE TAPERED CUP