

The Timken Company

4500 Mt Pleasant St. NW

N. Canton, OH 44720

Phone: (234) 262-3000

E-Mail: CustomerCAD@timken.com • **Web site:** www.timken.com

Bearing Unit - Adapter Sleeve UK215 - H2315, UK 200 Wide Inner Ring Ball Bearings - Adapter Sleeve Locking

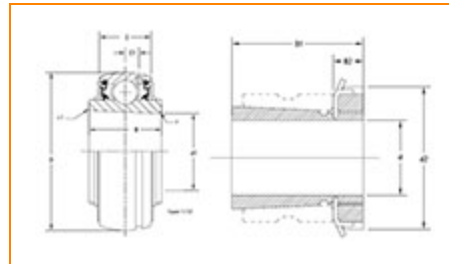
[Specifications](#) | [Dimensions](#) | [Basic Load Ratings](#)

Specifications

Bore Type	Tapered bore
Shaft Size d	65 mm
Adapter Sleeve Number¹	H2315
Material	Bearing Steel
Locking Style	Adapter Sleeve Locking

Dimensions

Outside Diameter D	130.000 mm 5.1180 in
Inside Ring Width B	51 mm 2.008 in



Outside Ring Width C	32 mm 1.26 in
Radius r	2.2 mm 0.087 in
Groove Position C1	9 mm 0.354 in
Dimension B1	73 mm 2.874 in

Basic Load Ratings

Static Load Rating	48300 N 10858 lbf
Dynamic Load Rating	67400 N 15152 lbf

¹ Purchase the Adapter Sleeve separately

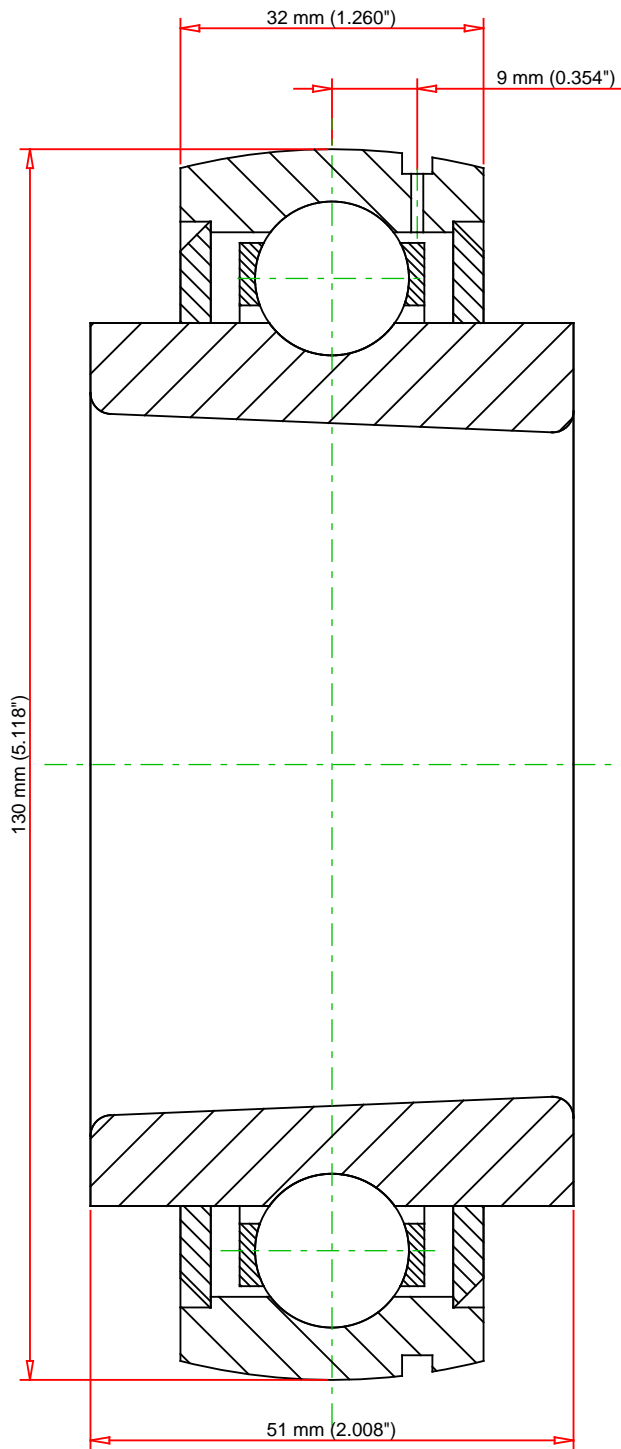

Weight	4.4 lb	2 kg	<div>TIMKEN®</div> <div>THE TIMKEN COMPANY</div> <div>NORTH CANTON, OHIO USA</div>			UK215 - H2315		
						UK 200 Wide Inner Ring Ball Bearings - Adapter Sleeve Locking		
			Basic Load Ratings - C _r		15152 lbf	67400 N		
			Load Ratings - C _{0r}		10858 lbf	48300 N		
Every reasonable effort has been made to ensure the accuracy of the information contained in this writing, but no liability is accepted for errors, omissions or for any other reason.						FOR DISCUSSION ONLY		