



The Timken Company

4500 Mt Pleasant St. NW

N. Canton, OH 44720

Phone: (234) 262-3000

E-Mail: CustomerCAD@timken.com • **Web site:** www.timken.com

Part Number UC307, UC 300 Wide Inner Ring Ball Bearings - Set Screw Locking

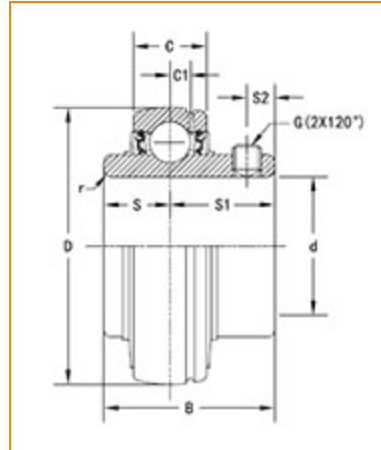

[Specifications](#) | [Dimensions](#) | [Basic Load Ratings](#)

Specifications

Bore Type	Cylindrical bore
Bearing Type	Ball Bearing
Shaft Size d	35 mm
Material	Bearing Steel
Locking Device	Set Screw Locking

Dimensions

Outside Diameter D	80 mm 3.150 in
---------------------------	-------------------



Outside Ring Width C 26 mm
1.024 in

Radius r 1.5 mm
0.059 in

Groove Position C1 7.5 mm
0.295 in

Center of Bearing from End S 19 mm
0.748 in

Dimension S1 29 mm
1.142 in

Set Screw Distance S2 8.00 mm
0.315 in

Set Screw Size M8×1

Number of Set Screws 2

Angle between Set Screws 120 °

Basic Load Ratings

Static Load Rating 19300 N
4339 lbf

Dynamic Load Rating 33400 N
7509 lbf

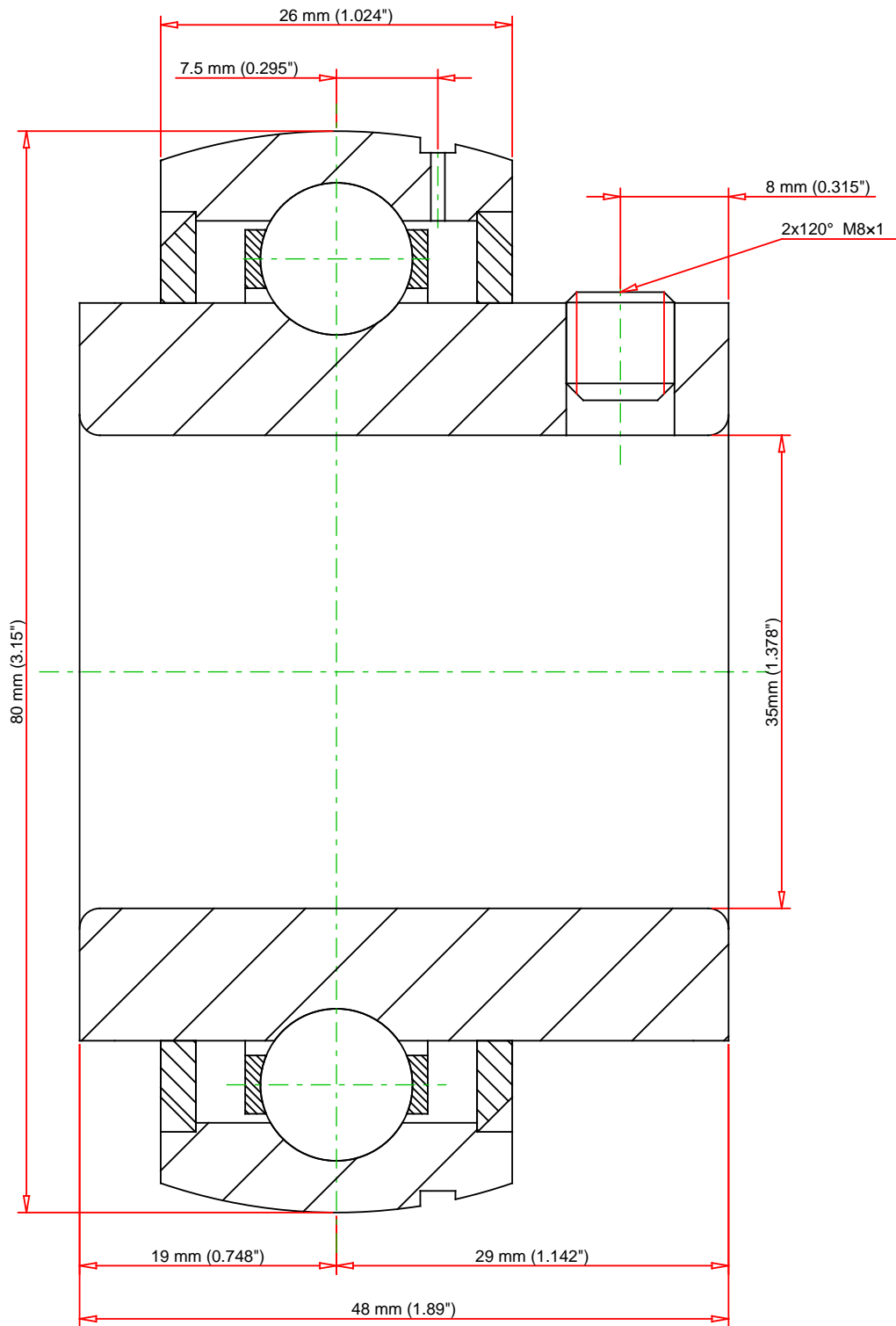

Weight	0.7 lb	0.3 kg
--------	--------	--------

TIMKEN®

THE TIMKEN COMPANY
NORTH CANTON, OHIO USA

UC307

UC 300 Wide Inner Ring Ball Bearings - Set Screw Locking

Basic Load Ratings - C _r	7509 lbf	33400 N
Load Ratings - C _{0r}	4339 lbf	19300 N

Every reasonable effort has been made to ensure the accuracy of the information contained in this writing, but no liability is accepted for errors, omissions or for any other reason.

FOR DISCUSSION ONLY