



The Timken Company

4500 Mt Pleasant St. NW

N. Canton, OH 44720

Phone: (234) 262-3000

E-Mail: CustomerCAD@timken.com • **Web site:** www.timken.com

Part Number UC306, UC 300 Wide Inner Ring Ball Bearings - Set Screw Locking

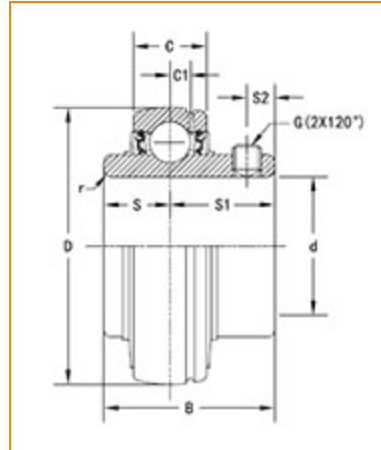

[Specifications](#) | [Dimensions](#) | [Basic Load Ratings](#)

Specifications

Bore Type	Cylindrical bore
Bearing Type	Ball Bearing
Shaft Size d	30 mm
Material	Bearing Steel
Locking Device	Set Screw Locking

Dimensions

Outside Diameter D	72.000 mm 2.835 in
---------------------------	-----------------------



Outside Ring Width C 24.0 mm
0.945 in

Radius r 1.1 mm
0.043 in

Groove Position C1 6.5 mm
0.256 in

Center of Bearing from End S 17 mm
0.669 in

Dimension S1 26 mm
1.024 in

Set Screw Distance S2 6 mm
0.236 in

Set Screw Size M6×0.75

Number of Set Screws 2

Angle between Set Screws 120 °

Basic Load Ratings

Static Load Rating 15000 N
3372 lbf

Dynamic Load Rating 26700 N
6002 lbf

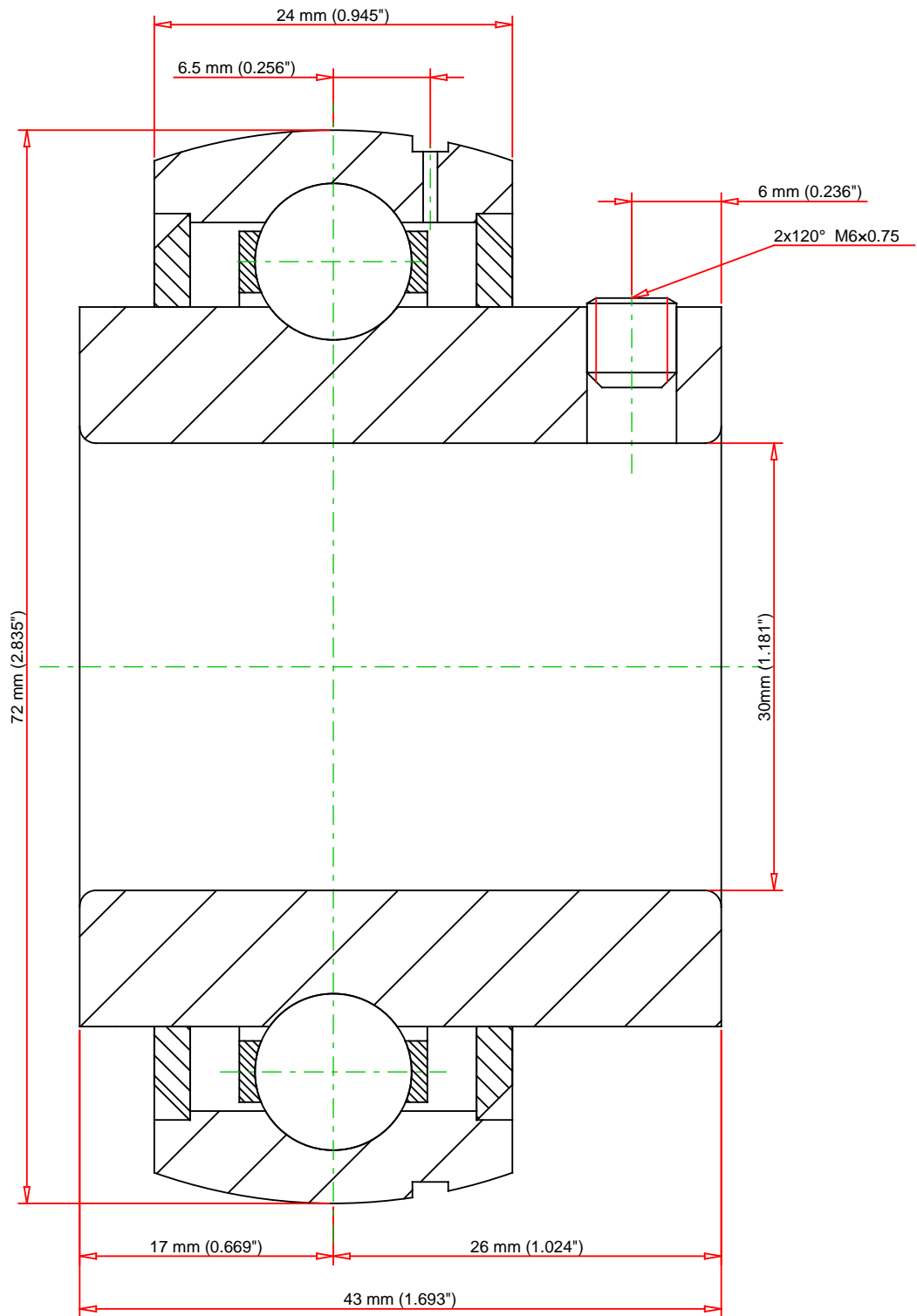

Weight		0.6 lb	0.3 kg	<div>TIMKEN®</div> <div>THE TIMKEN COMPANY NORTH CANTON, OHIO USA</div>	<div>UC306</div> <div>UC 300 Wide Inner Ring Ball Bearings - Set Screw Locking</div>		
					<div>Basic Load Ratings - C_r</div> <div>6002 lbf26700 N</div> <div>Load Ratings - C_{0r}</div> <div>3372 lbf15000 N</div>		
Every reasonable effort has been made to ensure the accuracy of the information contained in this writing, but no liability is accepted for errors, omissions or for any other reason.					FOR DISCUSSION ONLY		