



**The Timken Company**

4500 Mt Pleasant St. NW

N. Canton, OH 44720

**Phone:** (234) 262-3000

**E-Mail:** [CustomerCAD@timken.com](mailto:CustomerCAD@timken.com) • **Web site:** [www.timken.com](http://www.timken.com)

## Part Number SCJT 1/2, Fafnir® Two-Bolt Flanged Mounted Bearings Setscrew Locking



### SCJT Standard Series

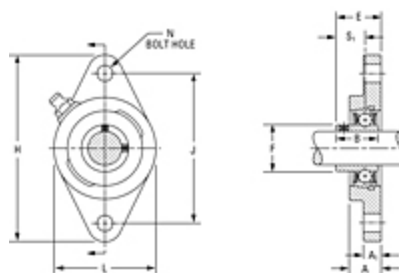

[Specifications](#) | [Dimensions](#) | [Basic Load Ratings](#)

#### Specifications

<b>Series</b>	Standard
<b>Shaft Size d</b>	1/2 in
<b>Bearing Type</b>	Ball Bearing
<b>Bearing Number</b>	GYA008RRB
<b>Seal Type</b>	Narrow Shroud
<b>Housing Construction</b>	Two-Bolt Flange
<b>Alternate Part Name</b>	SCJT1/2

#### Dimensions



**Total Length H**

98.4 mm

3.874 in

<b>Total Height L</b>	60.3 mm 2.374 in
<b>Housing Width A</b>	17.9 mm 0.705 in
<b>Bolt Hole Spacing J</b>	76.2 mm 3 in
<b>Bolt Hole Size N</b>	9.9 mm 0.39 in
<b>Flange Thickness A1</b>	11.1 mm 0.437 in
<b>Inside Ring Width B</b>	23.8 mm 0.937 in
<b>Dimension S1</b>	15.85 mm 0.624 in
<b>Dimension E</b>	25.4 mm 1 in
<b>Dimension F</b>	24.6 mm 0.969 in

## Basic Load Ratings

<b>Static Load Rating</b>	4700 N 1070 lbf
<b>Dynamic Load Rating</b>	10700 N 2380 lbf

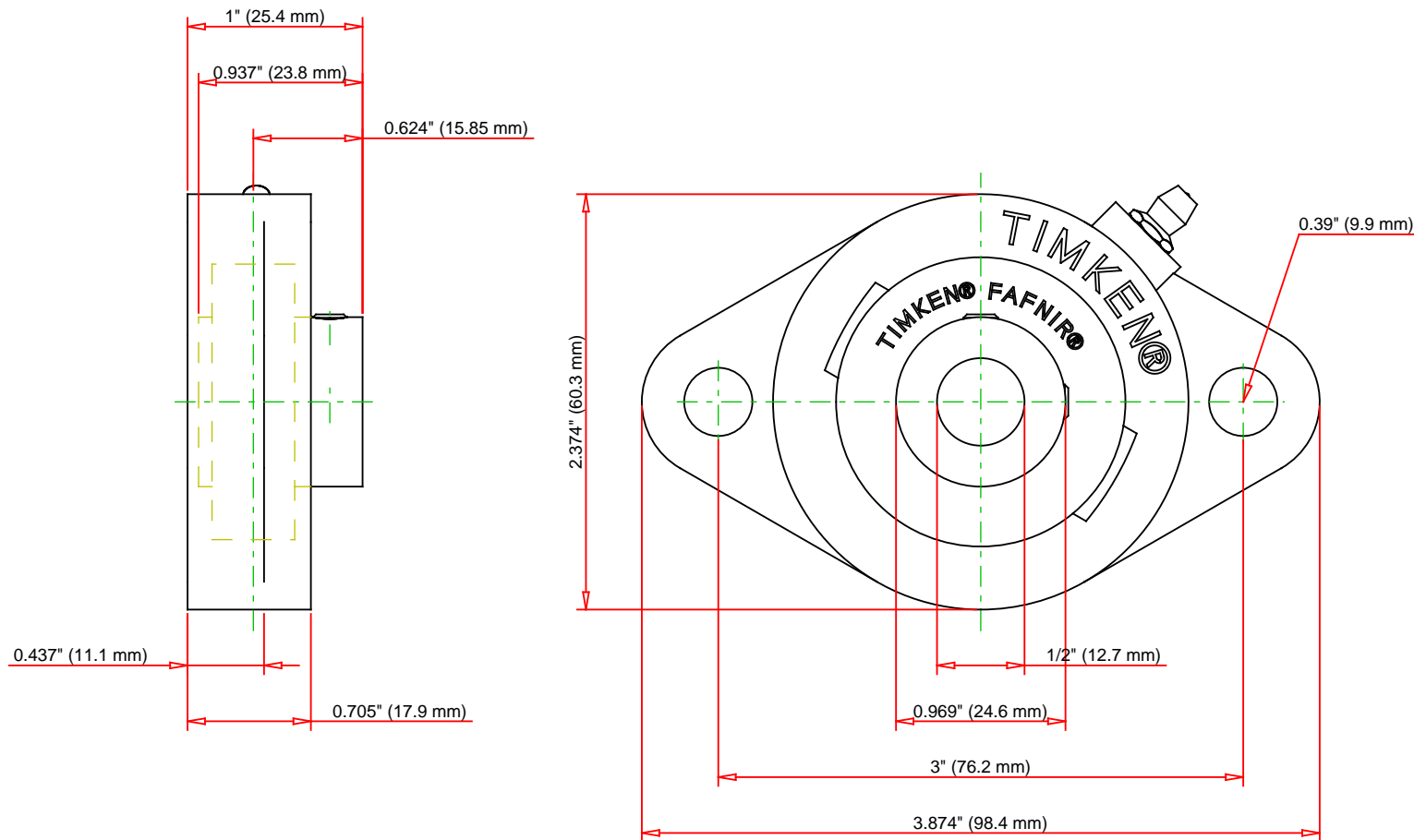

Bearing Number	GYA008RRB			
Load Ratings - C <sub>r</sub>	2380	lbf	10700	N
Load Ratings - C <sub>0r</sub>	1070	lbf	4700	N
Weight	0.75	lb	0.34	kg
Bolt Size	M5x0.8			

**TIMKEN®**

THE TIMKEN COMPANY  
NORTH CANTON, OHIO USA

**SCJT 1/2**

Fafnir® Two-Bolt Flanged Mounted Bearings  
Setscrew Locking

Every reasonable effort has been made to ensure the accuracy of the information contained in this writing, but no liability is accepted for errors, omissions or for any other reason.

**FOR DISCUSSION ONLY**