

IZF
10

IZF
10R

Fan Type Ionizer

IZF10/IZF10R Series



RoHS

How to Order



Without Flow Rate Adjustment Function

IZF10-□-□-□B

Compact fan type

Air flow

Nil	0.66 m ³ /min
L	0.46 m ³ /min

With flow rate adjustment function

With Flow Rate Adjustment Function

IZF10R-□-□B

Compact fan type

With flow rate adjustment function
(0.19 to 0.80 m³/min)

Bracket

Nil	None
B	With bracket

Output

Nil	NPN output
P	PNP output

Power supply cable, AC adapter

Nil	With power supply cable (3 m)
Z	With power supply cable (10 m)
H*1	e-con connector
Q	With AC adapter (with AC cord)
R	With AC adapter (without AC cord)
N	None

*1: A power supply connector for customers supplying their own cable
Can only be used if the IZF10 is selected.

IZF10/IZF10R Series

Specifications

Model	IZF10-□□	IZF10-L-□□	IZF10R-□□	IZF10-P-□□	IZF10-LP-□□	IZF10R-P-□□
Maximum air flow	0.66 m³/min	0.46 m³/min	0.80 m³/min (Max.)	0.66 m³/min	0.46 m³/min	0.80 m³/min (Max.)
Ion generation method	Corona discharge type					
Method of applying voltage	DC type					
Applied voltage	±5 kV					
Offset voltage (Ion balance)*1	Within ±13 V					
Power supply voltage	21.6 to 26.4 VDC (Within 24 VDC ±10%)					
Power consumption	220 mA or less	140 mA or less	270 mA or less	250 mA or less	170 mA or less	270 mA or less
Switch output	NPN open collector output Maximum load current: 80 mA Residual voltage: 1 V or less (Load current: 80 mA) Maximum load voltage: 26.4 VDC		NPN open collector output Maximum load current: 150 mA Residual voltage: 1 V or less (Load current: 150 mA) Maximum load voltage: 26.4 VDC	PNP open collector output Maximum load current: 80 mA Residual voltage: 1 V or less (Load current: 80 mA)		PNP open collector output Maximum load current: 150 mA Residual voltage: 1 V or less (Load current: 150 mA)
Ambient temperature	Operating: 0 to 50°C, Stored: -10 to 60°C					
Ambient humidity	Operating, Stored: 35 to 80%RH (No condensation)					
Material	Case: ABS/Stainless steel, Emitter: Tungsten					
Weight	280 g (With bracket: 360 g)		260 g (With bracket: 340 g)	280 g (With bracket: 360 g)		260 g (With bracket: 340 g)
Applicable standard/directive	CE (EMC directive: 2004/108/EC)		CE (EMC directive: 2014/30/EU)	CE (EMC directive: 2004/108/EC)		CE (EMC directive: 2014/30/EE

*1: Based on ANSI/ESD-STM3.1-2006 standards

AC Adapter (IZF10/10R-CG1, IZF10/10R-CG2)

Input voltage	100 to 240 VAC, 50/60 Hz
Output voltage	24 VDC
Output current	1 A max
Ambient temperature	0 to 40°C, Stored: -20 to 65°C
Ambient humidity	Operating, Stored: 10 to 90%RH (No condensation)
Applicable standard/directive	CE/cUL

Functions and Indications

No.	Name	Panel display	Type	Description
1	Power supply switch	—	Switch	Switch to turn this product ON and OFF.
2	Power supply indicator	—	LED (Green/Orange)	The LED is ON green when power is supplied to this product, and is ON orange during an incorrect high voltage alarm or output signal over current alarm.
3	Error indicator	ALARM	LED (Red)	The LED turns ON when an incorrect voltage alarm is generated for 100 ms or more.
4	Maintenance indicator	NDL	LED (Green)	The LED is ON green when the emitter is contaminated or worn.
5	Air flow adjustment*1	BLOW SPEED	Rotary switch	Adjusts air flow with fan.
6	Balance adjustment	—	Trimmer	Adjusts offset voltage (ion balance).
7	Connector	—	Connector	Connect the power supply cable or AC adapter.

*1: Only for IZF10R

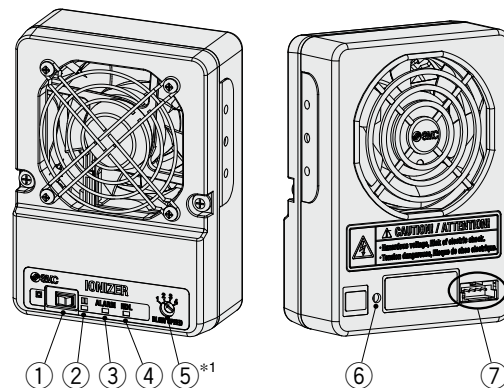

Alarm

Alarm name	Output signal at the time of alarm*1	LED	Operation after alarm generated	Description	Action to reset alarm
Incorrect high voltage	Error signal OFF (B contact)	Power supply (Orange) Error indicator (Red)	Stop	Incorrect function of the high voltage circuit for 100 ms or more.	Supply power again
Excess current on output circuit	Signal due to excess current OFF	Power supply (Orange)	Continue	Excess current is present on the output circuit.	Reset automatically.
Maintenance warning	Maintenance signal ON (A contact)	Maintenance (Green)	Continue	When static electricity neutralization performance is reduced due to contamination or wear of the emitters.	Supply power again

*1: NPN/PNP open collector output

IZF10/IZF10R Series

Dimensions

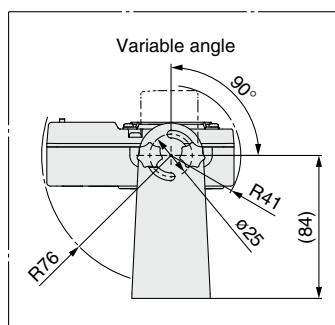
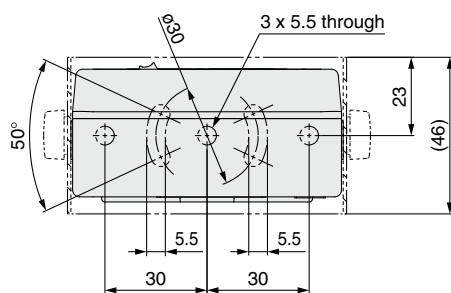
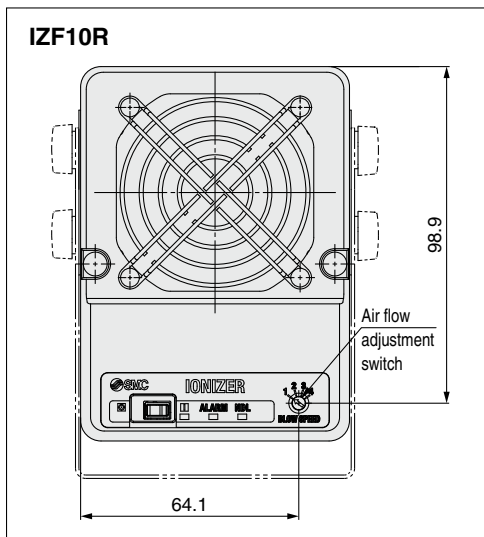
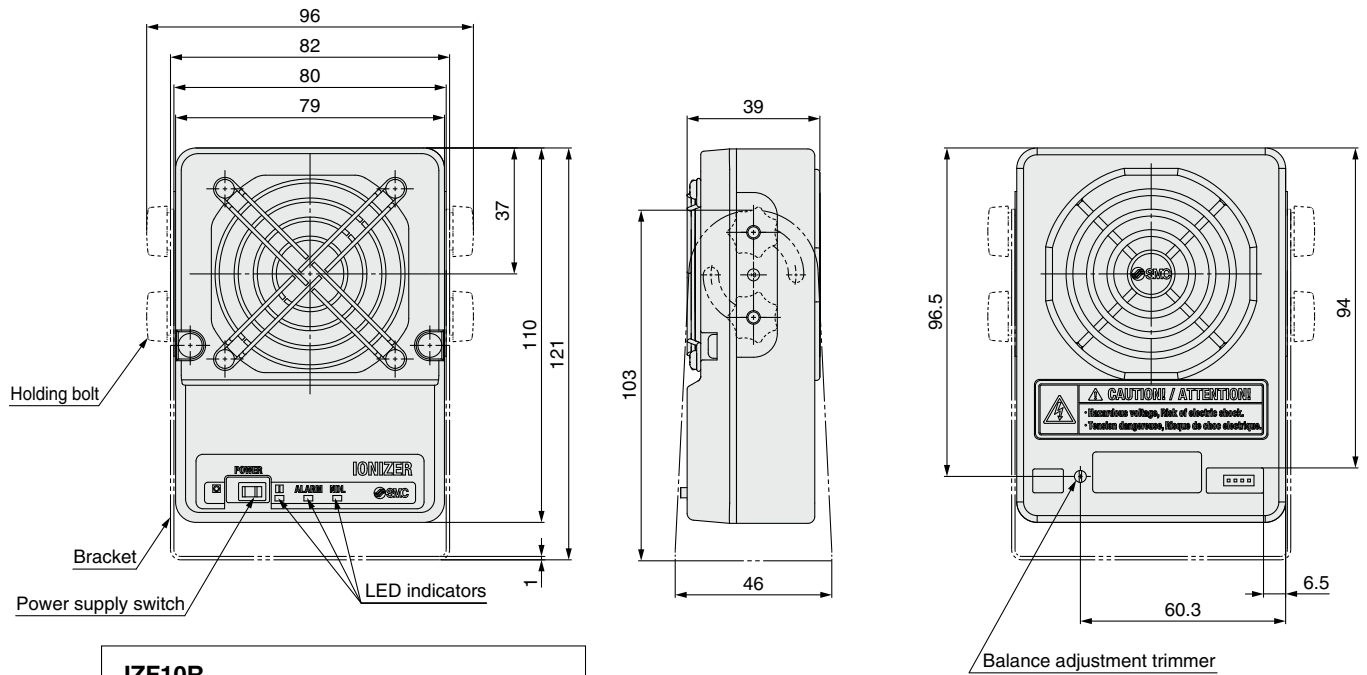

Without bracket

