



The Timken Company

4500 Mt Pleasant St. NW

N. Canton, OH 44720

Phone: (234) 262-3000

E-Mail: CustomerCAD@timken.com • **Web site:** www.timken.com

Part Number 2925, Tapered Roller Bearings - Single Cups - Imperial

This is the most basic and most widely used type of tapered roller bearing. It consists of two main separable parts: the cone (inner ring) assembly and the cup (outer ring). It is typically mounted in opposing pairs on a shaft.

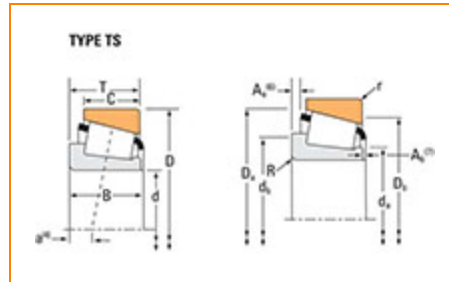

[Specifications](#) | [Dimensions](#) | [Abutment and Fillet Dimensions](#) | [Factors](#)

Specifications

Series	2900
Cup Part Number	2925
Design Units	Imperial

Dimensions

D - Cup Outer Diameter	87.313 mm
C - Cup Width	22.225 mm

Abutment and Fillet Dimensions



r - Cup Backface "To Clear"

Radius¹

2.29 mm

**Da - Cup Frontface Backing
Diameter**

82.00 mm

**Db - Cup Backface Backing
Diameter**

74.93 mm

Factors

e - ISO Factor²

0.35

Y - ISO Factor³

1.73

Cg - Geometry Factor⁴

0.0832

¹ These maximum fillet radii will be cleared by the bearing corners.

² These factors apply for both inch and metric calculations. Consult your Timken representative for instruction on use.

³ These factors apply for both inch and metric calculations. Consult your Timken representative for instruction on use.

⁴ Geometry constant for Lubrication Life Adjustment Factor a3l.

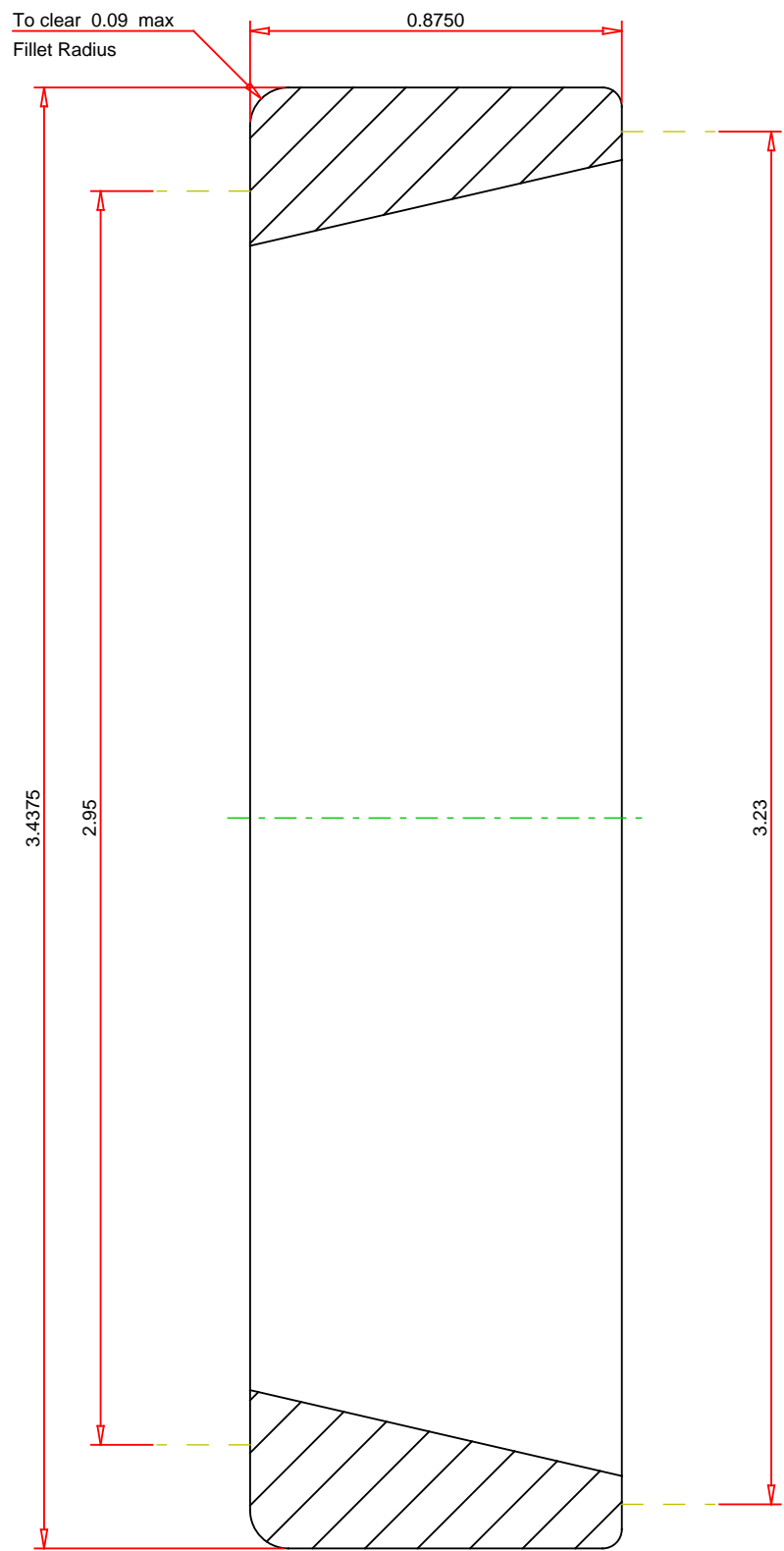

IMPERIAL UNITS

TIMKEN®

THE TIMKEN COMPANY
NORTH CANTON, OHIO USA

2925
Tapered Roller Bearings - Single Cups - Imperial