

3/2-way solenoid valve, G1/4, bistable - Mod. 434-011...

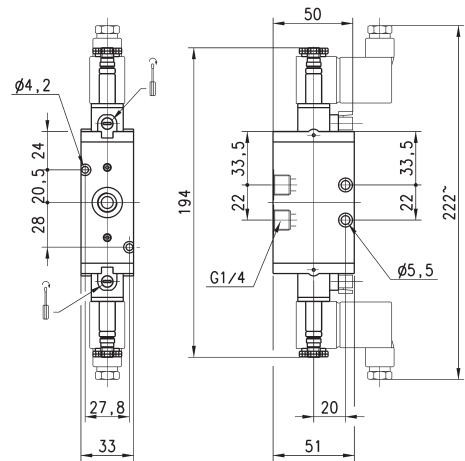

These solenoid valves, which have electropneumatic actuation and return, assume the NC (closed) or NO (open) position depending on the last pulse received.

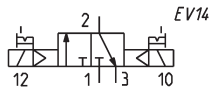

Mod.	Function	Flow rate Qn (l/min)	Operating pressure (bar)
434-011-22	3/2	1250	2 ÷ 10

5/2-way solenoid valve, G1/4, monostable - Mod. 454...



These solenoid valves, which have electropneumatic actuation and spring return, are suitable for operating double-acting cylinders.

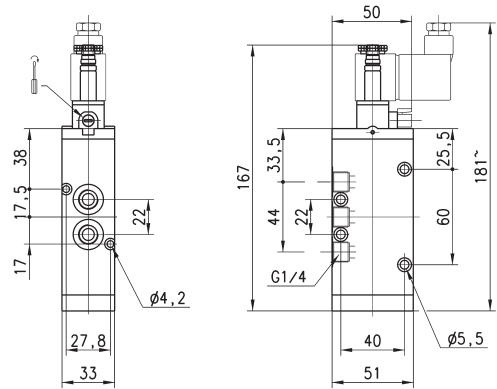
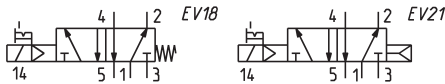

Mod.	Function	Flow rate Qn (l/min)	Operating pressure (bar)	Symbol
454-015-22	5/2	1250	2.5 ÷ 10	EV18
454-016-22	5/2	1250	2.5 ÷ 10	EV21