

The Timken Company

4500 Mt Pleasant St. NW

N. Canton, OH 44720

Phone: (234) 262-3000

E-Mail: CustomerCAD@timken.com • **Web site:** www.timken.com

Bearing Unit - Adapter Sleeve UK210 - H2310, UK 200 Wide Inner Ring Ball Bearings - Adapter Sleeve Locking

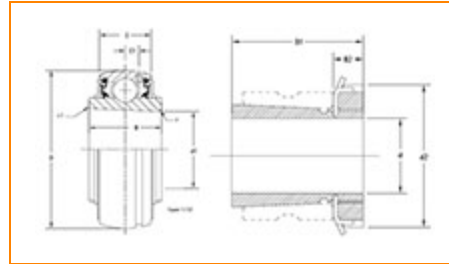

[Specifications](#) | [Dimensions](#) | [Basic Load Ratings](#)

Specifications

Bore Type	Tapered bore
Shaft Size d	45 mm
Adapter Sleeve Number¹	H2310
Material	Bearing Steel
Locking Style	Adapter Sleeve Locking

Dimensions

Outside Diameter D	90.000 mm 3.543 in
Inside Ring Width B	36 mm 1.417 in



Outside Ring Width C	24.0 mm 0.945 in
Radius r	1.5 mm 0.060 in
Groove Position C1	6 mm 0.236 in
Dimension B1	55 mm 2.165 in

Basic Load Ratings

Static Load Rating	23300 N 5238 lbf
Dynamic Load Rating	35100 N 7891 lbf

¹ Purchase the Adapter Sleeve separately

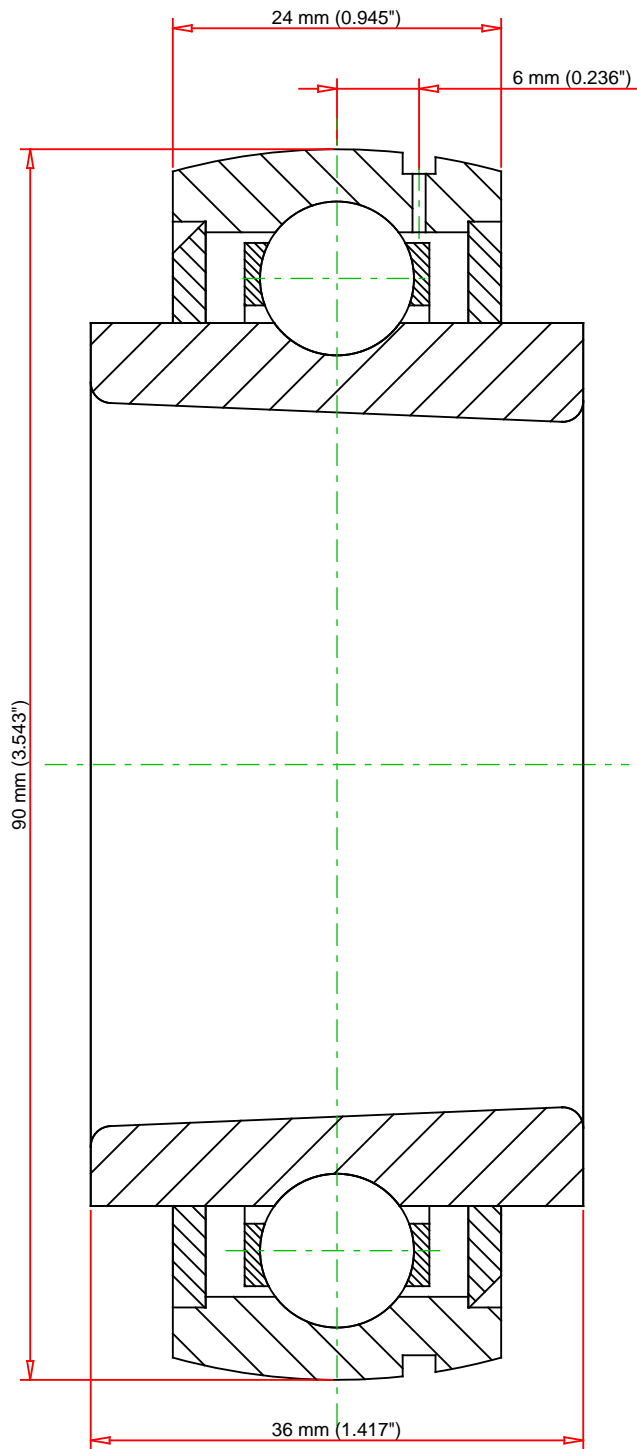

Weight	1.4 lb	0.7 kg	<div>TIMKEN®</div> <div>THE TIMKEN COMPANY</div> <div>NORTH CANTON, OHIO USA</div>			<div>UK210 - H2310</div> <div>UK 200 Wide Inner Ring Ball Bearings - Adapter Sleeve Locking</div>		
						Basic Load Ratings - C _r		
			Load Ratings - C _{0r}			5238 lbf	23300 N	
Every reasonable effort has been made to ensure the accuracy of the information contained in this writing, but no liability is accepted for errors, omissions or for any other reason.						FOR DISCUSSION ONLY		