



The Timken Company

4500 Mt Pleasant St. NW

N. Canton, OH 44720

Phone: (234) 262-3000

E-Mail: CustomerCAD@timken.com • **Web site:** www.timken.com

Part Number 67920-B, Tapered Roller Bearings - Single Flanged Cups - Imperial

Like the TS bearing design, the TSF design consists of two main separable parts: the cone (inner ring) assembly and the cup (outer ring). It is typically mounted in opposing pairs on a shaft. TSF bearings have flanged cups to facilitate axial location and accurately align seals in through-bored housings.

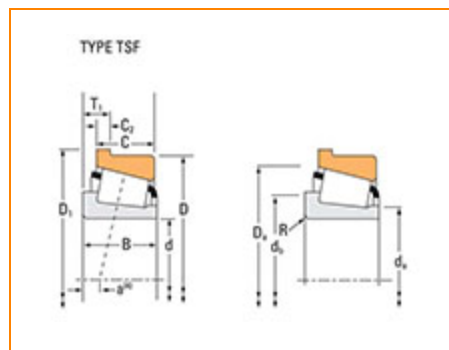

[Specifications](#) | [Dimensions](#) | [Abutment and Fillet Dimensions](#) | [Factors](#)

Specifications

Series	67900
Cup Part Number	67920-B
Design Units	Imperial

Dimensions

D - Cup Outer Diameter	11.1250 in 282.575 mm
D1 - Flange Outer Diameter	11.4022 in 289.616 mm
C - Cup Width	1.4375 in 36.513 mm

C1 - Cup Flange Width0.2813 in
7.145 mm**Abutment and Fillet Dimensions****r - Cup Backface "To Clear"
Radius¹**0.130 in
3.3 mm**Da - Cup Frontface Backing
Diameter**10.87 in
276.10 mm**Factors****K - Factor²**

1.15

e - ISO Factor³

0.51

Y - ISO Factor⁴

1.18

Cg - Geometry Factor⁵

0.135

¹ These maximum fillet radii will be cleared by the bearing corners.² These factors apply for both inch and metric calculations. Consult your Timken representative for instruction on use.³ These factors apply for both inch and metric calculations. Consult your Timken representative for instruction on use.⁴ These factors apply for both inch and metric calculations. Consult your Timken representative for instruction on use.⁵ Geometry constant for Lubrication Life Adjustment Factor a3l.

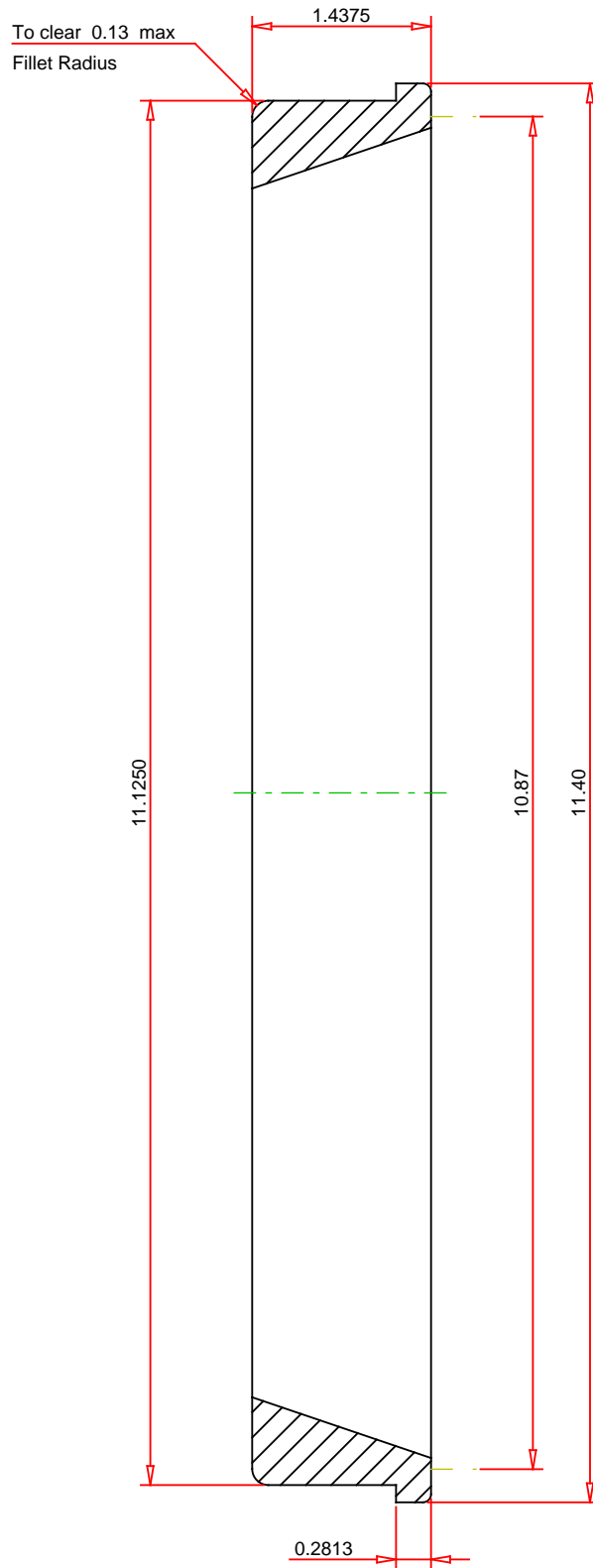

IMPERIAL UNITS

TIMKEN®

THE TIMKEN COMPANY
NORTH CANTON, OHIO USA

67920-B
SINGLE TAPERED CUP WITH FLANGE