



**The Timken Company**

4500 Mt Pleasant St. NW

N. Canton, OH 44720

**Phone:** (234) 262-3000

**E-Mail:** [CustomerCAD@timken.com](mailto:CustomerCAD@timken.com) • **Web site:** [www.timken.com](http://www.timken.com)

## Part Number 563, Tapered Roller Bearings - Single Cups - Imperial

This is the most basic and most widely used type of tapered roller bearing. It consists of two main separable parts: the cone (inner ring) assembly and the cup (outer ring). It is typically mounted in opposing pairs on a shaft.

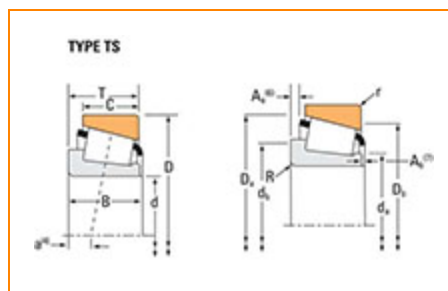

[Specifications](#) | [Dimensions](#) | [Abutment and Fillet Dimensions](#) | [Factors](#)

### Specifications

Series	565
Cup Part Number	563
Design Units	Imperial

### Dimensions

D - Cup Outer Diameter	5 in 127 mm
C - Cup Width	1.1250 in 28.575 mm

### Abutment and Fillet Dimensions

<b>r - Cup Backface "To Clear" Radius<sup>1</sup></b>	0.130 in 3.3 mm
<b>Da - Cup Frontface Backing Diameter</b>	4.75 in 119.90 mm
<b>Db - Cup Backface Backing Diameter</b>	4.41 in 112.01 mm

## Factors

<b>e - ISO Factor<sup>2</sup></b>	0.36
<b>Y - ISO Factor<sup>3</sup></b>	1.65
<b>Cg - Geometry Factor<sup>4</sup></b>	0.117

<sup>1</sup> These maximum fillet radii will be cleared by the bearing corners.

<sup>2</sup> These factors apply for both inch and metric calculations. Consult your Timken representative for instruction on use.

<sup>3</sup> These factors apply for both inch and metric calculations. Consult your Timken representative for instruction on use.

<sup>4</sup> Geometry constant for Lubrication Life Adjustment Factor a3l.

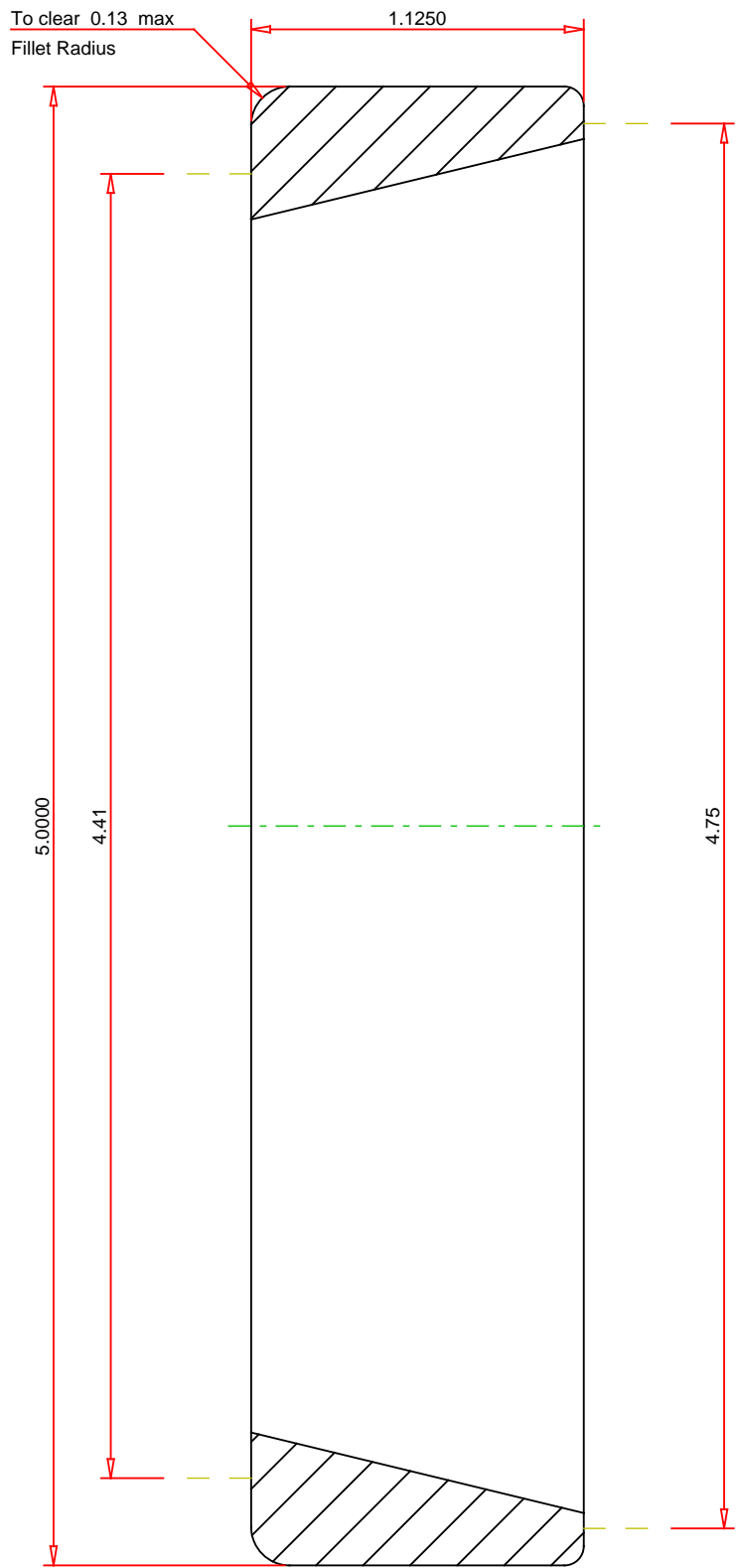

IMPERIAL UNITS

**TIMKEN®**

**THE TIMKEN COMPANY**  
NORTH CANTON, OHIO USA

**563**  
SINGLE TAPERED CUP