



The Timken Company

4500 Mt Pleasant St. NW

N. Canton, OH 44720

Phone: (234) 262-3000

E-Mail: CustomerCAD@timken.com • **Web site:** www.timken.com

Bearing Unit - Adapter Sleeve UK209 - H2309, UK 200 Wide Inner Ring Ball Bearings - Adapter Sleeve Locking

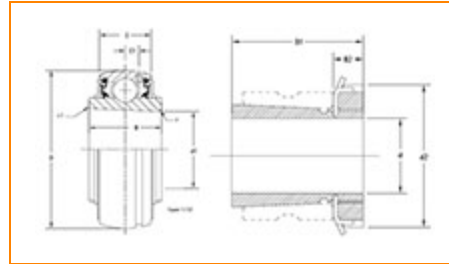

[Specifications](#) | [Dimensions](#) | [Basic Load Ratings](#)

Specifications

Bore Type	Tapered bore
Shaft Size d	40 mm
Adapter Sleeve Number¹	H2309
Material	Bearing Steel
Locking Style	Adapter Sleeve Locking

Dimensions

Outside Diameter D	85 mm
Inside Ring Width B	36 mm
Outside Ring Width C	22.0 mm



Radius r	1.5 mm
----------	--------

Groove Position C1	6 mm
--------------------	------

Dimension B1	50 mm
--------------	-------

Basic Load Ratings

Static Load Rating	21300 N
--------------------	---------

Dynamic Load Rating	34100 N
---------------------	---------

¹ Purchase the Adapter Sleeve separately

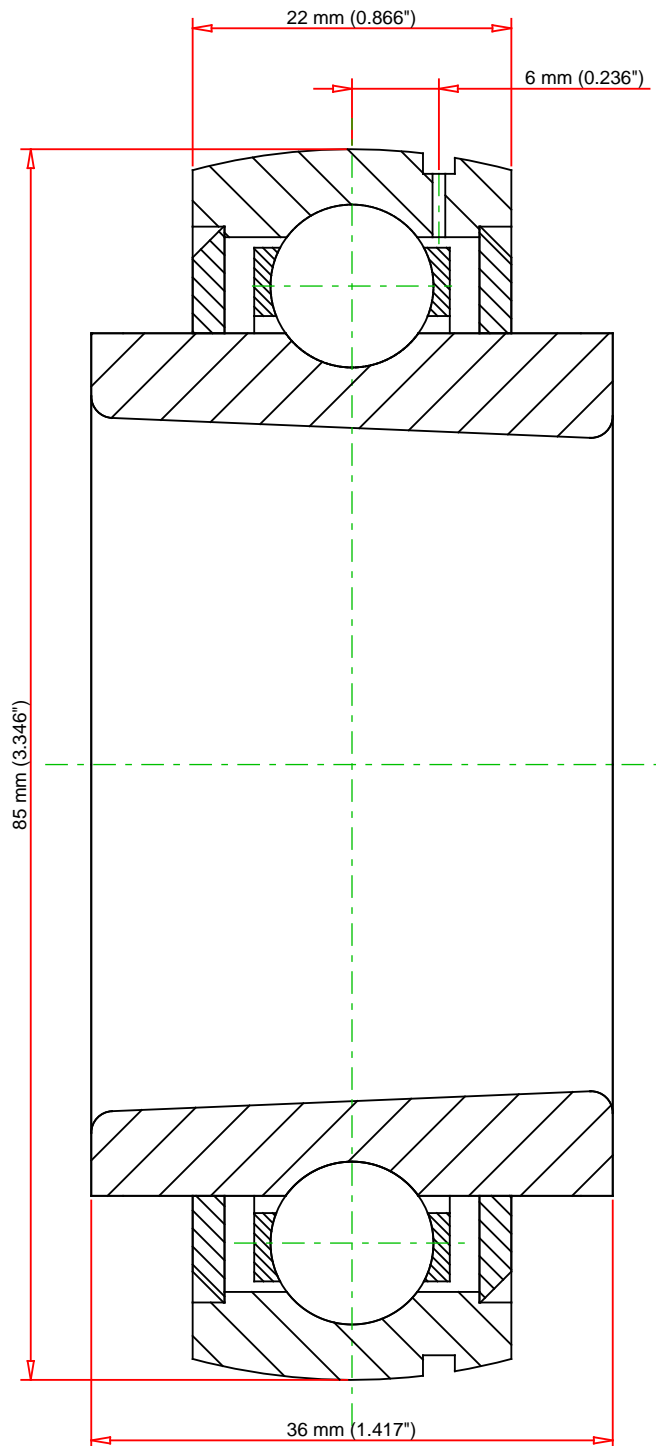

Weight	1.4 lb	0.7 kg	<div>TIMKEN®</div> <div>THE TIMKEN COMPANY</div> <div>NORTH CANTON, OHIO USA</div>			UK209 - H2309		
						UK 200 Wide Inner Ring Ball Bearings - Adapter Sleeve Locking		
			Basic Load Ratings - C _r		7666 lbf	34100 N		
Load Ratings - C _{0r}		4788 lbf	21300 N	FOR DISCUSSION ONLY				
Every reasonable effort has been made to ensure the accuracy of the information contained in this writing, but no liability is accepted for errors, omissions or for any other reason.								