



**The Timken Company**

4500 Mt Pleasant St. NW

N. Canton, OH 44720

**Phone:** (234) 262-3000

**E-Mail:** [CustomerCAD@timken.com](mailto:CustomerCAD@timken.com) • **Web site:** [www.timken.com](http://www.timken.com)

## Bearing Unit - Adapter Sleeve UK208 - H2308, UK 200 Wide Inner Ring Ball Bearings - Adapter Sleeve Locking

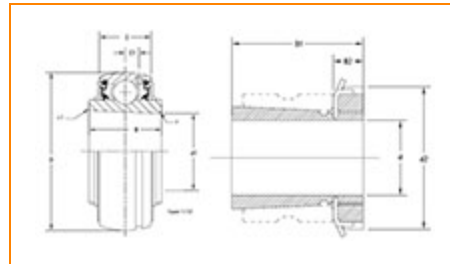

[Specifications](#) | [Dimensions](#) | [Basic Load Ratings](#)

### Specifications

<b>Bore Type</b>	Tapered bore
<b>Shaft Size d</b>	35 mm
<b>Adapter Sleeve Number<sup>1</sup></b>	H2308
<b>Material</b>	Bearing Steel
<b>Locking Style</b>	Adapter Sleeve Locking

### Dimensions

<b>Outside Diameter D</b>	80 mm
<b>Inside Ring Width B</b>	34 mm
<b>Outside Ring Width C</b>	21 mm



Radius r	1.5 mm
----------	--------

Groove Position C1	6 mm
--------------------	------

Dimension B1	46 mm
--------------	-------

#### Basic Load Ratings

Static Load Rating	17800 N
--------------------	---------

Dynamic Load Rating	29100 N
---------------------	---------

<sup>1</sup> Purchase the Adapter Sleeve separately

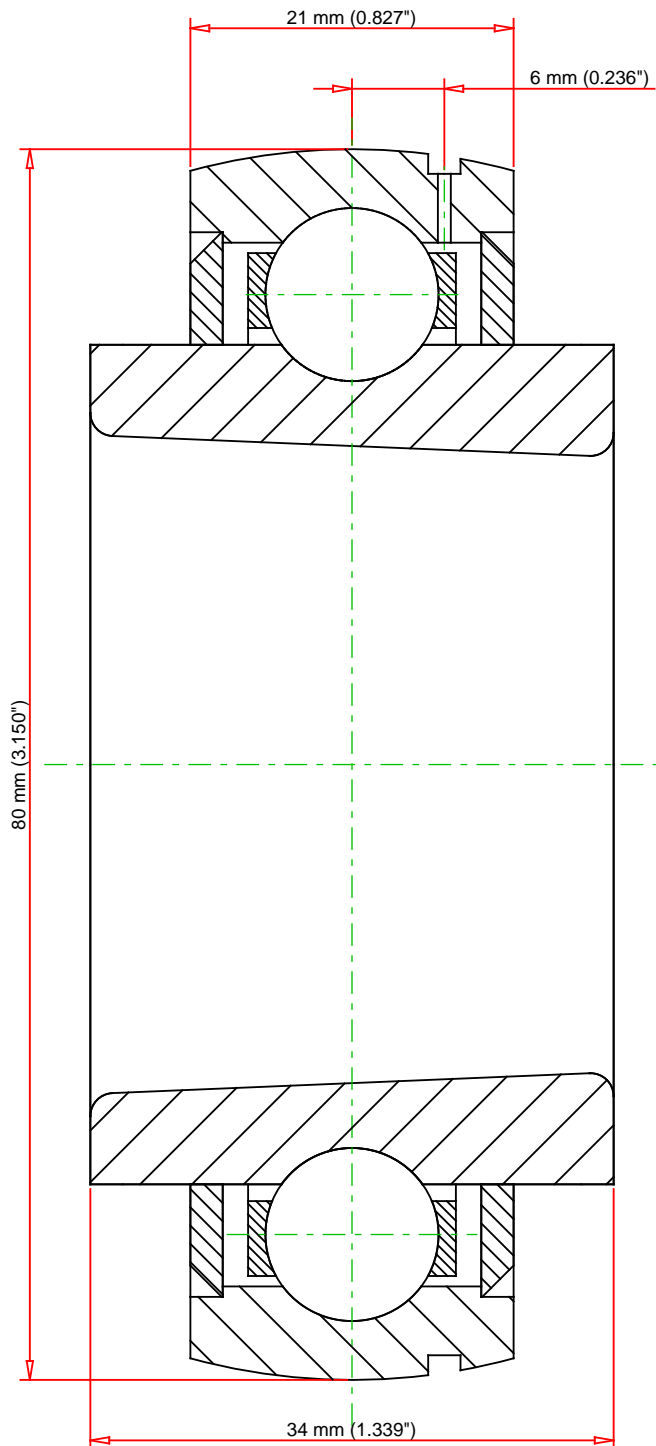

Weight	1.3 lb	0.6 kg	<div>TIMKEN®</div> <div>THE TIMKEN COMPANY</div> <div>NORTH CANTON, OHIO USA</div>			UK208 - H2308		
						UK 200 Wide Inner Ring Ball Bearings - Adapter Sleeve Locking		
			Basic Load Ratings - C <sub>r</sub>		6542 lbf	29100 N		
Load Ratings - C <sub>0r</sub>		4002 lbf	17800 N	FOR DISCUSSION ONLY				
Every reasonable effort has been made to ensure the accuracy of the information contained in this writing, but no liability is accepted for errors, omissions or for any other reason.								