

Carriages KWVE15-B-EC (Series KWVE...-B-EC)

expanded interchangeability, short carriage, four-row; corrosion-resistant design possible

The datasheet is only an overview of dimensions and basic load ratings of the selected product. Please always observe all the guidelines in these overview pages. Further information is given on many products under the menu item "Description". You can also order comprehensive information via the Catalogue ordering system (https://www.schaeffler.de/content.schaeffler.de/en/news_media/index.jsp) or by telephone on +49 (91 32) 82 - 28 97.

H	24 mm	
B	52 mm	
L	44,5 mm	
1)	Locating face	
2)	Marking	
3)	No thread	
A ₁	18,5 mm	
A ₂	5,5 mm	
A ₃	4,3 mm	
A ₄	3,2 mm	
aL max	53 mm	aL and aR are dependent on the guideway length

aL min	20 mm	aL and aR are dependent on the guideway length
aR max	53 mm	aL and aR are dependent on the guideway length
aR min	20 mm	aL and aR are dependent on the guideway length
b	15 mm	Tolerance: -0,005/-0,03
d1	4,6 mm	
D2	4,5 mm	
G3	M3 mm	Maximum permissible screw depth for lubrication connectors. M3 = 5,5 M5 = 7 M6 = 7
G4	M3	Maximum permissible screw depth for lubrication connector: 5,5 mm
h	15 mm	
H1	4,3 mm	
h1	7,6 mm	
H4	6,1 mm	
H5	4,75 mm	
JB	41 mm	
jL	60 mm	
JL6	15,8 mm	
K1	M4	for screws to DIN ISO 4762-12.9 Max. tightening torque [MA]: M4 = 5 Nm

		<p>M5 = 10 Nm M6 = 17 Nm M8 = 41 Nm M10 = 83 Nm M12 = 140 Nm M14 = 220 Nm</p> <p>The stated torques represent maximum values for the reliable transmission of forces in vibration-free, quasistatic applications (S0=1). We recommend that the tightening torques of the screw connection to the adjacent construction should be determined at the customer under the specific application conditions and operating conditions, observing the data in VDI Guideline 2230 Part 1 (2015) and the data in the description.</p>
K3	M4	<p>for screws to DIN ISO 4762-12.9 Max. tightening torque [MA]: M4 = 5 Nm M5 = 10 Nm M6 = 17 Nm M8 = 41 Nm M10 = 83 Nm M12 = 140 Nm M14 = 220 Nm</p> <p>The stated torques represent maximum values for the reliable transmission of forces in vibration-free, quasistatic applications (S0=1). We recommend that the tightening torques of the screw connection to the adjacent construction should be determined at the customer under the specific application conditions and operating conditions, observing the data in VDI Guideline 2230 Part 1 (2015) and the data in the description.</p>
L1	23,1 mm	
l _{max}	2880 mm	Maximum length of single-piece guideways. Permissible guideway segments, see Technical principles
Ls	1,3 mm	
T ₅	7 mm	

mw	0,13 kg	Mass of carriage
ms	1,44 kg/m	Mass of guideway
		<p>Calculation of basic load rating according to ISO 14728-1. increased basic dynamic load rating possible on the basis of practical experience.</p> <p>The full load rating can only be supported if the full thread length is used and the adjacent construction is correspondingly dimensioned.</p>
C	4900 N	Basic dynamic load rating
C ₀	8300 N	Basic static load rating
M _{0x}	86 Nm	Static moment rating about X axis
M _{0y}	35 Nm	Static moment rating about Y axis
M _{0z}	35 Nm	Static moment rating about Z axis
		<p>Lubrication connectors are included loose:</p> <p>S04 with KUVE20-B</p> <p>S05 with KUVE25-B to KUVE55-B</p> <p>S16 with KUVE15-B</p>

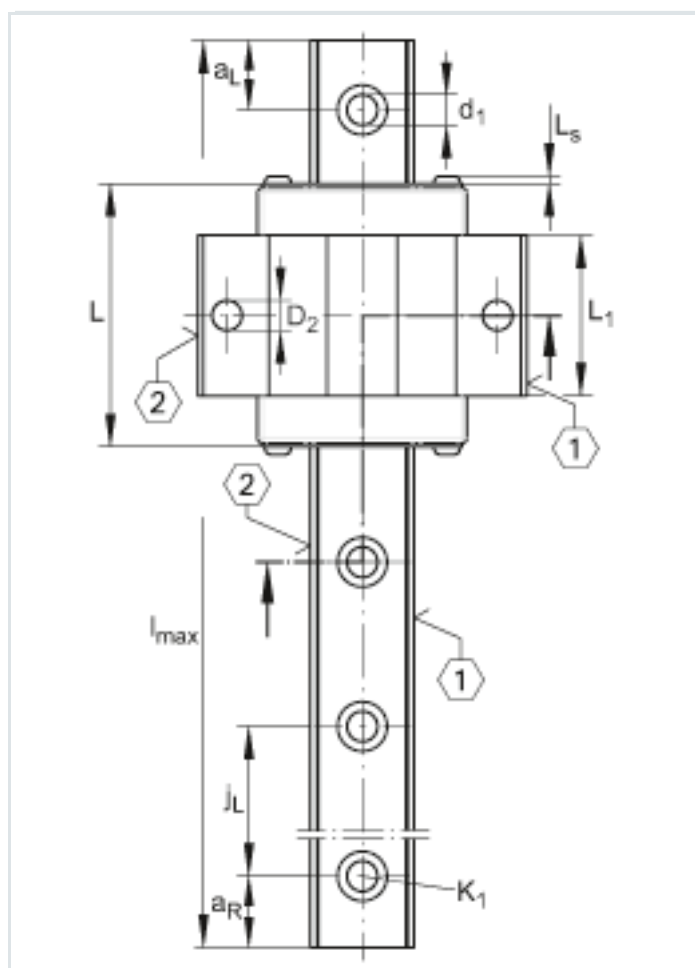
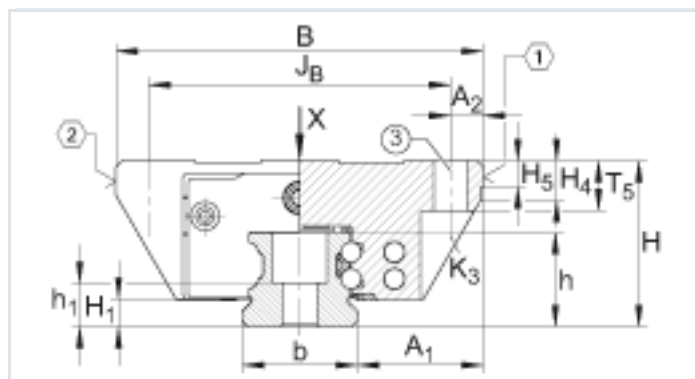

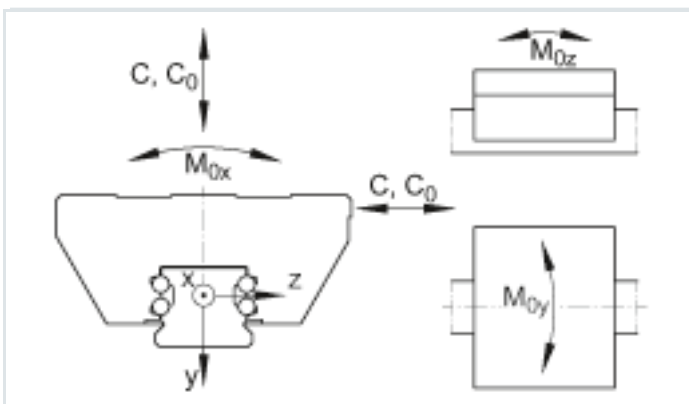
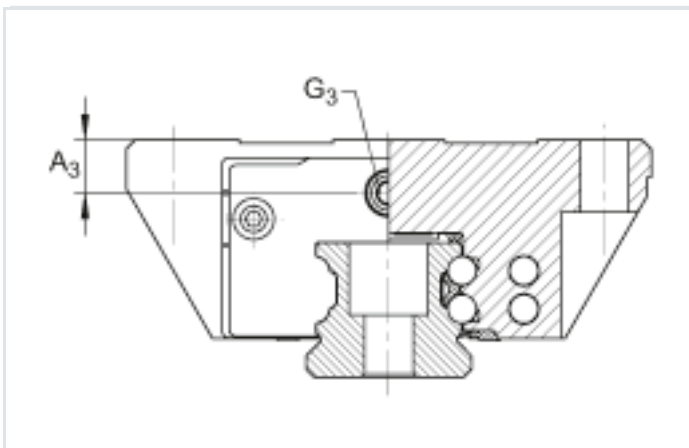
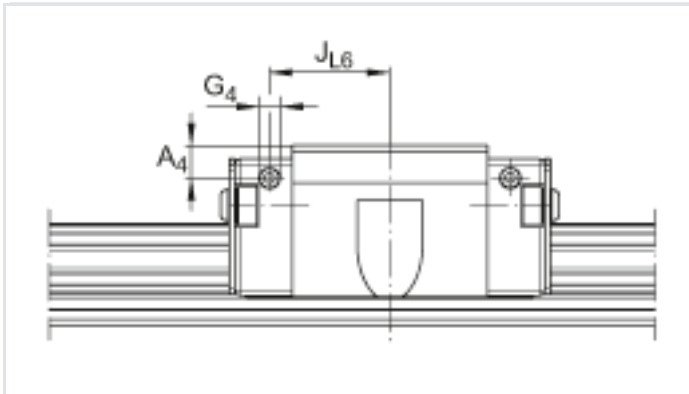

Load directions

Lubrication connector

