



The Timken Company

4500 Mt Pleasant St. NW

N. Canton, OH 44720

Phone: (234) 262-3000

E-Mail: CustomerCAD@timken.com • **Web site:** www.timken.com

Part Number UCP216, UCP 200 Pillow Block Mounted Bearings - Set Screw Locking

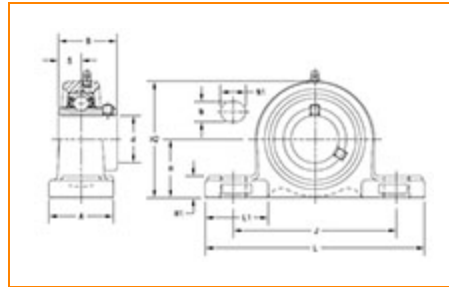

[Specifications](#) | [Dimensions](#) | [Basic Load Ratings](#)

Specifications

| | |
|-----------------------------|-----------------------|
| Bearing Number | UC216 |
| Shaft Size d | 80 mm |
| UPC Code | 087796073425 |
| Locking Style | Set Screw Locking |
| Housing Construction | Two-Bolt Pillow Block |

Dimensions

| | |
|--------------------------------|---------------------|
| Base to Center Height H | 88.9 mm 3.5 in |
| Total Length L | 292 mm 11.496 in |



| | |
|-------------------------------------|-----------------------|
| Housing Width A | 78.000 mm 3.071 in |
| Bolt Hole Spacing J | 232 mm 9.134 in |
| Bolt Hole Size N | 25 mm 0.984 in |
| Bolt Hole Length N1 | 35 mm 1.378 in |
| Foot Height H1 | 30 mm |
| Total Height H2 | 174 mm 6.85 in |
| Dimension L1 | 83 mm 3.281 in |
| Inner Ring Width B | 82.6 mm 3.2520 in |
| Center of Bearing from End S | 33.3 mm 1.311 in |

Basic Load Ratings

| | |
|----------------------------|----------------------|
| Static Load Rating | 53000 N 11915 lbf |
| Dynamic Load Rating | 72700 N 16344 lbf |

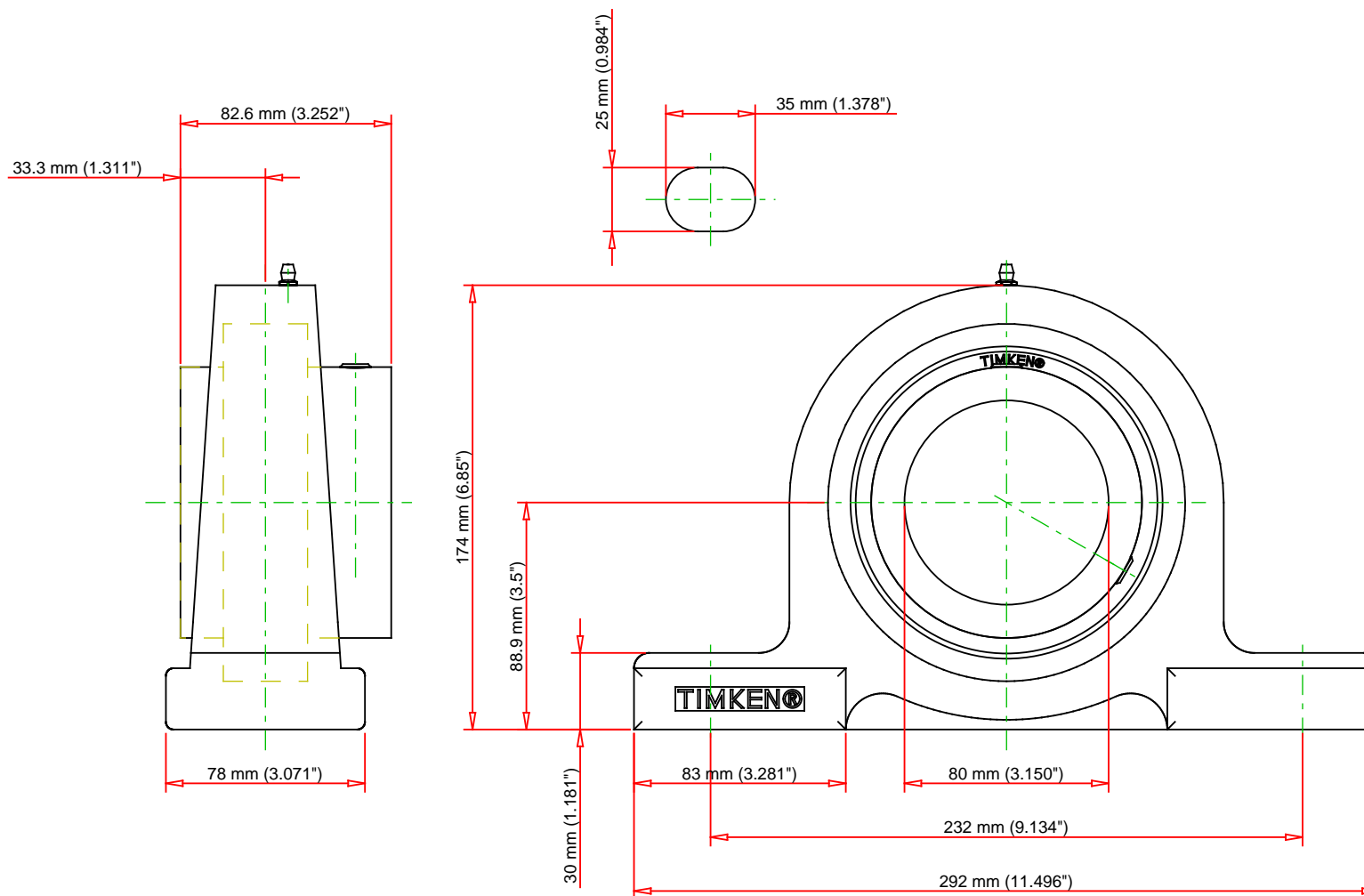

| | | | | |
|--------------------------------|-------|-----|-------|----|
| Bearing Number | UC216 | | | |
| Load Ratings - C _r | 16344 | lbf | 72700 | N |
| Load Ratings - C _{0r} | 11915 | lbf | 53000 | N |
| Weight | 19.8 | lb | 9 | kg |
| Bolt Size | M20 | | | |

TIMKEN®

THE TIMKEN COMPANY
NORTH CANTON, OHIO USA

UCP216

UCP 200 Pillow Block Mounted Bearings -
Set Screw Locking

Every reasonable effort has been made to ensure the accuracy of the information contained in this writing, but no liability is accepted for errors, omissions or for any other reason.

FOR DISCUSSION ONLY