

# Product Data Sheet



Product Code:	Issue No.	Issue Date:	Issue by:
<b>BX4S125</b>	<b>A</b>	07/12/2016	T. Tombs

## Description

4 Way TP mcb distribution board with 125A TP switch disconnecter incomer. Max. mcb – 63A.

## General Characteristics

Standards.	BS EN 61439-1&3
Current rating.	125A - AC22B.
Voltage rating.	400V a.c.
Fault current rating.	10kA Icc.
Enclosure.	1.2mm cold rolled steel with an epoxy paint finish to RAL7035 matt grey.
IP Rating.	IP 3X
Pollution degree.	3
No of poles.	3 + neutral
Incomer terminal capacity.	50mm.sq.
Incomer terminal tightening torque.	2 – 2.5 Nm.
Cable entry facility.	Top & bottom endplates removable for ease of cutting.
Covers / Door.	Side hinged solid door (removable) c/w plastic turn catch.
No of Outgoing TP ways.	4
Equipment type.	Fixed stationary
Weight.	7.14 kg



## Switchgear Fitted

Device	Rating
3 pole switch disconnecter	125A

## General Device Specification – Outgoing Switchgear ordered separately

<b>MCB:</b>	Please refer to Device data sheet for further information. 6 to 63A SP, DP and TP mcb's, type's B, C & D. 6A to 45A single module RCBO's, types B & C. Compact RCBO's, types B & C. Isolator and mcb dolly locks available.
<b>Door:</b>	Clear door option available – add /CD to end of part number i.e. BX...S125/CD

# Product Data Sheet



Product Code:

**BX4S125**

Issue No.

**A**

Issue Date:

07/12/2016

Issue by:

T. Tombs

## Description

4 Way TP mcb distribution board with 125A TP switch disconnecting incomer.

## Key Dimensions

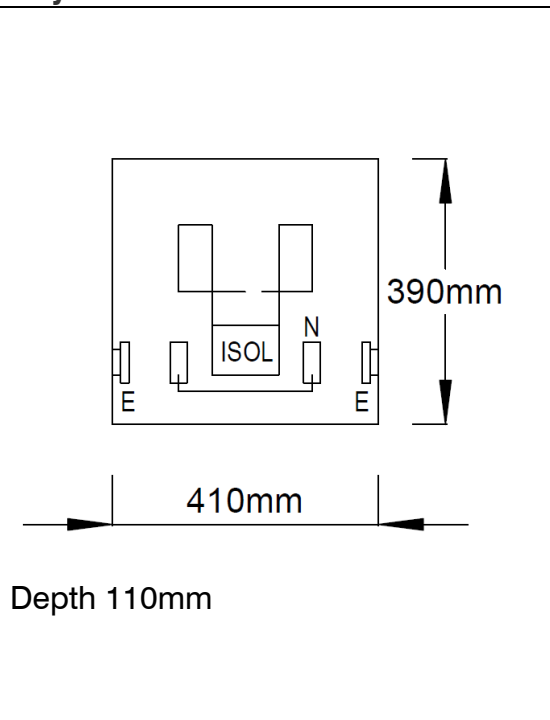

## Mounting hole positions

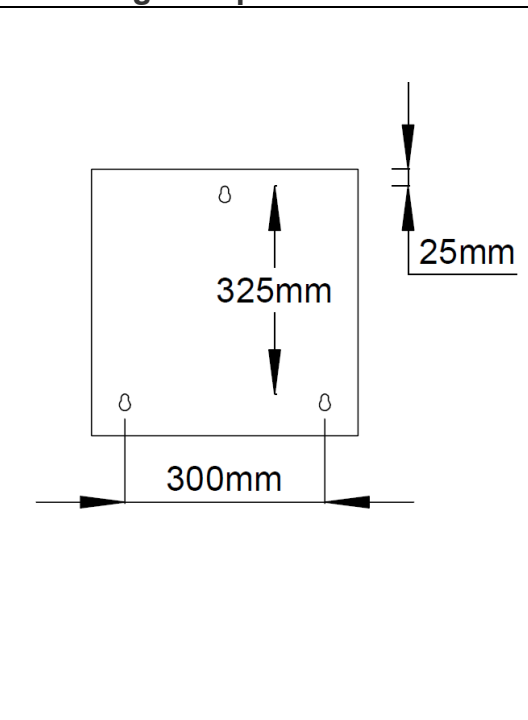

## Fixing foot detail.

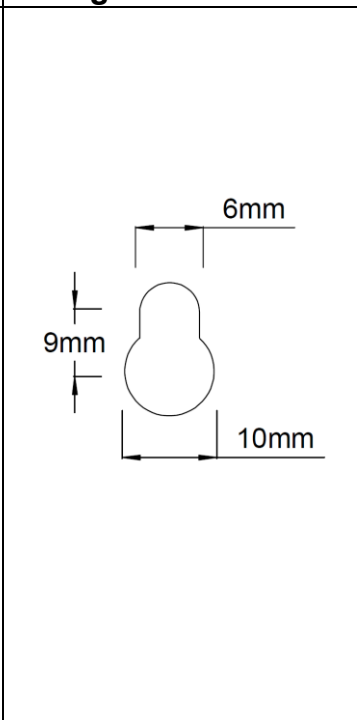

## Additional information.

### Usage

Intended for use by ordinary persons or instructed persons.

### Electrical

Earth & Neutral terminals M10 main bolt, 30Nm. Outgoing terminals: 4x 25mm.sq, others 16mm.sq. Earth & neutral bar both sides of case.

Rated frequency: 50Hz.

Rated operational voltage: 230/400V a.c.

Rated insulation voltage: 690V a.c.

Earthing system: Suitable for use with TN-S, TN-C-S and TT systems.

EMC environment: Environment type A.

### Physical

Ambient operating temperature -5 to 40 °C

(Not exceeding average of 35 °C in any 24 hour period).

Maximum altitude 2000m.

Enclosure: Folded mild steel enclosed assembly. Powder coated in Hard wearing epoxy matt light grey paint to RAL 7035.

### Installation

Service conditions: Wiring of this product must comply with current IEE regulations. Units are intended for indoor use and dry conditions and **NOT** where high levels of humidity and temperature are experienced.

Note: IP rating of enclosures can be compromised if correct use of glands is not followed when installing unit.