



**The Timken Company**

4500 Mt Pleasant St. NW

N. Canton, OH 44720

**Phone:** (234) 262-3000

**E-Mail:** [CustomerCAD@timken.com](mailto:CustomerCAD@timken.com) • **Web site:** [www.timken.com](http://www.timken.com)

## Bearing Unit - Adapter Sleeve UK205 - H2305, UK 200 Wide Inner Ring Ball Bearings - Adapter Sleeve Locking

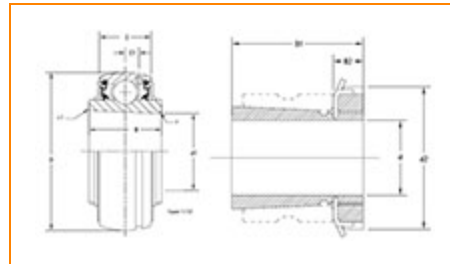

[Specifications](#) | [Dimensions](#) | [Basic Load Ratings](#)

### Specifications

<b>Bore Type</b>	Tapered bore
<b>Shaft Size d</b>	20 mm
<b>Adapter Sleeve Number<sup>1</sup></b>	H2305
<b>Material</b>	Bearing Steel
<b>Locking Style</b>	Adapter Sleeve Locking

### Dimensions

<b>Outside Diameter D</b>	52.000 mm
<b>Inside Ring Width B</b>	24 mm
<b>Outside Ring Width C</b>	17 mm



<b>Radius r</b>	1.1 mm
<b>Groove Position C1</b>	4.5 mm
<b>Dimension B1</b>	35 mm

#### Basic Load Ratings

<b>Static Load Rating</b>	7900 N
<b>Dynamic Load Rating</b>	14000 N

<sup>1</sup> Purchase the Adapter Sleeve separately

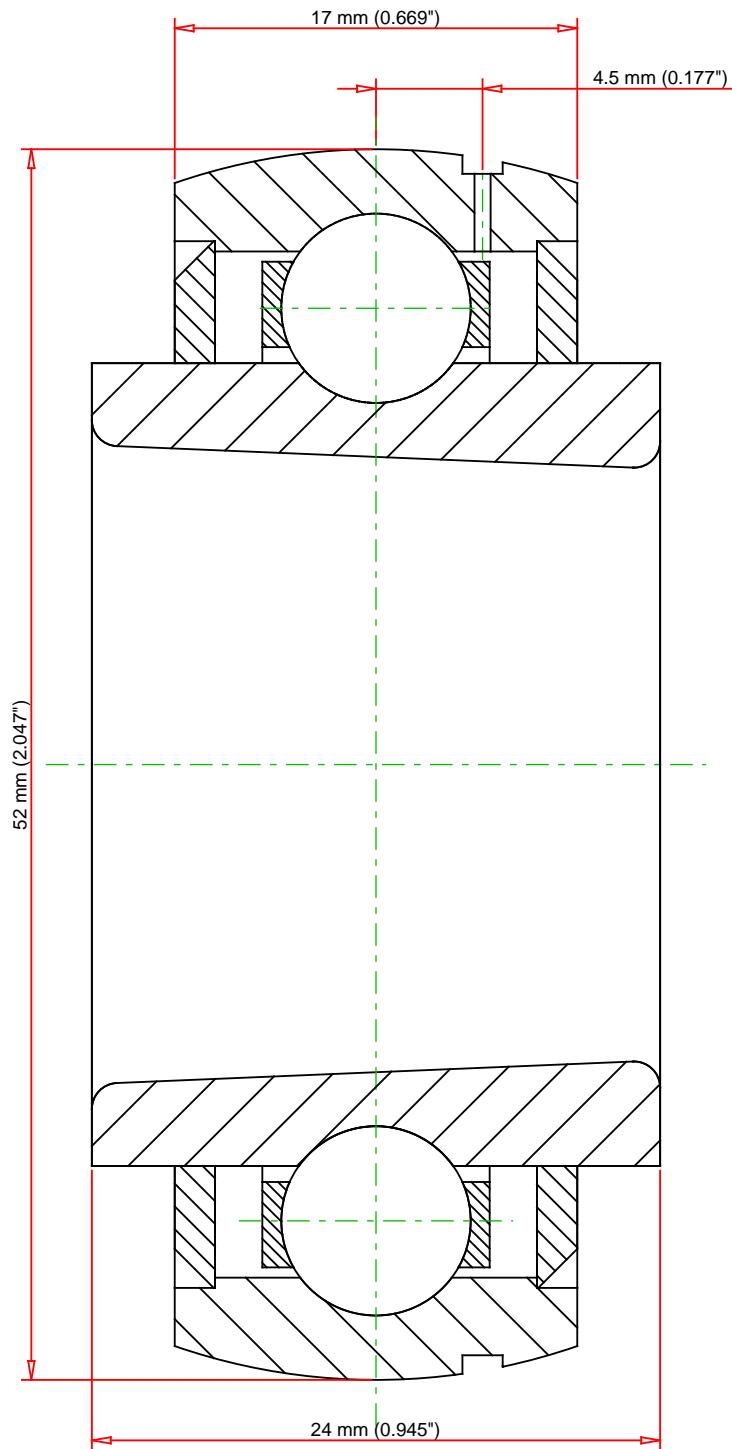

Weight					
	0.4 lb	0.2 kg			
			TIMKEN®		
			THE TIMKEN COMPANY		
			NORTH CANTON, OHIO USA		
			UK205 - H2305		
			UK 200 Wide Inner Ring Ball Bearings - Adapter Sleeve Locking		
			Basic Load Ratings - C <sub>r</sub>	3147 lbf	14000 N
			Load Ratings - C <sub>0r</sub>	1765 lbf	7900 N
Every reasonable effort has been made to ensure the accuracy of the information contained in this writing, but no liability is accepted for errors, omissions or for any other reason.			FOR DISCUSSION ONLY		