



# Cable Management

## Strut Framework System Technical Specification

### Dimensions:

Plain or slotted channel available

All channel 2.5mm thick and 3 metres long

All external brackets 6.0mm thick

Manufactured from continuously hot-dip zinc coated low carbon steels strip and sheet for cold forming to BS EN 10142: 2000

Brackets are designed in compliance with BS6946

Channel brackets post hot dipped galvanised to BS729

**TS21P-3  
TS21S-3**

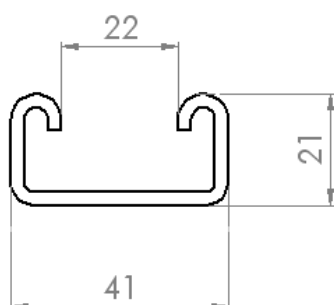

**TS41P-3  
TS41S-3**

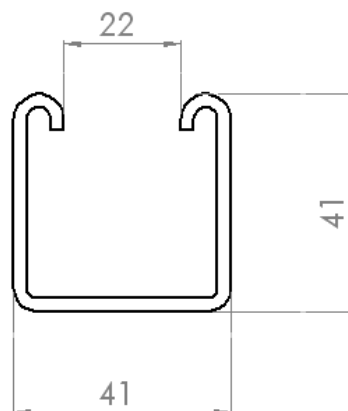

Material: 2.5mm thick cold rolled steel

### Slotted strut hole dimensions

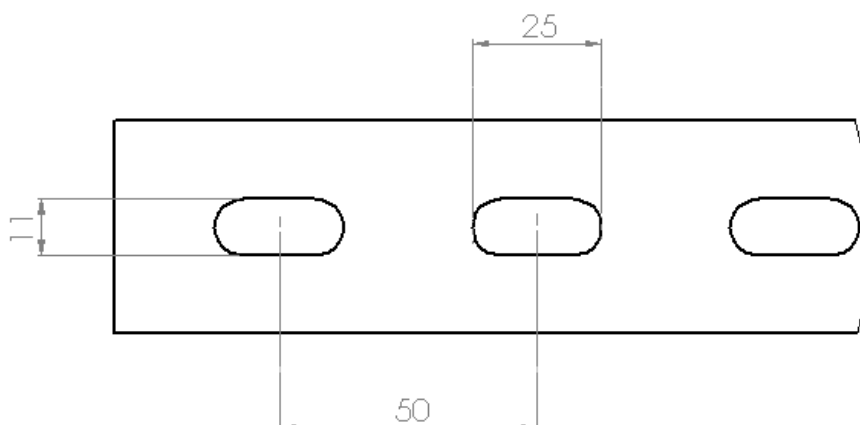

Length: 3.0m