

# Series MGP

## Construction (With Air Cushion)

### Series MGPM

#### MGPM16 to 25

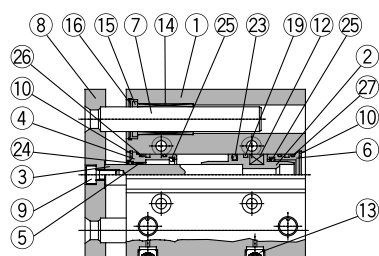

25mm stroke

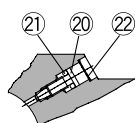

Cushion valve section

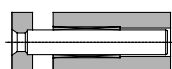

ø16: 25mm stroke

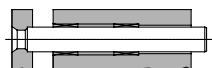

ø16: 50mm stroke or larger



ø20, ø25: 50mm stroke or larger

#### MGPM32 to 100

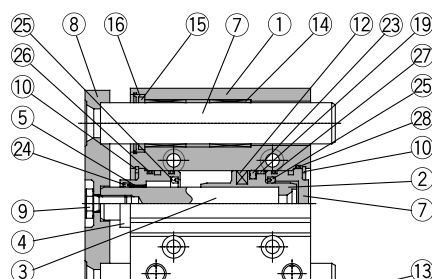

25mm stroke



50mm stroke or larger

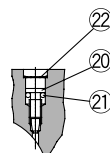

Cushion valve section

### Series MGPL

#### MGPL16 to 25

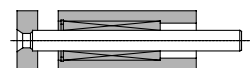
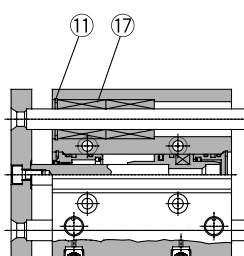

ø20, ø25: 75mm stroke or less

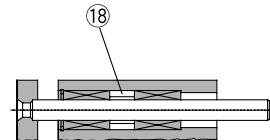

ø20, ø25: 100mm stroke or larger

#### MGPL32 to 100

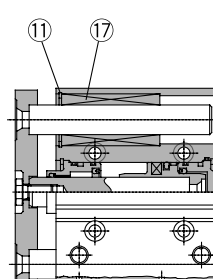

25mm stroke



ø32 to ø63: 50, 75mm stroke  
ø80, ø100: 50mm stroke or larger

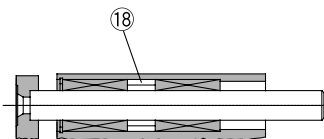

ø32 to ø63: 100mm stroke or larger

### Parts list

No.	Description	Material	Note
1	Body	Aluminum alloy	Hard anodized
2	Piston	Aluminum alloy	Chromated
3	Piston rod	Stainless steel	ø16 to ø25
		Carbon steel	ø32 to ø100 Hard chrome plated
4	Collar	Aluminum alloy	ø16 to ø63 Clear anodized
5	Bushing	Lead bronze casting	ø80, ø100 Coated
6	Head cover	Aluminum alloy	ø16 to ø25 Clear anodized
			ø32 to ø100 Coated
7	Guide rod	Carbon steel	Hard chrome plated
8	Plate	Carbon steel	Nickel plated
9	Plate mounting bolt	Carbon steel	Nickel plated
10	Snap ring	Carbon tool steel	Phosphate coated
11	Snap ring	Carbon tool steel	Phosphate coated
12	Magnet	Synthetic rubber	
13	Plug (M-5P)	Brass	ø16 Nickel plated
	Hexagon socket head taper plug	Carbon steel	ø20 to ø100 Nickel plated
14	Slide bearing	Lead bronze casting	
15	Felt	Felt	
16	Holder	Resin	
17	Ball bushing		

### Parts list

No.	Description	Material	Note
18	Spacer	Aluminum alloy	
19	Wear ring	Resin	
20	Cushion valve	Steel	
21	Gasket	NBR	
22	Snap ring	Carbon tool steel	Except ø16
23*	Piston seal	NBR	
24*	Rod seal	NBR	
25*	Cushion seal	Urethane	
26*	Gasket A	NBR	
27*	Gasket B	NBR	
28*	Gasket C	NBR	

### Replacement parts: Seal kits

Bore size (mm)	Kit no.	Contents	Bore size (mm)	Kit no.	Contents
16	MGP16-A-PS	Kits include items 23, 24, 25, 26, 27, 28 from the table above.	50	MGP50-A-PS	Kits include items 23, 24, 25, 26, 27, 28 from the table above.
20	MGP20-A-PS		63	MGP63-A-PS	
25	MGP25-A-PS		80	MGP80-A-PS	
32	MGP32-A-PS		100	MGP100-A-PS	
40	MGP40-A-PS				

\* Seal kits are sets consisting of items 23 through 28 above, and can be ordered using the kit number for each bore size.