

Air Cylinder: Standard/Non-rotating Type Double Acting, Single/Double Rod

Series C76

ø32, ø40

How to Order

Double acting Single rod

Double acting Double rod

Built-in magnet

Nil	None
D	Built-in magnet

Type

Nil	Standard
K	Non-rotating rod (Rubber cushion only)

Mounting style

Symbol	Mounting
E*	Double end
F**	Front nose
Y**	Front nose in line port

* Double acting, Double rod type: Only double end type. (E)
** Except air cushion type.

Auto switch mounting type

A	Rail mounting
B	Band mounting

Applicable auto switches and bands are shown on pages 6-10-45 to 6-10-46. Please order auto switches and bands separately.

Rod boot

Nil	Without rod boot
J	Nylon tarpaulin one side
K	Heat resistant tarpaulin one side
JJ*	Nylon tarpaulin both sides
KK*	Heat resistant tarpaulin both sides

* In the case of double acting/double rod.

Cushion

Nil	Rubber cushion (Standard)
C	Air cushion (Only "E" execution)

Bore size

Bore size (mm)	Standard stroke (mm)	Max. stroke (mm)
32	10, 25, 40, 50, 80, 100,	1000
40	125, 160, 200, 250, 300	

Mounting Bracket Part No.

Bore size (mm)		32	40
Mounting bracket	Flange, Foot (1 pc.)	C76F32A	C76F40A
	Flange, Foot (2 pcs. with mounting nut 1 pc.)	C76F32B	C76F40B
	Trunnion	C76T32	C76T40
	Clevis	C76C32	C76C40
Accessory	Single knuckle joint	KJ10DA	KJ12DA
	Double knuckle joint	GKM10-20A	GKM12-24A
	Floating joint	JA25-10-150	JA40-12-175

Replacement Parts

Bore size (mm)	Part no.		Note
	Standard	Non-rotating	
32	C76-32PS	C76K-32PS	Every set includes: 1 rod seal 1 seal retaining washer 1 retaining ring
40	C76-40PS	C76K-40PS	

Suitable also C76 series

Example of How to Order

- Cylinder without auto switch, Bore size: 32, Stroke: 100, Double acting/Single rod and Double end type.
C76E32-100 1 pc. Cylinder
- Cylinder without auto switch, Bore size: 32, Stroke: 50, Double acting/Double rod type and Rod and head foot mounting.
C76WE32-50 1 pc. Cylinder
C76F32B 2 pcs. Foot bracket
- Cylinder with auto switch (Band mounted type, 2 pcs.), Bore size: 40, Stroke: 100, Double acting/Single rod, Front nose in line port type and Flange mounting.
CD76Y40-100-B 1 pc. Cylinder
C76F40A 1 pc. Flange mounting
D-C73L 2 pcs. Auto switch
BM2-040 2 pcs. For auto switch mounting band
- Cylinder with auto switch (Rail mounted type, 2 pcs.), Bore size: 40, Stroke: 50, Single acting/Spring return, Front nose type and Trunnion mounting.
CD76F40-50S-A 1 pc. Cylinder
C76T40 1 pc. Trunnion mounting
D-A73L 2 pcs. Auto switch
- Non-rotating: Cylinder without auto switch, Bore size: 32, Stroke: 100, Double acting/Single rod and Double end type.
C76KE32-100 1 pc. Cylinder

Cylinder: Standard/Non-rotating Type Double Acting, Single/Double Rod **Series C76**

Construction

[First angle projection]

Double acting, Single rod C□76□32 to 40 Rubber cushion

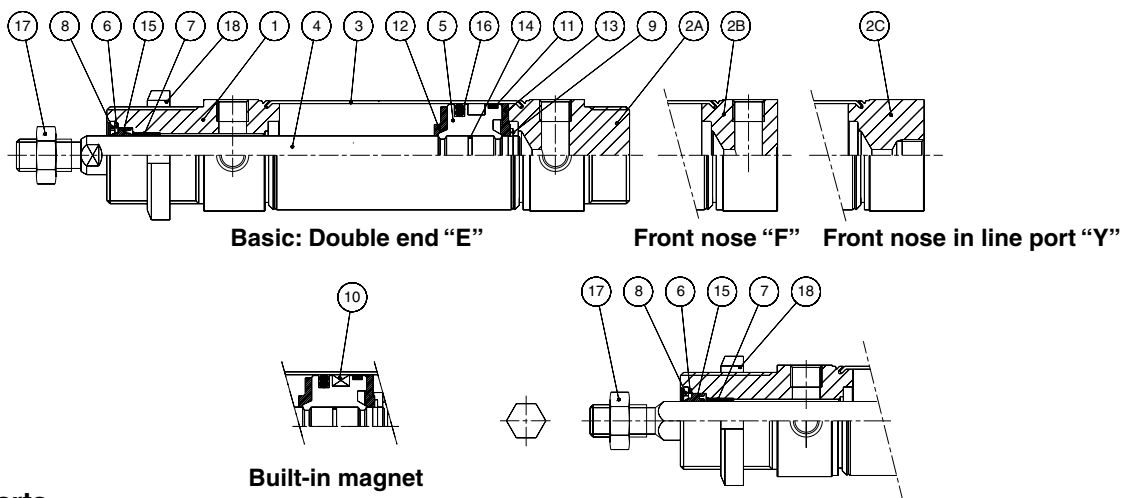

Component Parts

No.	Description	Material	Qty.	Note
①	Rod cover	Aluminum alloy	1	White anodized
2A	Head cover E	Aluminum alloy	1	White anodized
2B	Head cover F	Aluminum alloy	1	White anodized
2C	Head cover Y	Aluminum alloy	1	White anodized
③	Cylinder tube	Stainless steel	1	
④	Piston rod	Carbon steel	1	Hard chrome plated
⑤	Piston	Aluminum alloy	1	Chromate
⑥	Plain washer	Stainless steel	1	
⑦	Bush	Sintered bronze	1	
⑧	Retaining ring	Carbon steel	1	Nickel plating

No.	Description	Material	Qty.	Note
⑨	Retaining ring	Stainless steel	1	
10	Magnet	Magnet	1	(Switch type only)
11	Wear ring	Resin	1	
12	Bumper A	Urethane	1	
13	Bumper B	Urethane	1	
14	Piston gasket	NBR	1	
15	Rod seal	NBR	1	
16	Piston seal	NBR	1	
17	Rod end nut	Carbon steel	1	Nickel plating
18	Mounting nut	Carbon steel	1	Nickel plating

C□76□32 to 40 Air cushion

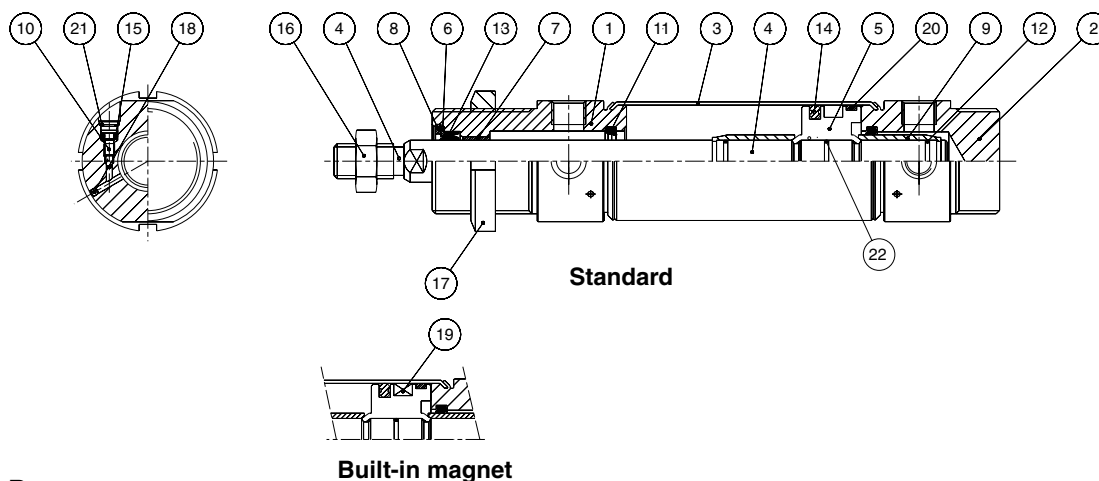

Component Parts

No.	Description	Material	Qty.	Note
①	Rod cover	Aluminum alloy	1	White anodized
②	Head cover E	Aluminum alloy	1	White anodized
③	Cylinder tube	Stainless steel	1	
④	Piston rod	Carbon steel	1	Hard chrome plated
⑤	Piston	Aluminum alloy	1	Chromate
⑥	Plain washer	Stainless steel	1	
⑦	Bush	Sintered bronze	1	
⑧	Retaining ring	Carbon steel	1	Nickel plating
⑨	Cushion ring	Brass	2	
10	Cushion needle	Alloy steel	2	Electroless nickel plating
11	Cushion seal	Urethane	2	

No.	Description	Material	Qty.	Note
12	Cushion ring gasket	NBR	2	
13	Rod seal	NBR	1	
14	Piston seal	NBR	1	
15	Cushion needle seal	NBR	1	
16	Rod end nut	Carbon steel	1	Nickel plating
17	Mounting nut	Carbon steel	1	Nickel plating
18	Steel ball	Stainless steel	2	
19	Magnet	Magnet	1	(Switch type only)
20	Wear ring	Resin	1	
21	Self locking ring	Stainless steel	2	
22	Piston gasket	NBR	1	

CJ1

CJP

CJ2

CM2

CG1

MB

MB1

CA2

CS1

C76

C85

C95

CP95

NCM

NCA

D-

-X

20-

Data