

# Self-Lube® product range

NSK manufactures several ranges of mounted units. These include Self-Lube®, our recognized standard, and recently introduced ranges such as Silver-Lube®, Life-Lube® and Molded-Oil™ units. In each type, there are two basic components, the insert and the housing.

## Self-Lube® bearing inserts

The Self-Lube® bearing insert, commonly known as a wide inner ring bearing, is designed to suit the wide range of housings offered by NSK in the Self-Lube® bearing family and is also suitable for applications where the user's own housing is preferred.

They are basically deep-groove ball bearings, to the popular 6200 series configuration, with integral design features making them more functional and versatile than standard ball bearings. The radial internal clearance is C3 for standard bearing inserts and bearings can be offered with either parallel or spherical outside diameter outer rings with the latter being the type fitted in the bearing unit. The integral design features of the bearing insert, such as shaft locking, sealing and lubrication, are explained in the following pages.

## Self-Lube® bearing units

The range of Self-Lube® bearing units offers a wide choice of cast iron, pressed steel, synthetic rubber, thermoplastic or stainless steel housings fitted with spherical outside diameter Self-Lube® bearing inserts. They will generally accommodate initial housing misalignment up to 0.030 radians but are not recommended for running misalignment in excess of 0.001 radians. The general housing types are pillow blocks, flange units, take-up units, cartridge units and hanger units. Choice is very much

determined by the requirements of the application, although the aesthetic appearance of the machine design is often an important consideration. Self-Lube® units have been designed to meet the needs of both criteria.

- › Cast iron unit castings are made from high-quality cast iron, and finished on unmachined surfaces with an electrostatic air-drying paint.
- › Pressed steel housings are made from mild steel strip, and are zinc plated.
- › Thermoplastic housings are moulded in highgrade PBT, a high quality thermoplastic polyester resin.
- › Stainless steel housings are made from austenitic stainless steel castings (SCS13).

## Additional products

NSK recognizes the need for 'tailor made' solutions and is always willing to help customers who have a requirement for something out of the ordinary.

## Dynamic load ratings

The NSK dynamic load ratings given in this catalog and the relationship between these and bearing fatigue life are based on ISO standard 281.

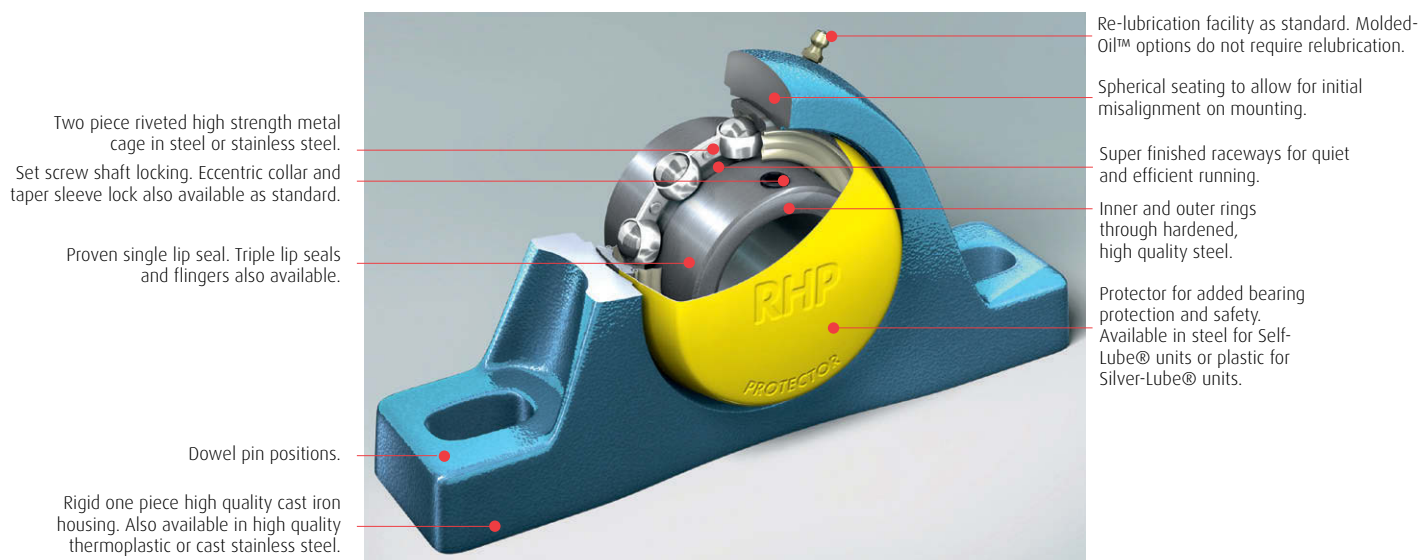

# Self-Lube<sup>®</sup> bearing inserts

## 1000G and 1100 Series

### 1000G

With spherical outside diameter and integral set screw lock

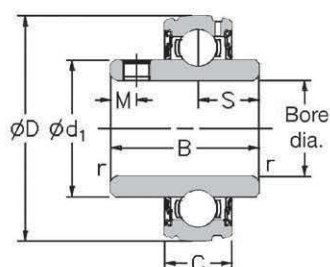

### 1100

With parallel outside diameter and integral set screw lock

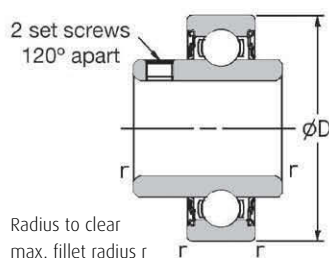

Shaft diameter		RHP designation		Dimensions (mm)							ISO Load ratings		Rec. max. speed	Mass (approx.)
mm	inches	1000G Series	1100 Series	D	C	B	s	d1	M	r	dynamic Cr newtons	static Cor newtons	rev/min	kg
12		1017-12G	1117-12	40.000	12.00	27.38	11.58	24.80	5.00	0.60	9550	4800	7000	0.09
15		1017-15G	1117-15											
16		1017-16G	1117-16											
17		1017-17G	1117-17											
	½	1017-½G	1117-½											
	⅝	1017-⅝G	1117-⅝											
20		1020-20G	1120-20	47.000	14.00	31.00	12.73	28.30	5.00	1.00	12800	6650	6700	0.13
	¾	1020-¾G	1120-¾											
25		1025-25G	1125-25	52.000	15.00	34.10	14.33	34.00	5.00	1.00	14000	7880	6250	0.17
	⅞	1025-⅞G	1125-⅞											
	1⅕	1025-1⅕G	1125-1⅕											
	1	1025-1G	1125-1											
25		1030-25G	1130-25	62.000	16.00	38.10	15.93	40.30	5.00	1.00	19500	11300	5300	0.37
30		1030-30G	1130-30											
	1	1030-1G	1130-1											
	1⅛	1030-1⅛G	1130-1⅛											
	1⅜	1030-1⅜G	1130-1⅜											
	1¼	1030-1¼G	1130-1¼											
30		1035-30G	1135-30	72.000	17.00	42.90	17.53	46.90	6.50	1.00	25700	15300	4500	0.51
35		1035-35G	1135-35											
	1⅜	1035-1⅜G	1135-1⅜											
	1½	1035-1½G	1135-1½											
	1⅕	1035-1⅕G	1135-1⅕											
	1⅜	1035-1⅜G	1135-1⅜											
	1⅞	1035-1⅞G	1135-1⅞											
35		1040-35G	1140-35	80.000	18.00	49.20	19.03	52.40	8.00	1.00	32500	19900	4000	0.64
40		1040-40G	1140-40											
	1⅜	1040-1⅜G	1140-1⅜											
	1⅞	1040-1⅞G	1140-1⅞											
	1½	1040-1½G	1140-1½											
40		1045-40G	1145-40	85.000	19.00	49.20	19.04	57.40	8.00	1.00	32500	20500	3700	0.73
45		1045-45G	1145-45											
	1½	1045-1½G	1145-1½											
	1⅝	1045-1⅝G	1145-1⅝											
	1⅞	1045-1⅞G	1145-1⅞											
	1⅞	1045-1⅞G	1145-1⅞											
	1⅞	1045-1⅞G	1145-1⅞											
	1⅞	1045-1⅞G	1145-1⅞											
45		1050-45G	1150-45	90.000	20.00	51.60	19.04	62.40	10.00	1.00	35000	23200	3400	0.91
50		1050-50G	1150-50											
	1⅞	1050-1⅞G	1150-1⅞											
	1⅞	1050-1⅞G	1150-1⅞											
	1⅞	1050-1⅞G	1150-1⅞											
	1⅞	1050-1⅞G	1150-1⅞											
	1⅞	1050-1⅞G	1150-1⅞											
	1⅞	1050-1⅞G	1150-1⅞											
	1⅞	1050-1⅞G	1150-1⅞											
	1⅞	1050-1⅞G	1150-1⅞											
	1⅞	1050-1⅞G	1150-1⅞											
	1⅞	1050-1⅞G	1150-1⅞											
	1⅞	1050-1⅞G	1150-1⅞											
	1⅞	1050-1⅞G	1150-1⅞											
	1⅞	1050-1⅞G	1150-1⅞											
	1⅞	1050-1⅞G	1150-1⅞											
	1⅞	1050-1⅞G	1150-1⅞											
	1⅞	1050-1⅞G	1150-1⅞											
	1⅞	1050-1⅞G	1150-1⅞											
	1⅞	1050-1⅞G	1150-1⅞											
	1⅞	1050-1⅞G	1150-1⅞											
	1⅞	1050-1⅞G	1150-1⅞											
	1⅞	1050-1⅞G	1150-1⅞											
	1⅞	1050-1⅞G	1150-1⅞											
	1⅞	1050-1⅞G	1150-1⅞											
	1⅞	1050-1⅞G	1150-1⅞											
	1⅞	1050-1⅞G	1150-1⅞											
	1⅞	1050-1⅞G	1150-1⅞											
	1⅞	1050-1⅞G	1150-1⅞											
	1⅞	1050-1⅞G	1150-1⅞											
	1⅞	1050-1⅞G	1150-1⅞											
	1⅞	1050-1⅞G	1150-1⅞											
	1⅞	1050-1⅞G	1150-1⅞											
	1⅞	1050-1⅞G	1150-1⅞											
	1⅞	1050-1⅞G	1150-1⅞											
	1⅞	1050-1⅞G	1150-1⅞											
	1⅞	1050-1⅞G	1150-1⅞											
	1⅞	1050-1⅞G	1150-1⅞											
	1⅞	1050-1⅞G	1150-1⅞											
	1⅞	1050-1⅞G	1150-1⅞											
	1⅞	1050-1⅞G	1150-1⅞											
	1⅞	1050-1⅞G	1150-1⅞											
	1⅞	1050-1⅞G	1150-1⅞											
	1⅞	1050-1⅞G	1150-1⅞											
	1⅞	1050-1⅞G	1150-1⅞											
	1⅞	1050-1⅞G	1150-1⅞											
	1⅞	1050-1⅞G	1150-1⅞											
	1⅞	1050-1⅞G	1150-1⅞											
	1⅞	1050-1⅞G	1150-1⅞											
	1⅞	1050-1⅞G	1150-1⅞											
	1⅞	1050-1⅞G	1150-1⅞											
	1⅞	1050-1⅞G	1150-1⅞											
	1⅞	1050-1⅞G	1150-1⅞											

Please check availability