



9565AB

**1" Square Drive to 3/4" Socket
Decreasing Adaptors with Matte
Finish**



PRODUCT DETAILS



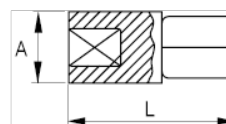

- Matte finish
- High-performance alloy steel
- Suitable for 1" square drive and 3/4" sockets
- Standards: ISO 1174/3316, DIN 3120/3123 and UNE 16503



Follow the Fish!



PRODUCT ATTRIBUTES

Product				A	
9565AB	1 "	3/4 "	67 mm	48 mm	420 g

