



**The Timken Company**

4500 Mt Pleasant St. NW

N. Canton, OH 44720

**Phone:** (234) 262-3000

**E-Mail:** [CustomerCAD@timken.com](mailto:CustomerCAD@timken.com) • **Web site:** [www.timken.com](http://www.timken.com)

## Part Number UCFL217, UCFL 200 Two-Bolt Flanged Mounted Bearings - Set Screw Locking

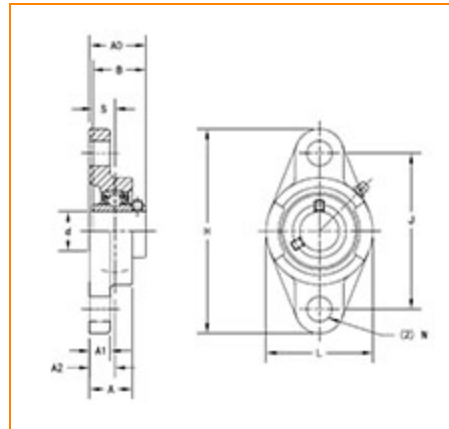

[Specifications](#) | [Dimensions](#) | [Basic Load Ratings](#)

### Specifications

|                             |                   |
|-----------------------------|-------------------|
| <b>Bearing Number</b>       | UC217             |
| <b>Shaft Size d</b>         | 85 mm             |
| <b>UPC Code</b>             | 087796141032      |
| <b>Locking Style</b>        | Set Screw Locking |
| <b>Housing Construction</b> | Two-Bolt Flange   |

### Dimensions

|                            |        |
|----------------------------|--------|
| <b>Total Length H</b>      | 305 mm |
| <b>Total Height L</b>      | 190 mm |
| <b>Housing Width A</b>     | 63 mm  |
| <b>Bolt Hole Spacing J</b> | 248 mm |



|  |         |
|--|---------|
| <b>Bolt Hole Size N</b>                      | 25 mm   |
| <b>Flange Thickness A1</b>                   | 22 mm   |
| <b>Center of Bearing from Housing End A2</b> | 36 mm   |
| <b>Inner Ring Width B</b>                    | 85.7 mm |
| <b>Center of Bearing from Bearing End S</b>  | 34.1 mm |
| <b>Dimension A0</b>                          | 87.6 mm |
| <b>Bolt Size</b>                             | M22     |

## Basic Load Ratings

|                            |         |
|----------------------------|---------|
| <b>Static Load Rating</b>  | 61900 N |
| <b>Dynamic Load Rating</b> | 84000 N |

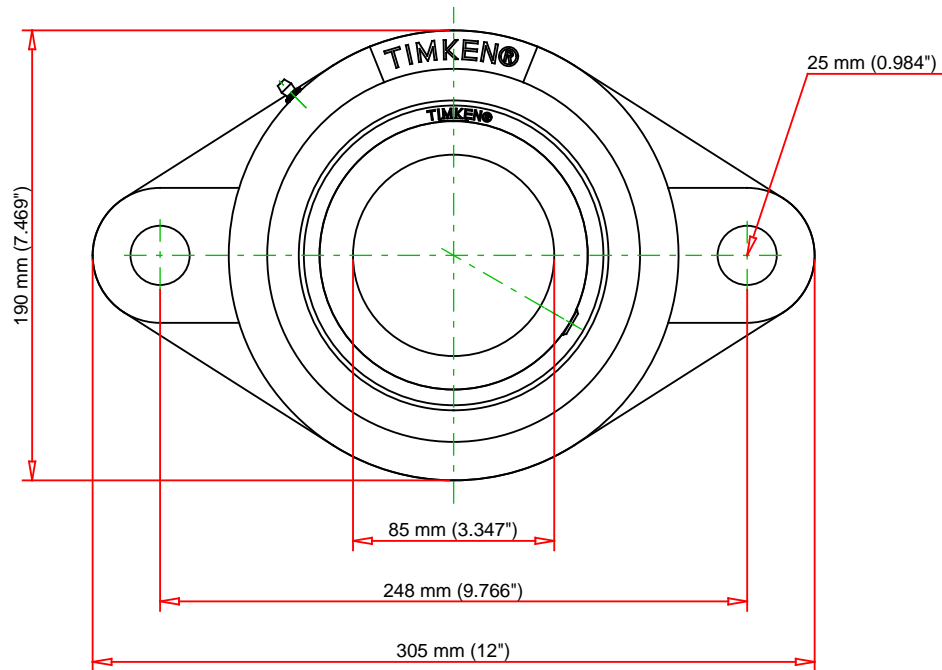
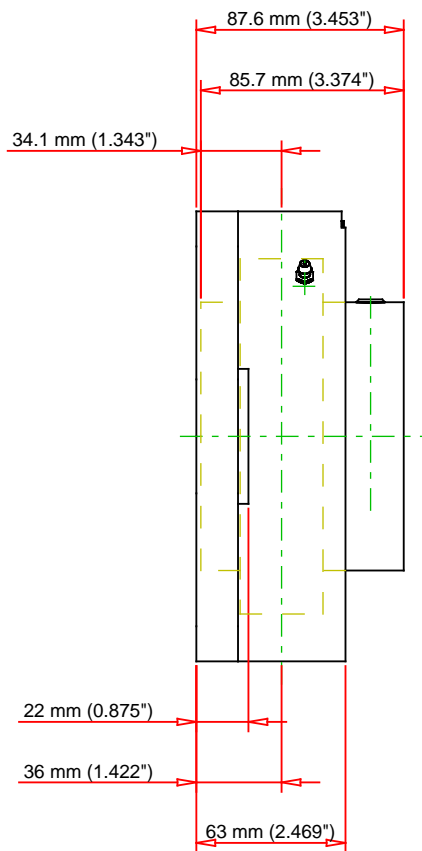

|                                |       |     |       |    |
|--------------------------------|-------|-----|-------|----|
| Bearing Number                 | UC217 |     |       |    |
| Load Ratings - C <sub>r</sub>  | 18884 | lbf | 84000 | N  |
| Load Ratings - C <sub>0r</sub> | 13916 | lbf | 61900 | N  |
| Weight                         | 21.6  | lb  | 9.8   | kg |
| Bolt Size                      | M22   |     |       |    |

**TIMKEN®**

THE TIMKEN COMPANY  
NORTH CANTON, OHIO USA

**UCFL217**  
UCFL 200 Two-Bolt Flanged Mounted  
Bearings - Set Screw Locking

Every reasonable effort has been made to ensure the accuracy of the information contained in this writing, but no liability is accepted for errors, omissions or for any other reason.

**FOR DISCUSSION ONLY**