



The Timken Company

4500 Mt Pleasant St. NW

N. Canton, OH 44720

Phone: (234) 262-3000

E-Mail: CustomerCAD@timken.com • **Web site:** www.timken.com

Part Number UCT324, UCT 300 Take-Up Mounted Bearings - Set Screw Locking

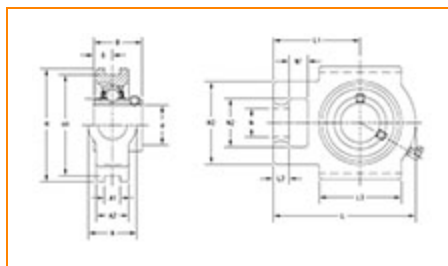

[Specifications](#) | [Dimensions](#) | [Basic Load Ratings](#)

Specifications

Bearing Number	UC324
Shaft Size d	120 mm
Locking Style	Set Screw Locking
Housing Construction	Take-Up

Dimensions

Housing Width A	140 mm 5.512 in
Slot Width A1	45 mm 1.772 in
Slot Width A2	90 mm 3.543 in



Total Height H	355 mm 13.976 in
Pitch Height H1	320 mm
Height H2	210 mm
Total Length L	432 mm 17.008 in
Shaft Length L1	267 mm 10.512 in
Dimension L2	42 mm
Slot Length L3	230 mm 9.055 in
Adjustment Screw Bore N	70 mm 2.756 in
Opening Width N1	60 mm 2.362 in
Opening Height N2	140 mm 5.512 in
Inner Ring Width B	126 mm 4.961 in
Center of Bearing from End S	51 mm 2.008 in
Grease Nipple Size	B-R1/8

Basic Load Ratings

Static Load Rating	185000 N 41590 lbf
Dynamic Load Rating	207000 N 46536 lbf

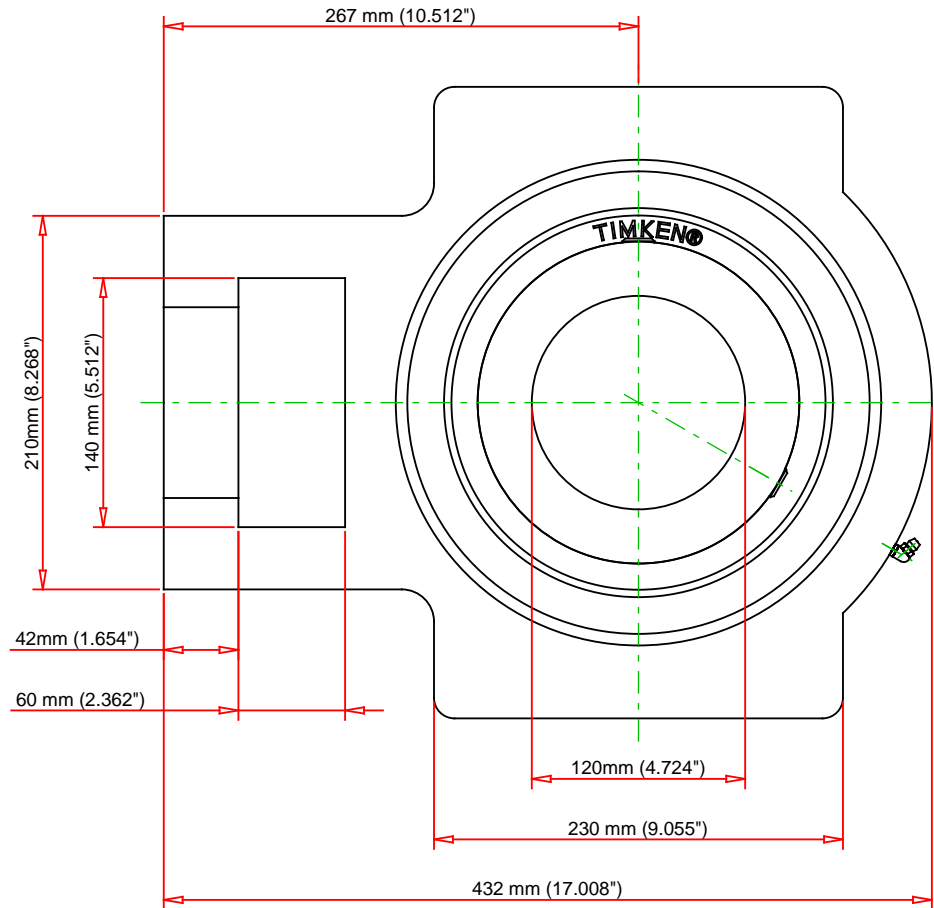

UCT324

UCT 300 Take-Up Mounted Bearings - Set
Screw Locking

FOR DISCUSSION ONLY