

Series CQ2W

Additional Weight

(kg)

Bore size (mm)		125	140	160, 180, 200
Rod end male thread	Male thread	0.62	0.62	0.96
	Nut	0.32	0.32	0.52

Calculation: (Example) CDQ2WB125-30DCM

• Cylinder weight: CDQ2WB125-30DC.....6.40 kg

• Option weight: Rod end male thread.....0.94 kg

7.34 kg

Add the weight of auto switches and mounting brackets.

Auto Switch Mounting Bracket Weight

Mounting bracket part no.	Applicable bore size (mm)	Weight (g)
BQ-2	125 to 160	1.5

For auto switch weight, refer to page 7-9-1.

Construction

Double acting, Double rod

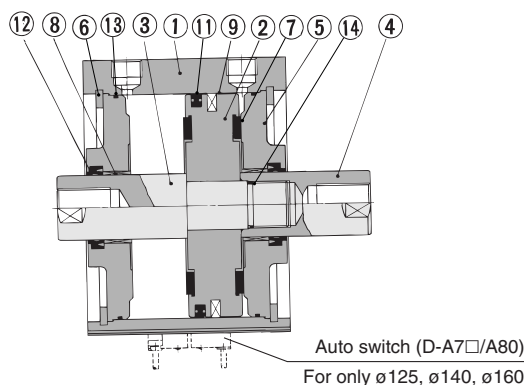

Rod end male thread

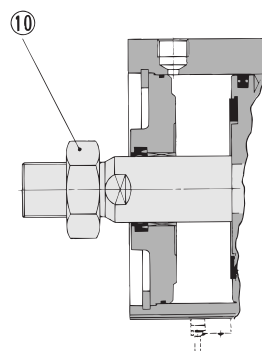

Component Parts

No.	Description	Material	Note
①	Cylinder tube	Aluminum alloy	Hard anodized
②	Piston	Aluminum alloy	Chromated
③	Piston rod A	Carbon steel	Hard chrome plated
④	Piston rod B	Carbon steel	Hard chrome plated
⑤	Rod cover	Cast iron	Nickel plated
⑥	Snap ring	Carbon tool steel	Phosphate coated
⑦	Bumper	Resin	
⑧	Bushing	Lead-bronze casted	For only CDQ2B□
⑨	Magnet	—	Nickel plated
⑩	Rod end nut	Carbon steel	
⑪	Piston seal	NBR	
⑫	Rod seal	NBR	
⑬	Tube gasket	NBR	
⑭	Piston gasket	NBR	

Replacement Parts: Seal Kit

Bore size (mm)	Kit no.	Contents
125	CQ2WB125-PS	Set of left nos. ⑪, ⑫, ⑬
140	CQ2WB140-PS	
160	CQ2WB160-PS	
180	CQ2WB180-PS	
200	CQ2WB200-PS	

* Seal kit includes ⑪, ⑫, ⑬. Order the seal kit, based on each bore size.

Auto switch mounting bracket: Part number and the proper auto switch mounting position and its mounting height are common as CQ2 series, large bore, double acting, single rod. For details, refer to page 7-6-111 and 114.

Rod End Nut

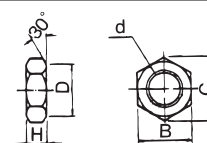

Material: Carbon steel

Part no.	Applicable bore size (mm)	d	H	B	C	D
NT-12	125, 140	M30 x 1.5	18	46	53.1	44
NT-16	160, 180, 200	M36 x 1.5	21	55	63.5	53