



The Timken Company

4500 Mt Pleasant St. NW

N. Canton, OH 44720

Phone: (234) 262-3000

E-Mail: CustomerCAD@timken.com • **Web site:** www.timken.com

Part Number UCFL215, UCFL 200 Two-Bolt Flanged Mounted Bearings - Set Screw Locking

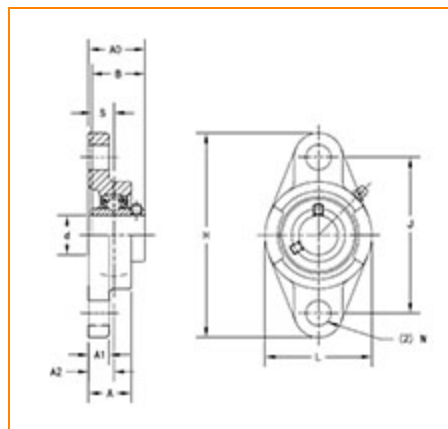

[Specifications](#) | [Dimensions](#) | [Basic Load Ratings](#)

Specifications

Bearing Number	UC215
Shaft Size d	75 mm
UPC Code	087796140073
Locking Style	Set Screw Locking
Housing Construction	Two-Bolt Flange

Dimensions

Total Length H	275 mm
Total Height L	165 mm
Housing Width A	56 mm
Bolt Hole Spacing J	225 mm



Bolt Hole Size N	23 mm
Flange Thickness A1	20 mm
Center of Bearing from Housing End A2	34 mm
Inner Ring Width B	77.8 mm
Center of Bearing from Bearing End S	33.3 mm
Dimension A0	78.5 mm
Bolt Size	M20

Basic Load Ratings

Static Load Rating	48300 N
Dynamic Load Rating	67400 N

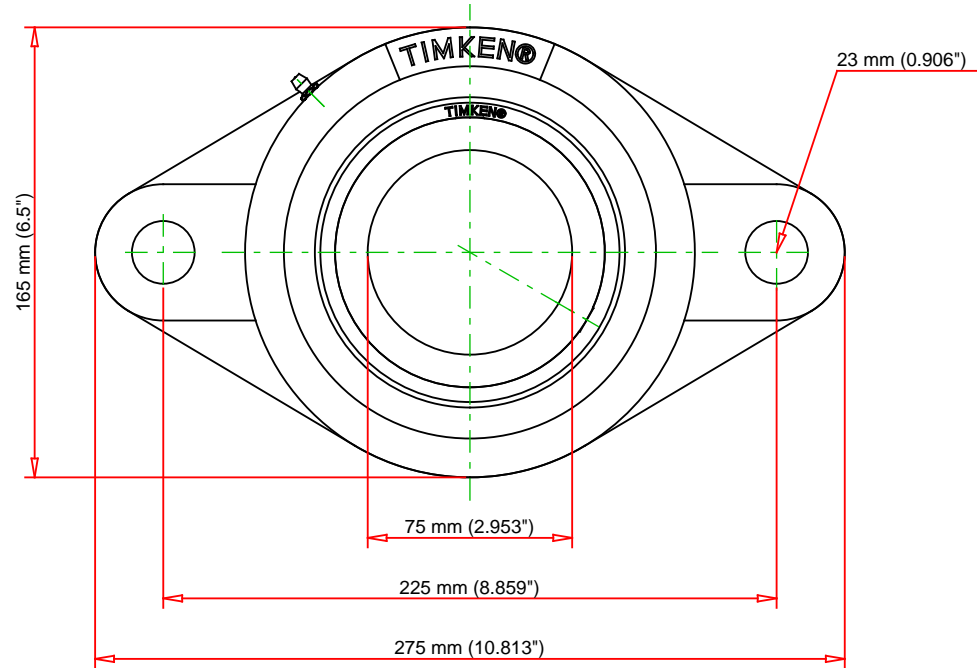
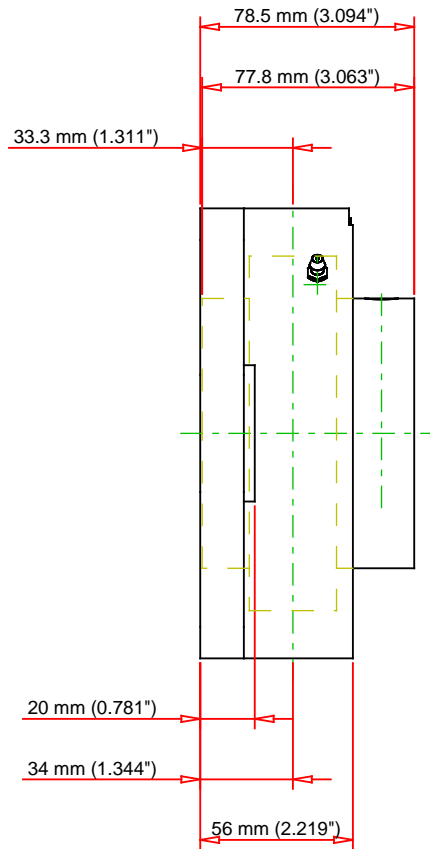

Bearing Number	UC215			
Load Ratings - C _r	15152	lbf	67400	N
Load Ratings - C _{0r}	10858	lbf	48300	N
Weight	14.1	lb	6.4	kg
Bolt Size	M20			

TIMKEN

THE TIMKEN COMPANY
NORTH CANTON, OHIO USA

UCFL215

UCFL 200 Two-Bolt Flanged Mounted
Bearings - Set Screw Locking

Every reasonable effort has been made to ensure the accuracy of the information contained in this writing, but no liability is accepted for errors, omissions or for any other reason.

FOR DISCUSSION ONLY