

# Stainless One-touch Fittings

## Series KG

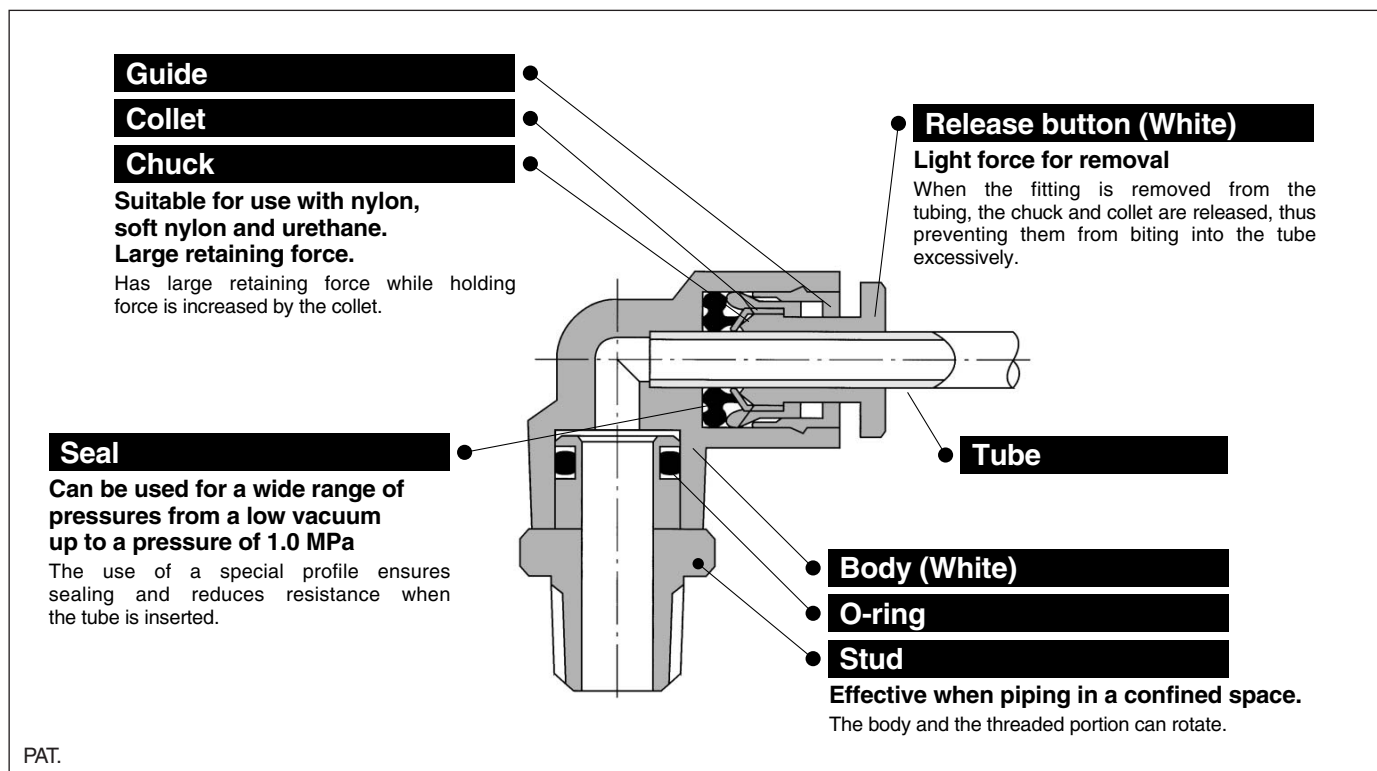

**Stainless specifications applicable to corrosive environments**

**Stainless steel 303 adopted for metal elements**

**Suitable for use in CRT production lines where contact with copper must be avoided, food processing machines where water or salt water splashes and clean room where discoloration of copper material and corrosion must be avoided.**



### Applicable Tubing

Tubing material	Nylon, Soft nylon, Polyurethane
Tubing O.D.	ø4, ø6, ø8, ø10, ø12, ø16

### Specifications

Fluid	Air/Water <sup>(1)</sup>	
Maximum operating pressure	1.0 MPa	
Operating vacuum pressure	-100 kPa	
Proof pressure	3.0 MPa	
Ambient and fluid temperature	-5 to 60°C (Water: 0 to 40°C) (No freezing)	
Thread	Mounting section	JIS B 0203 (Taper thread for piping)
	Nut section	JIS B 0211 Class 2 (Metric fine thread)
Seal (Thread portion)	With seal or none <sup>(2)</sup>	

Note 1) Applicable for general industrial water. Please consult with SMC if using for other kinds of fluid.  
Also, the surge pressure must be under the maximum operating pressure.

Note 2) Suffix "S" to the part number, if w/ seal is desired.

### Principal Parts Material

Body	Stainless steel 303, PBT
Stud	Stainless steel 303
Chuck	Stainless steel 304
Guide	Stainless steel 304, Stainless steel 303, POM
Collet, Release button	POM
Seal, O-ring	NBR

# Series KG



## Extended Male Elbow: KGW

<M5>

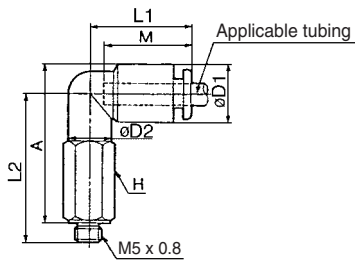

<R>

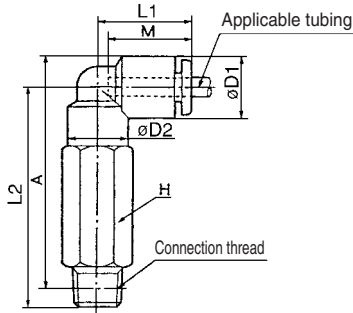

Applicable tubing O.D. (mm)	Connection thread R	Model	H (width across flats)	Note) øD1	øD2	L1	L2	A*	M	Effective area (mm²)		Weight (g)
										Nylon	Urethane	
4	M5 x 0.8	KGW04-M5	8	10.4	8	18	30	32	16	3.0	3.0	11
	1/8	KGW04-01	10		10		37.5	38.5		4.0	4.0	23
	1/4	KGW04-02	14				43.5	42.5		4.0	4.0	38
6	M5 x 0.8	KGW06-M5	8	12.8	8	20	30.5	33.5	17	3.0	3.0	11
	1/8	KGW06-01	10		10		40	42.5		10.9	8.6	26
	1/4	KGW06-02	14				46	46.5				41
	3/8	KGW06-03	17				48	48				67
8	1/8	KGW08-01	12	15.2	12	23	43.5	47	18.5	20.5	14.2	30
	1/4	KGW08-02	14				49.5	51				47
	3/8	KGW08-03	17				51.5	52.5				74
10	1/4	KGW10-02	17	18.5	17	26.5	56.5	59.5	21	33.5	23.8	66
	3/8	KGW10-03	17				58.5	61				76
	1/2	KGW10-04	22				65	66				145
12	1/4	KGW12-02	17	20.9	17	28.5	57.5	62	22	47.7	37.7	68
	3/8	KGW12-03	17				59.5	63.5				78
	1/2	KGW12-04	22				66	68.5				147



\* Reference dimensions after R thread installation.  
Note) øD1: Max. diameter



## Male Branch Tee: KGT

<M5>

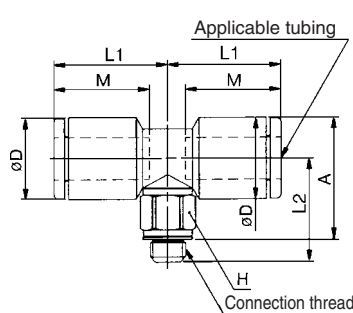

<R>

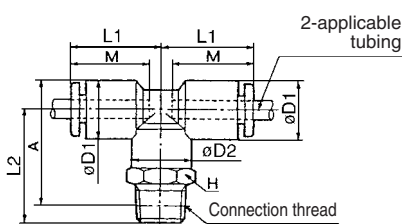

Applicable tubing O.D. (mm)	Connection thread R	Model	H (width across flats)	Note 1) øD1	øD2	L1	L2	A*	M	Effective area (2) (mm <sup>2</sup> )		Weight (g)
										Nylon	Urethane	
4	M5 x 0.8	KGT04-M5	7	9.5	—	15.5	14	15.5	13	4.3	4.3	3.5
	1/8	KGT04-01	10	10.4	10	18	22	23	16	6.0	4.1	13
	1/4	KGT04-02	14				26	25		6.0	4.1	19
6	M5 x 0.8	KGT06-M5	7	11.5	—	16	15	17.5	14	4.3	4.3	4.2
	1/8	KGT06-01	10	12.8	10	20	23	25.5	17	13.9	11.0	12
	1/4	KGT06-02	14				27	27.5		13.9	11.0	20
	3/8	KGT06-03	17				29	29		13.9	11.0	34
8	1/8	KGT08-01	12	15.2	12	23	24.5	28	18.5	26.3	18.2	14
	1/4	KGT08-02	14				28.5	30		26.3	18.2	22
	3/8	KGT08-03	17				30.5	31.5		26.3	18.2	36
10	1/8	KGT10-01	17	18.5	17	26.5	27	32	21	40.8	29.0	31
	1/4	KGT10-02	17				30	33		40.8	29.0	29
	3/8	KGT10-03	17				32	34.5		40.8	29.0	39
	1/2	KGT10-04	22				36	37		40.8	29.0	66
12	1/4	KGT12-02	17	20.9	17	28.5	31	35.5	22	57.2	45.2	31
	3/8	KGT12-03	17				33	37		57.2	45.2	41
	1/2	KGT12-04	22				37	39.5		57.2	45.2	68
16	3/8	KGT16-03	22	26.5	20.9	34	38	44.5	25	71	(71)	112
	1/2	KGT16-04	22				40.5	46		100	(100)	116



\* Reference dimensions after R thread installation.  
Note 1) øD1: Max. diameter  
Note 2) ( ): Values for soft nylon



## Union Tee: KGT

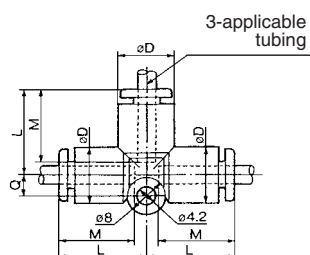

Applicable tubing O.D. (mm)	Model	øD (1)	L	Q	M	Effective area (2) (mm <sup>2</sup> )		Weight (g)
						Nylon	Urethane	
4	KGT04-00	10.4	18	4.5	16	6.4	4.4	7
6	KGT06-00	12.8	20	5.3	17	13.4	10.6	10
8	KGT08-00	15.2	23	6	18.5	25.6	17.7	15
10	KGT10-00	18.5	26.5	6.8	21	40	28.4	25
12	KGT12-00	20.9	28.5	7.5	22	57.4	45.4	29
16	KGT16-00	26.5	34	10	25	100	(84)	40



Note 1) øD: Max. diameter  
Note 2) ( ): Values for nylon.