



The Timken Company

4500 Mt Pleasant St. NW

N. Canton, OH 44720

Phone: (234) 262-3000

E-Mail: CustomerCAD@timken.com • **Web site:** www.timken.com

Part Number UCFL212, UCFL 200 Two-Bolt Flanged Mounted Bearings - Set Screw Locking

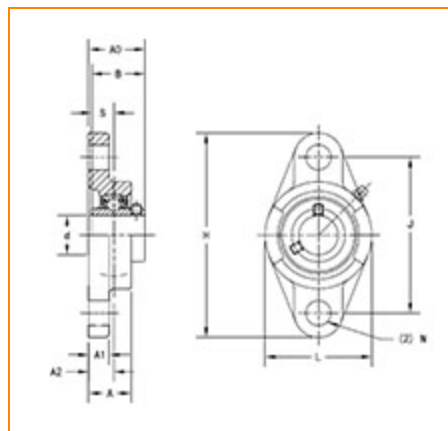

[Specifications](#) | [Dimensions](#) | [Basic Load Ratings](#)

Specifications

Bearing Number	UC212
Shaft Size d	60 mm
UPC Code	087796076006
Locking Style	Set Screw Locking
Housing Construction	Two-Bolt Flange

Dimensions

Total Length H	250 mm 9.843 in
Total Height L	140 mm 5.512 in



Housing Width A	48 mm 1.89 in
Bolt Hole Spacing J	202 mm 7.953 in
Bolt Hole Size N	23 mm 0.906 in
Flange Thickness A1	18 mm 0.709 in
Center of Bearing from Housing End A2	29 mm 1.142 in
Inner Ring Width B	65.1 mm 2.563 in
Center of Bearing from Bearing End S	25.4 mm 1 in
Dimension A0	68.7 mm 2.703 in
Bolt Size	M20

Basic Load Ratings

Static Load Rating	36200 N 8138 lbf
Dynamic Load Rating	52400 N 11780 lbf

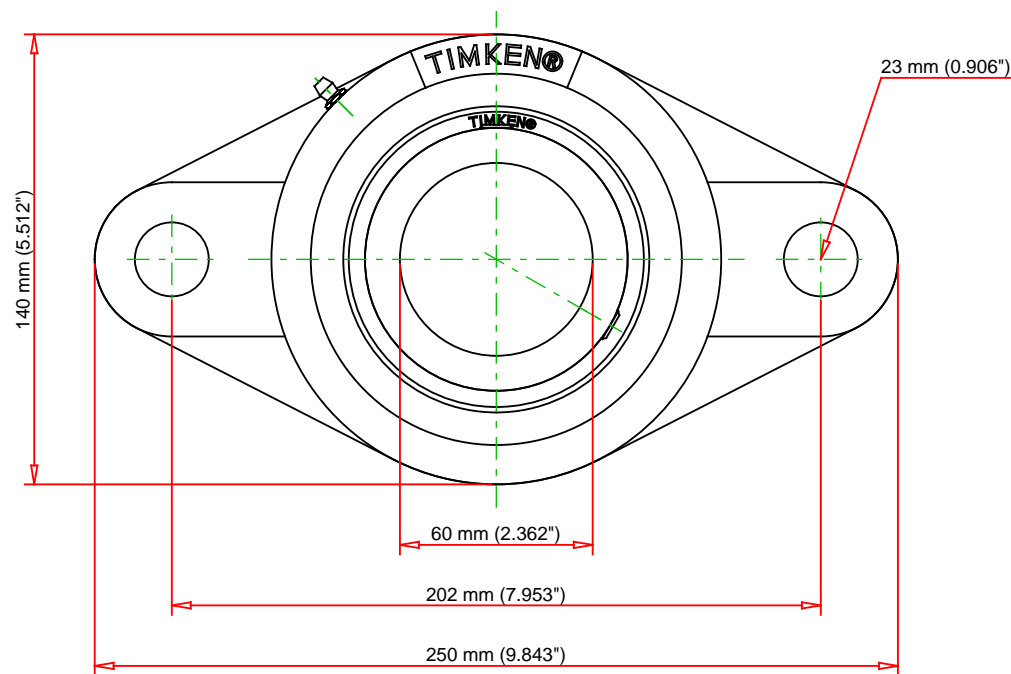
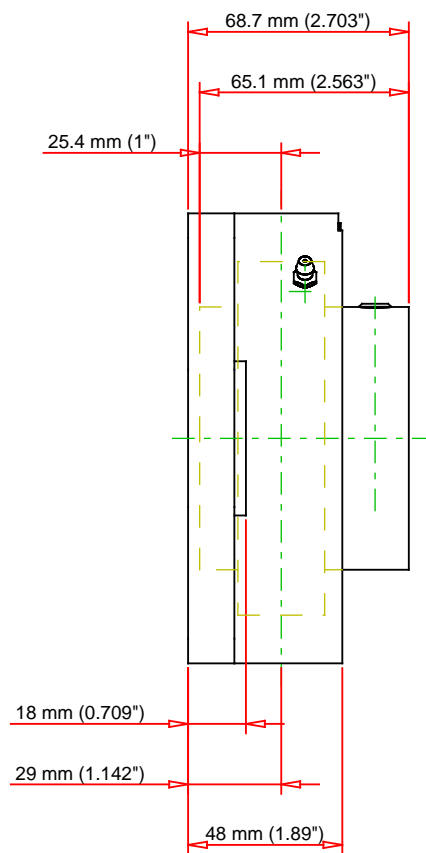

Bearing Number	UC212			
Load Ratings - C _r	11780	lbf	52400	N
Load Ratings - C _{0r}	8138	lbf	36200	N
Weight	9.3	lb	4.2	kg
Bolt Size	M20			

TIMKEN

THE TIMKEN COMPANY
NORTH CANTON, OHIO USA

UCFL212
UCFL 200 Two-Bolt Flanged Mounted
Bearings - Set Screw Locking

Every reasonable effort has been made to ensure the accuracy of the information contained in this writing, but no liability is accepted for errors, omissions or for any other reason.

FOR DISCUSSION ONLY