

Flame Resistant (Equivalent to UL-94 Standard V-0) FR One-touch Fittings Series *KR*

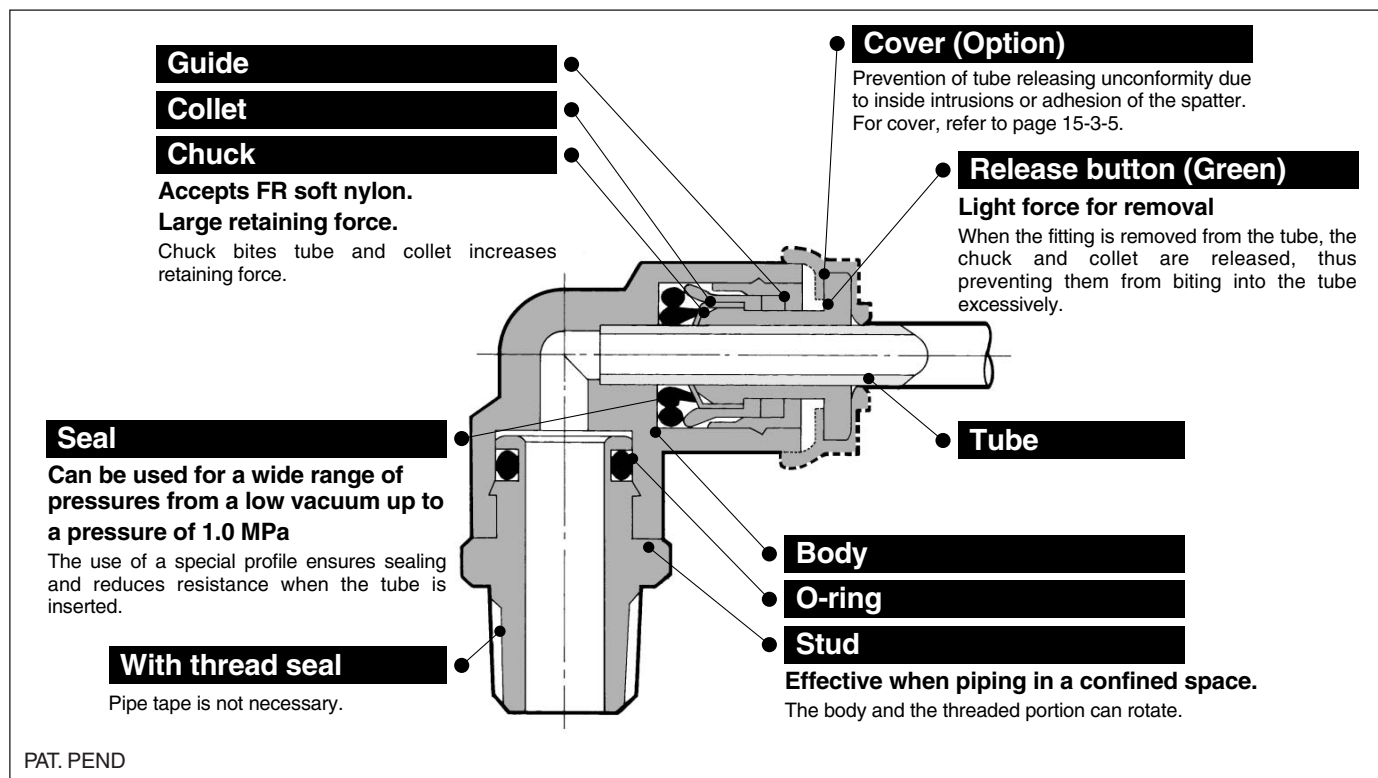

K□

M□

H□

D□

MS

T□

VMG



Applicable Tubing

Tubing material	FR double layer, FR soft nylon
Tubing O.D.	ø6, ø8, ø10, ø12

Specifications

Fluid	Air/Water ^{Note)}	
Maximum operating pressure	1.0 MPa	
Proof pressure	3.0 MPa	
Ambient and fluid temperature	-5 to 60°C (Water: 0 to 60°C) (No freezing)	
Thread	Mounting section	JIS B 0203 (Taper thread for piping)
	Nut section	JIS B 0211 Class 2 (Metric fine thread)
Seal (Thread portion)	With seal (Standard)	



Note) Applicable for general industrial water. Please consult with SMC if using for other kinds of fluid. Also, the surge pressure must be under the maximum operating pressure.

Principal Parts Material

Body	C3604BD, Flame resistant PBT (UL-94 standard V-0)
Stud	C3604BD (Thread portion)
Chuck	Stainless steel 304
Guide	Stainless steel 304, Flame resistant PBT (UL-94 standard V-0)
Collet	POM
Release button	Flame resistant PBT (UL-94 standard V-0)
Seal, O-ring	NBR
Cover (Option)	Flame resistant PBT, Flame resistant CR (UL-94 standard V-0)

Flame Resistant (Equivalent to UL-94 Standard V-0)

FR One-touch Fittings Series KR

Plug-in Reducer: KRR



Applicable tubing O.D. (mm)	Applicable fitting size ϕD	Model	ϕD (Note)	L	A	M	Effective area (mm ²)		Weight (g)
6	8	KRR06-08	12.8	37	18.5	17	10.4	5.6	2.5
	10	KRR06-10		39.5					9.3
8	10	KRR08-10	15.2	41	18.5	18.5	26.1	18.0	4.0
	12	KRR08-12		42					4.6
10	12	KRR10-12	18.5	44.5	23	21	41.5	32.8	33



Note) ϕD : Max. diameter

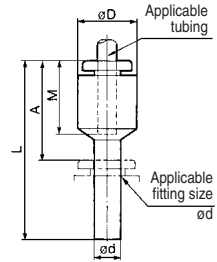

Bulkhead Union: KRE



Applicable tubing O.D. (mm)	Model	T (M)	H (width across flats)	L	Mounting hole	M	Effective area (mm ²)		Weight (g)
6	KRE06-00	M14 x 1	17	34.5	15	17	10.4	5.6	33
8	KRE08-00	M16 x 1	19	38	17	18.5	26.1	18.0	52
10	KRE10-00	M20 x 1	24	42.5	21	21	41.5	29.5	70
12	KRE12-00	M22 x 1	27	44	23	22	58.3	46.1	90

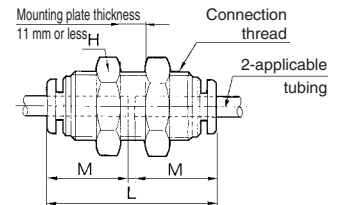

Plug: KRP



Applicable fitting size ϕD	Model	ϕD	L	A	Weight (g)
6	KRP-06	8	35	16	1
8	KRP-08	10	39	18.5	2
10	KRP-10	12	43	20	3.5
12	KRP-12	14	46	22	5

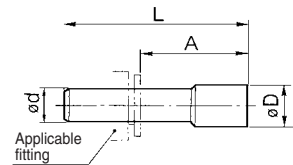

Spatter Cover 1: KR (Applicable tube: FR soft nylon)



Applicable fitting size	Model	ϕD	L	Weight (g)
6	KR-06C	15.5	9	0.9
8	KR-08C	17	9	1.0
10	KR-10C	20.8	10.5	1.5
12	KR-12C	22.8	10.5	1.6

* When tube insert parts are in line as KQU Union "Y", use KR-□□C1.

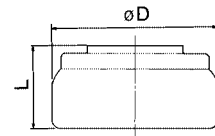

Spatter Cover 2: KR (Applicable tube: FR soft nylon, FR double layer)



Applicable fitting size	Model	L ₁	L ₂	ϕD
6	KR-06C1	18	13.7	12.8
8	KR-08C1	20	15.7	15
10	KR-10C1	22	17.2	18
12	KR-12C1	22	17.2	20

Installed

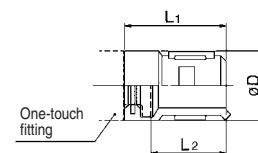

How to install

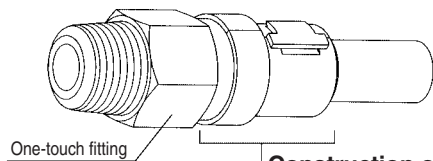

Construction of spatter cover

Install with matching
(A) and (B) parts.

