



IMAGE
COMING SOON



RCJT50-XL-N-FA125

Flanged housing unit

Schaeffler ID:
0096287110000

Housing units RCJT...FA125, two-bolt
flanged housing units, cast iron, eccentric
locking collar, R seals, with anti-corrosion
protection

X-life

Technical information

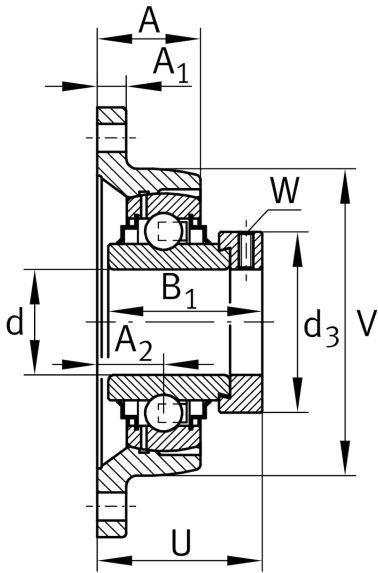
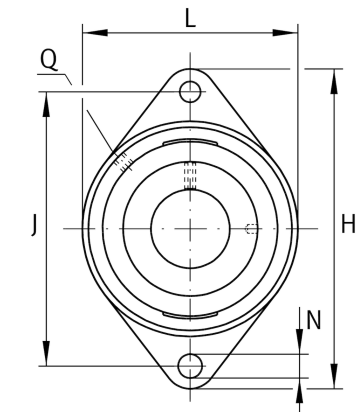

Main Dimensions & Performance Data

d	50 mm	Bore diameter
L	116 mm	Flange width
H	190 mm	Height flange
U	66.2 mm	Total height unit
C _r	37,500 N	Basic dynamic load rating, radial
C _{0r}	23,200 N	Basic static load rating, radial
C _{ur}	1,210 N	Fatigue load limit, radial
	2.2 kg	Weight

Mounting dimensions

J	157 mm	Distance fixing bore
N	18 mm	Fixing bore
n	2	Number of screwing holes

Dimensions

A	39 mm	Height housing
A ₁	13 mm	Thickness of flange
A ₂	28 mm	Distance raceway
V	116 mm	Shoulder diameter housing
Q	Rp1/8	Connection thread lubrication
d ₃	69 mm	Outside diameter eccentric locking collar

Additional information		
d	50 mm	Inner diameter bearing
d	50 mm	Inner diameter bearing
d	1.97 in	Inner diameter bearing
d	1 15/16 in	Inner diameter bearing
D	90 mm	Outer diameter bearing
D	90 mm	Outer diameter bearing
D	3.54 in	Outer diameter bearing
H	190 mm	Housing height
H	190 mm	Housing height
H	7.48 in	Housing height
L	116 mm	Housing length
L	116 mm	Housing length
L	4.57 in	Housing length
B	66.2 mm	Housing width
B	66.2 mm	Housing width
B	2.61 in	Housing width
h	95 mm	Height bearing seat
h	95 mm	Height bearing seat
h	3.74 in	Height bearing seat
m	157 mm	distance between mounting bolt centerlines (length)
m	157 mm	distance between mounting bolt centerlines (length)
m	6.18 in	distance between mounting bolt centerlines (length)
C _r	37,500 N	Basic dynamic load rating
C _r	8,430.76 lbf	Basic dynamic load rating
C _r	37,500 N	Basic dynamic load rating
C _{0r}	23,200 N	Basic static load rating
C _{0r}	5,215.83 lbf	Basic static load rating
C _{0r}	23,200 N	Basic static load rating
	RCJT50-XL-N-FA125-	Housing in kit
	I	

Additional information

1	Number of housings
CJT10	Housing
GE50-XL-KRR-B- FA125	Bearing designation
KASK10	Protecting cap

Temperature range

T _{min}	-20 °C	Operating temperature min.
T _{max}	120 °C	Operating temperature max.