



Vacuum Pad

2.5-Stage Bellows Type

ZP3P-JT Series

How to Order

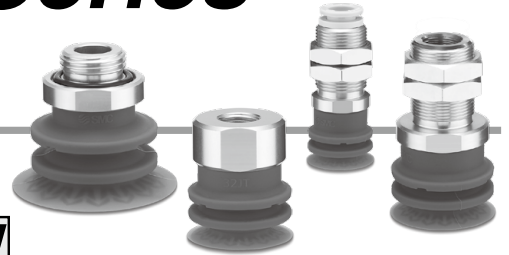

Pad unit

ZP3P – **20** **JT** **2** **SF** – **W**

With adapter

ZP3P **1** – **T** **20** **JT** **2** **SF** – **W** – **AG01** – **5**

● Bellows type
● 2.5-stage
● Silicone rubber

1 Adapter material

Nil	Aluminum
S	Stainless steel (Stainless steel 304)

2 Pad diameter

20	ø20
25	ø25
32	ø32
40	ø40
50	ø50

3 Attachment

W	With attachment
WM	With mesh attachment
WF	With flat attachment

With adapter

4 Connection thread/5 Vacuum inlet

4 Connection thread				5 Vacuum inlet			Pad diameter [mm]	
Type	Thread	Symbol	Size	Thread	Symbol	Size	ø20, ø25	ø32, ø40, ø50
Direct mounting	Male thread	AG01	G1/8	—	Nil	—*1	●	●
		AG02	G1/4				●	●
		AG03	G3/8				●	●
		AG04	G1/2				—	●
	Female thread	BG01	G1/8	—	Nil	—*1	●	—
		BG02	G1/4				—	●
Plate mounting	Male thread	A16	M16 x 1	Female thread	B01	Rc1/8	●	—
					BN01	NPT1/8		
				One-touch fitting*2	08	ø8		
		A20	M20 x 1	Female thread	B02	Rc1/4	—	●
					BN02	NPT1/4		
				One-touch fitting*2	10	ø10		

*1 Use the connection thread.

*2 Built-in One-touch fitting type

Pad, adapter assembly, and mounting nuts are included but do not come assembled.

Specifications

Operating temperature range		–30 to 90°C*1
Pad	Material	Silicone rubber*2, *3
	Color	Blue
	Hardness (Shore A: ±5°)	40
Attachment	Material	Synthetic resin*2, *4/Stainless steel*5
	Color	White
	Mesh	Mesh: 60/Opening: 280 μm

*1 –5 to 60 [°C] for the vacuum inlet with One-touch fitting

*2 Compliant with FDA (U.S. Food and Drug Administration) regulation 21CFR§177

*3 Compliant with the standards for “Rubber apparatus (excluding baby drinking apparatus) and containers/packaging” (D3) (Partial revision: Japanese Ministry of Health, Labour, and Welfare Notification No. 595, 2012) in Section 3 “Apparatus and Containers/Packaging” of the Japan Food Sanitation Act, Article 18 “Specifications and Standards for Food and Food Additives, etc.” (Japanese Ministry of Health and Welfare Notification No. 370, 1959)

*4 Compliant with the standards for “Synthetic resin apparatus and containers/packaging” (D2) in Section 3 “Apparatus and Containers/Packaging” of the Japan Food Sanitation Act, Article 18 “Specifications and Standards for Food and Food Additives, etc.” (Japanese Ministry of Health and Welfare Notification No. 370, 1959)

*5 Stainless steel included only for mesh attachment

Dimensions/Models

Pad unit

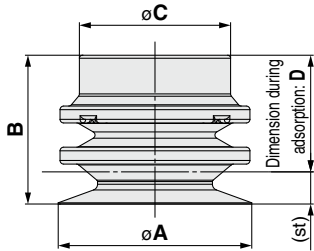

ZP3P - [20] JT2SF - [W]
① ②

Model						A	B	C	D	(st)*1	Weight [g]
① Pad dia.	Form	Number of bellows stages	Material	② Attachment							
ZP3P	20	JT	2	SF	W WM WF	20	17.7	16	15.2	2.5	2.8
	25					25	18.8		15.8	3	3.5
	32					32	24.6	25	20.6	4	8.3
	40					40	26.9		21.9	5	11
	50					50	28.7		22.2	6.5	13.8

*1 (st) indicates achieved vacuum pressure: Reference at -85 [kPa]

With adapter Direct mounting type (Male thread)

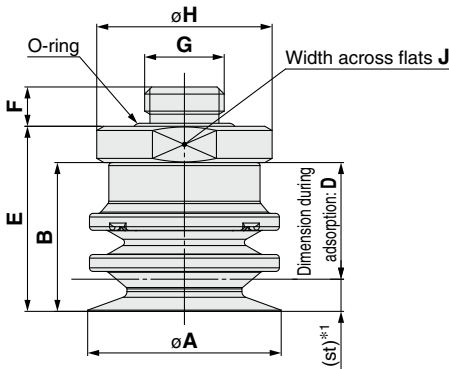

*1 Same dimension as the pad unit

ZP3P [] - T [20] JT2SF - [W] - [AG01]
① ② ③ ④

① Adapter material

Nil	Aluminum
S	Stainless steel (Stainless steel 304)

④ Connection thread (Male thread)

AG01	G1/8
AG02	G1/4
AG03	G3/8
AG04	G1/2

Model								E	F	G	H	J	Weight [g]		Min. opening hole size of the adapter				
① Adapter material	Vacuum inlet direction	② Pad dia.	Form	Number of bellows stages	Material	③ Attachment	④ Connection thread						Aluminum	Stainless steel					
ZP3P	Nil S	T	20				W WM WF	AG01	21.7	5.5	G1/8	18	17	6.5	13.8	ø5			
								AG02	22.7	6.5	G1/4	23	21	9.4	22.2	ø6.2			
								AG03	23.7	7.5	G3/8	29	27	15.9	41.6				
								AG01	22.8	5.5	G1/8	18	17	7.2	14.6	ø5			
								AG02	23.8	6.5	G1/4	23	21	10.3	23	ø6.2			
								AG03	24.8	7.5	G3/8	29	27	17.2	42.4				
			32							30.6		5.5	G1/8			21.9	48.9	ø5.7	
											AG02		6.5	G1/4	29	27	21.6	48	ø8
											AG03		7.5	G3/8			20.9	45.5	ø11.5
											AG04	31.6	9	G1/2	32	30	27.8	66.2	
											AG01		5.5	G1/8			24.6	51.6	
											AG02	32.9	6.5	G1/4	29	27	24.4	50.7	ø8
			40								AG03		7.5	G3/8			23.6	48.2	ø11.5
											AG04	33.9	9	G1/2	32	30	30.5	68.9	
											AG01		5.5	G1/8			27.4	54.4	ø5.7
											AG02	34.7	6.5	G1/4	29	27	27.1	53.5	ø8
											AG03		7.5	G3/8			26.4	51	ø11.5
											AG04	35.7	9	G1/2	32	30	33.3	71.7	

2.5-Stage Bellows Type

5.5-Stage Bellows Type

Construction

Mounting Bracket Assembly

Specific Product Precautions